

CATALOGUE

# EXPANDABLE CONTAINER HOUSES



Hengshui Jingtong Integrated Housing Co.,LTD



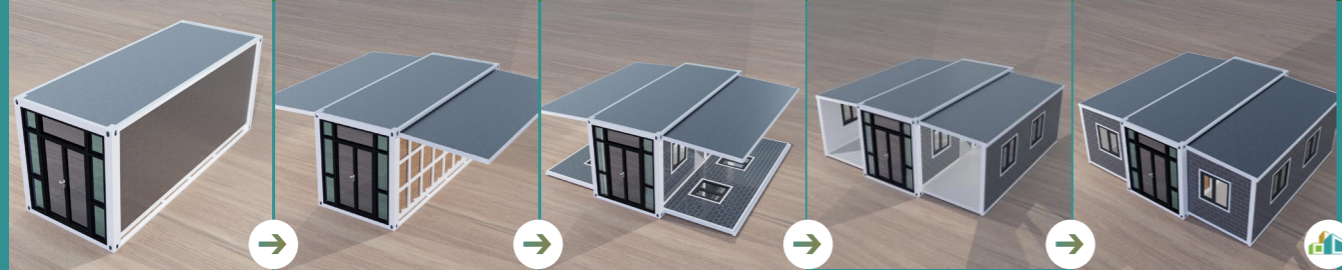

# EXPANDABLE CONTAINER HOUSE

Expandable container house is the most popular and widespread container house type, which is a modular, prefabricated home made from a shipping container. It features 1 to 3 spaces, which can provide larger and more comfortable spaces for living and working. Different size options satisfy your different space requirements. Flexible and customizable exterior and interior layout make it easy to create your ideal house within your budget. These houses are designed for quick setup and can be equipped with necessities like electricity, plumbing, and insulation. Ideal for temporary or permanent housing, they are durable, cost-effective, and can be used in remote locations. Expandable container houses also offer an eco-friendly housing solution, often incorporating recycled materials and options for sustainable technologies.

## Advantages

### Size and Expandability

20', 40', 10' and 30' options provides additional space when deployed, making it much larger than its transport configuration.

### Quick Setup

They can be deployed and made ready for use quickly, often in just a few minutes, thanks to their pre-fabricated design.

### Customization

Fully customization design, allowing buyers to select different layouts, finishes, and fittings to meet their specific needs.

### Comfortable

Well-insulated to ensure they are comfortable for living, even in extreme climates. HVAC systems are also commonly integrated.

### Eco-Friendly

Recycled materials minimize environmental impact. And energy saving system like solar panels, wind energy can be equipped.

### Cost-Effectiveness

Generally more affordable than traditional constructions, offering a good balance of cost and performance.

### Utilities

Integrated with essential utilities like electrical and plumbing systems, which are ready to connect at the deployment site.

### Durability

Made from steel structures, they are structurally sound and designed to withstand harsh weather conditions.

## Standard Container Houses



10'

10' Expandable Container House



20'

20' Expandable Container House



30'

30' Expandable Container House

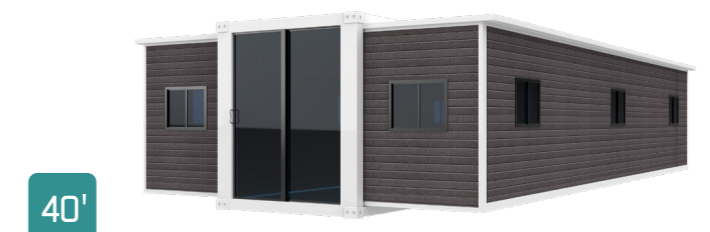

40'

40' Expandable Container House

## Standard Container Houses



Elevated Type

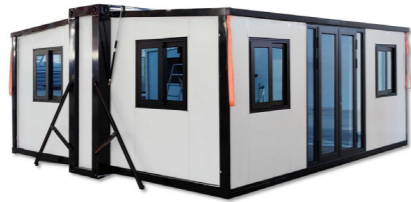

Compact Type



With Solar Panel and Wind Power Generation Equipment



Double Slope Roof



With Porch



Light and Customized Logo Type



All Glass Type



With Porch and Shelter



Flat Roof and Double Layered

## 10' Expandable Container House

**Expanded Size:** L2950 × W6300 × H2480 mm

**Internal Size:** L2510 × W6140 × H2240 mm

**Folding Size:** L2950 × W2200 × H2480 mm

**Floor Area:** 18.5 m<sup>2</sup>

**Layout:** 1 living room (default)

**Power Consumption:** 12 kW

**Total weight:** 1.6 ton

**Packing Quantity:** 4 set/40'H

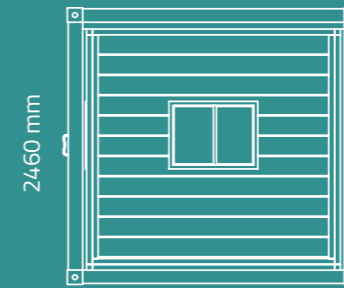

2510 mm  
Front Side View

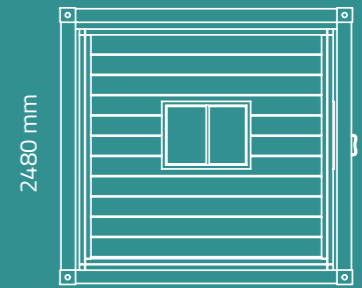

2510 mm  
Back Side View

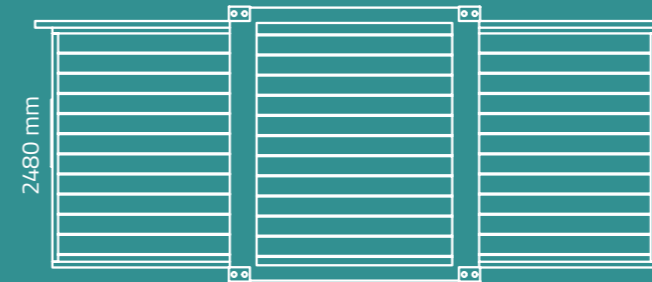

2480 mm  
2050 mm 2200 mm 2050 mm  
Left Side View

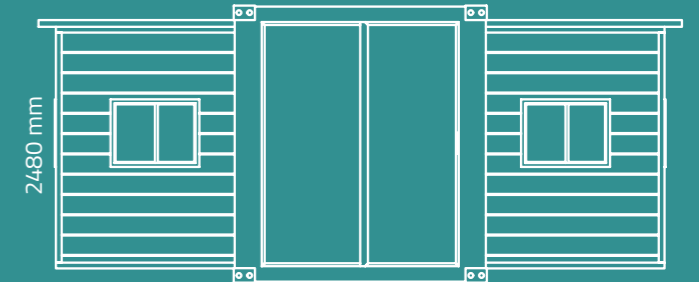

2480 mm  
2050 mm 2200 mm 2050 mm  
Right Side View



## 10' Expandable Container House Configuration



Name	Content	Specifications
Main Frame (Fully Galvanized)	Top Side Beam	80×100×2.5 mm square tube
	Top End Beam	Bending parts 2.0 mm
	Bottom Side Beam	80×100×2.5 mm square tube
	Bottom End Beam	Bending parts 2.0 mm
	Galvanized Lifting Lug	Galvanized hanging head 210×150×160 mm
	Steel Column	Bending parts 2.0 mm
Expandable Part Frame (Fully Galvanized)	Top Frame	40×80×1.5 mm P-shaped tube 40×80×1.5 mm Square tube
	Bottom Frame	60×80×2.0 mm Square tube
	Folding Hinge	130 mm Galvanized hinge
Overall Frame P rotective Coating	Spraying	Electrostatic Spraying / Direct Coating Powder + corrosion resistant coating
Roof Panel	External Roof Panel	t 50 mm EPS color steel sheet + 0.4 mm corrugated single sheet
	Internal Ceiling Panel	Model 200 Ceiling Panel
Wall Panel	Side Walls, Front And Back	t 65 mm EPS color steel sheet
	Internal Partition Panel	t 50 mm EPS color steel sheet
Floor	Main Floor	18 mm fireproof cement fiber floor
	Expandable Part	18 mm bamboo plywood
Doors and Windows	Steel Plastic Sliding Window	920×920 mm
	Steel Single Door	840×2030 mm
Electrical System	Circuit Breaker System	32A leakage protector × 1, Voltage 220 V, 50 Hz
	Lights	"Bull" 30×30 mm flat lamp, large ceiling lamp
	Sockets	Standard international three-hole and five-hole sockets (socket standards can be customized)
	Light Switches	Double/Single opening (switch standards can be customized)
	Wiring	Inlet wire 6 <sup>2</sup> , air conditioning socket 4 <sup>2</sup> , general socket 2.5 <sup>2</sup> , lighting 1.5 <sup>2</sup> . (Circuits can be customized)
Loading Quantity	4 sets/40'HQ	

## 20' Expandable Container House

**Expanded Size:** L5900 × W6300 × H2480 mm

**Internal Size:** L5460 × W6140 × H2240 mm

**Folding Size:** L5900 × W2200 × H2480 mm

**Floor Area:** 37 m<sup>2</sup>

**Layout:** 1 living room (default)

**Power Consumption:** 12 kW

**Total weight:** 2.8 ton

**Packing Quantity:** 2 set/40'H

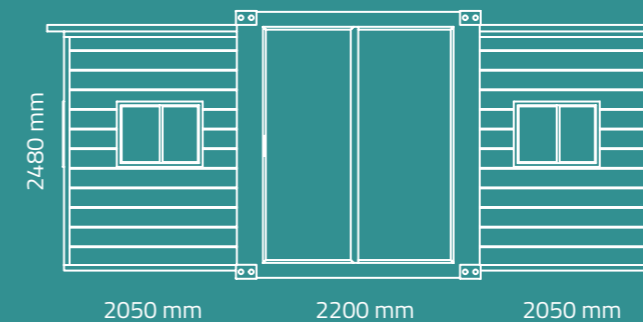

Front Side View

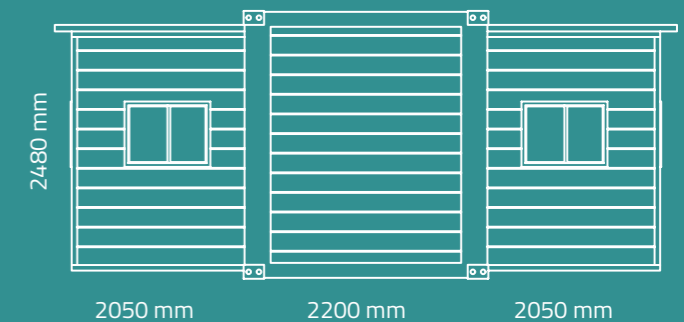

Back Side View

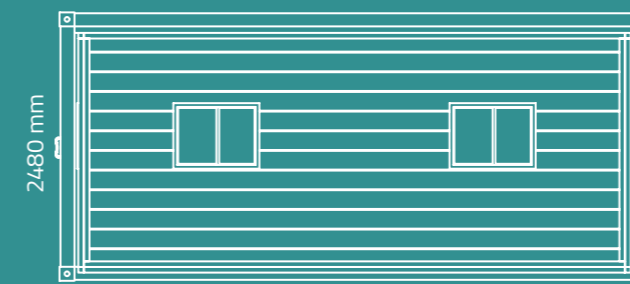

Left Side View

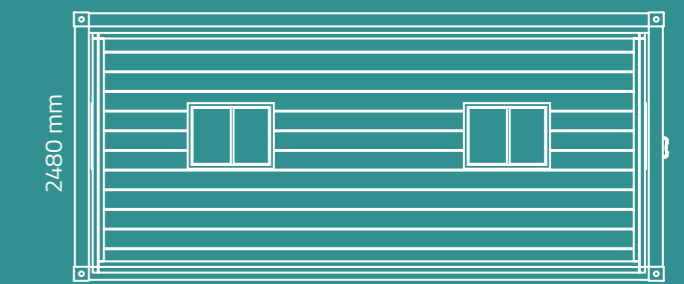

Right Side View

## 20' Expandable Container House Configuration



Name	Content	Specifications
Main Frame (Fully Galvanized)	Top Side Beam	80×100×2.5 mm square tube
	Top End Beam	Bending parts 2.0 mm
	Bottom Side Beam	80×100×2.5 mm square tube
	Bottom End Beam	Bending parts 2.0 mm
	Galvanized Lifting Lug	Galvanized hanging head 210×150×160 mm
Expandable Part Frame (Fully Galvanized)	Top Frame	40×80×1.5 mm P-shaped tube 40×80×1.5 mm Square tube
	Bottom Frame	60×80×2.0 mm Square tube
	Folding Hinge	130 mm Galvanized hinge
Overall Frame P rotective Coating	Spraying	Electrostatic Spraying / Direct Coating Powder + corrosion resistant coating
Roof Panel	External Roof Panel	t 50 mm EPS color steel sheet + 0.4 mm corrugated single sheet
	Internal Ceiling Panel	Model 200 Ceiling Panel
Wall Panel	Side Walls, Front And Back	t 65 mm EPS color steel sheet
	Internal Partition Panel	t 50 mm EPS color steel sheet
Floor	Main Floor	18 mm fireproof cement fiber floor
	Expandable Part	18 mm bamboo plywood
Doors and Windows	Steel Plastic Sliding Window	920×920 mm
	Steel Single Door	840×2030 mm
Electrical System	Circuit Breaker System	32A leakage protector × 1, Voltage 220 V, 50 Hz
	Lights	"Bull" 30×30 mm flat lamp, large ceiling lamp
	Sockets	Standard international three-hole and five-hole sockets (socket standards can be customized)
	Light Switches	Double/Single opening (switch standards can be customized)
Wiring	Inlet wire 6 <sup>2</sup> , air conditioning socket 4 <sup>2</sup> , general socket 2.5 <sup>2</sup> , lighting 1.5 <sup>2</sup> . (Circuits can be customized)	
Loading Quantity	2 sets/40'HQ	

## Layout

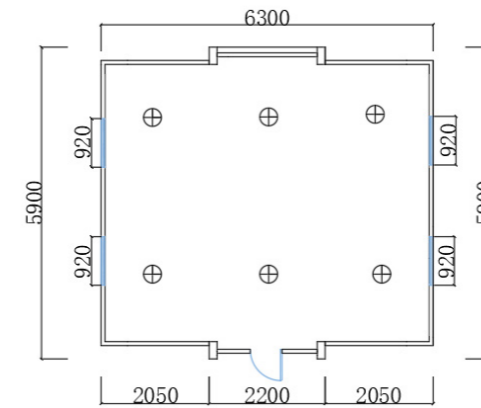

1 living room (default)

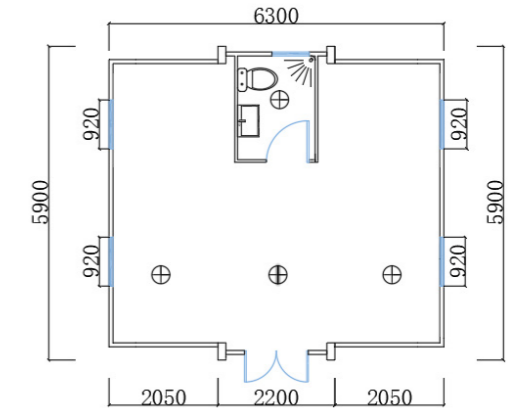

1 living room, 1 bathroom

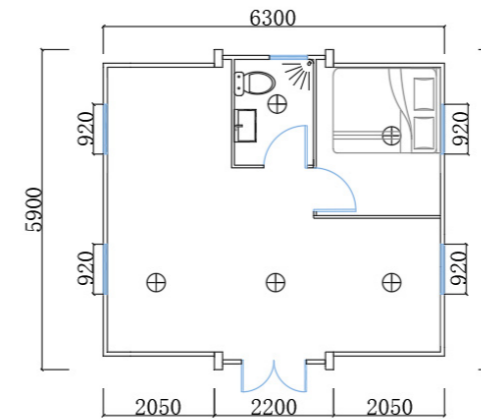

1 living room, 1 bathroom, 1 bedroom

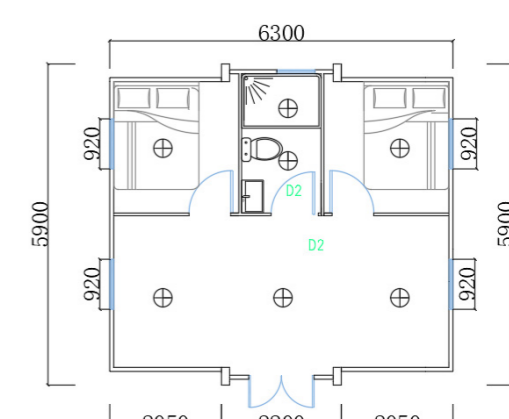

1 living room, 1 bathroom, 2 bedroom

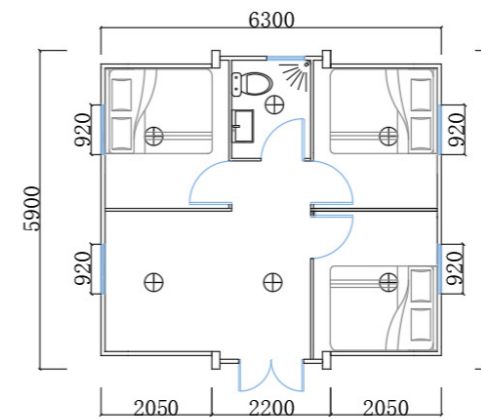

1 living room, 1 bathroom, 3 bedroom

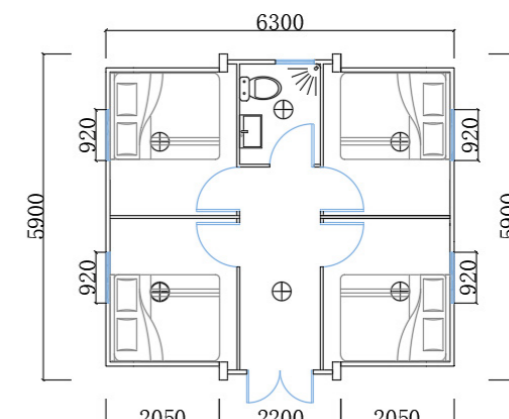

1 living room, 1 bathroom, 4 bedroom

# 30' Expandable Container House

**Expanded Size:** L9000 × W6220 × H2480 mm

**Internal Size:** L8540 × W6060 × H2240 mm

**Folding Size:** L9000 × W2200 × H2480 mm

**Floor Area:** 56 m<sup>2</sup>

**Layout:** 1 living room (default)

**Power Consumption:** 12 kW

**Total weight:** 3.75 ton

**Packing Quantity:** 1 set/40'H

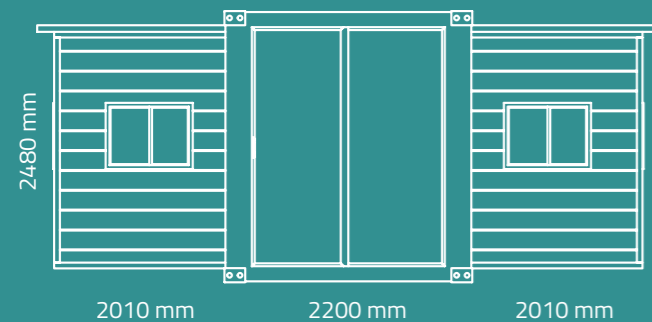

Front Side View

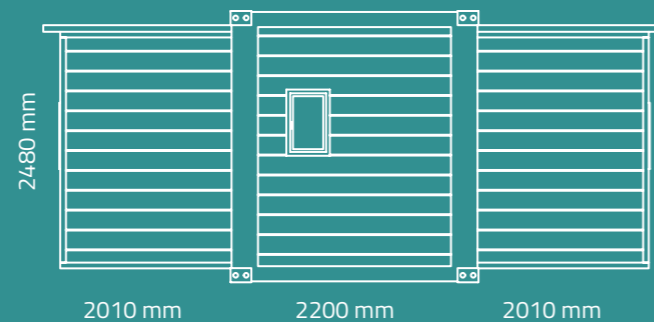

Back Side View

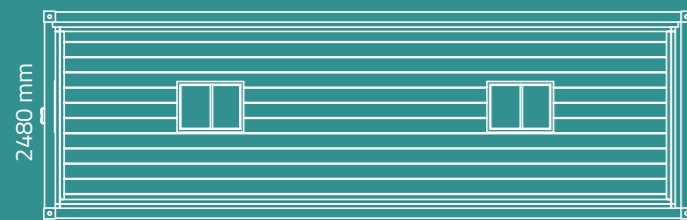

Left Side View

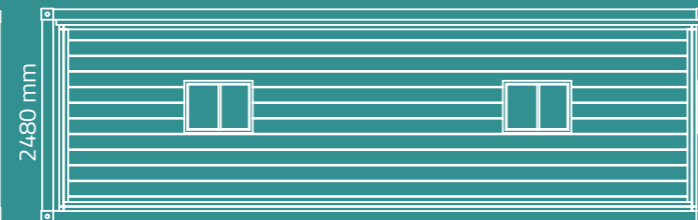

Right Side View

## 30' Expandable Container House Configuration



Name	Content	Specifications
Main Frame (Fully Galvanized)	Top Side Beam	80×100×3.0 mm square tube
	Top End Beam	Bending parts 2.5 mm
	Bottom Side Beam	80×100×3.0 mm square tube
	Bottom End Beam	Bending parts 2.5 mm
	Galvanized Lifting Lug	Galvanized hanging head 210×150×160 mm
Expandable Part Frame (Fully Galvanized)	Top Frame	40×80×1.5 mm P-shaped tube 40×80×1.5 mm Square tube
	Bottom Frame	60×80×2.0 mm Square tube
	Folding Hinge	130 mm Galvanized hinge
Overall Frame P protective Coating	Spraying	Electrostatic Spraying / Direct Coating Powder + corrosion resistant coating
Roof Panel	External Roof Panel	t 50 mm EPS color steel sheet + 0.4 mm corrugated single sheet
	Internal Ceiling Panel	Model 200 Ceiling Panel
Wall Panel	Side Walls, Front And Back	t 65 mm EPS color steel sheet
	Internal Partition Panel	t 50 mm EPS color steel sheet
Floor	Main Floor	18 mm fireproof cement fiber floor
	Expandable Part	18 mm bamboo plywood
Doors and Windows	Steel Plastic Sliding Window	920×920 mm
	Steel Single Door	840×2030 mm
Electrical System	Circuit Breaker System	32A leakage protector × 1, Voltage 220 V, 50 Hz
	Lights	"Bull" 30×30 mm flat lamp, large ceiling lamp
	Sockets	Standard international three-hole and five-hole sockets (socket standards can be customized)
	Light Switches	Double/Single opening (switch standards can be customized)
Wiring	Inlet wire 6 <sup>2</sup> , air conditioning socket 4 <sup>2</sup> , general socket 2.5 <sup>2</sup> , lighting 1.5 <sup>2</sup> . (Circuits can be customized)	
Loading Quantity	1 set/40'HQ	

# 40' Expandable Container House

**Expanded Size:** L11800 × W6220 × H2480 mm

**Internal Size:** L11540 × W6060 × H2240 mm

**Folding Size:** L11800 × W2200 × H2480 mm

**Floor Area:** 72 m<sup>2</sup>

**Layout:** 1 living room (default)

**Power Consumption:** 12 kW

**Total weight:** 5.3 ton

**Packing Quantity:** 1 set/40'H

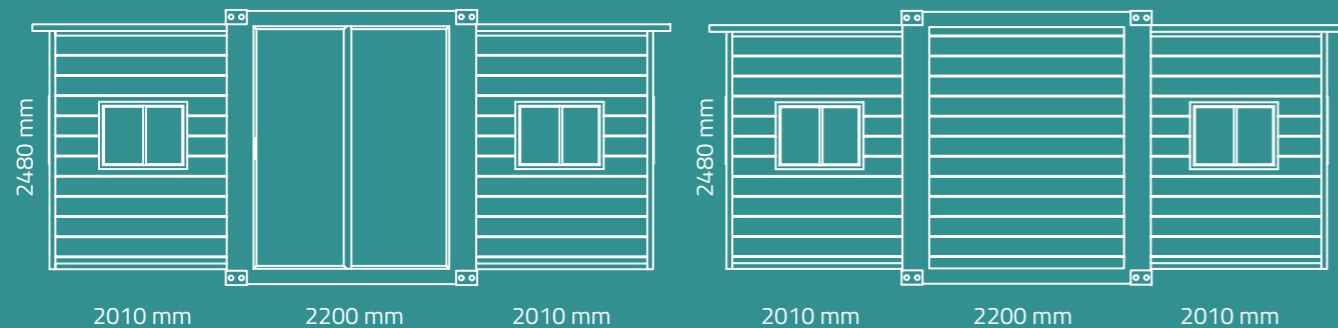

Front Side View

Back Side View

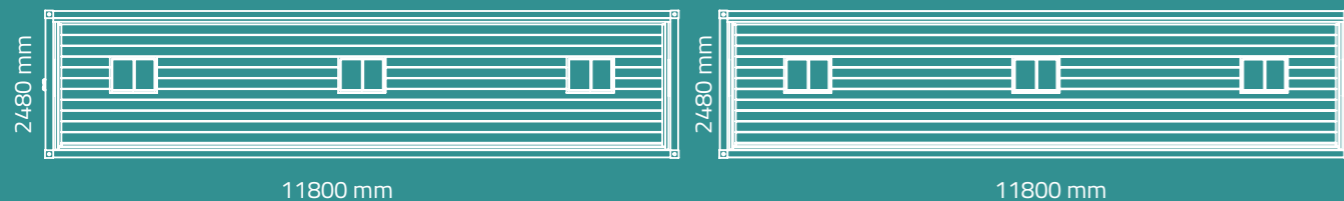

Left Side View

Right Side View

## 40' Expandable Container House Configuration



Standard 40 Feet Expandable Container House Configuration

Name	Content	Specifications
Main Frame (Fully Galvanized)	Top Side Beam	80×100×3.0 mm square tube
	Top End Beam	Bending parts 2.5 mm
	Bottom Side Beam	80×100×3.0 mm square tube
	Bottom End Beam	Bending parts 2.5 mm
	Galvanized Lifting Lug	Galvanized hanging head 210×150×160 mm
Expandable Part Frame (Fully Galvanized)	Top Frame	40×80×1.5 mm P-shaped tube 40×80×1.5 mm Square tube
	Bottom Frame	60×80×2.0 mm Square tube
	Folding Hinge	130 mm Galvanized hinge
Overall Frame P protective Coating	Spraying	Electrostatic Spraying / Direct Coating Powder + corrosion resistant coating
Roof Panel	External Roof Panel	t 50 mm EPS color steel sheet + 0.4 mm corrugated single sheet
	Internal Ceiling Panel	Model 200 Ceiling Panel
Wall Panel	Side Walls, Front And Back	t 65 mm EPS color steel sheet
	Internal Partition Panel	t 50 mm EPS color steel sheet
Floor	Main Floor	18 mm fireproof cement fiber floor
	Expandable Part	18 mm bamboo plywood
Doors and Windows	Steel Plastic Sliding Window	920×920 mm
	Steel Single Door	840×2030 mm
Electrical System	Circuit Breaker System	32A leakage protector × 1, Voltage 220 V, 50 Hz
	Lights	"Bull" 30×30 mm flat lamp, large ceiling lamp
	Sockets	Standard international three-hole and five-hole sockets (socket standards can be customized)
	Light Switches	Double/Single opening (switch standards can be customized)
Wiring	Inlet wire 6 <sup>2</sup> , air conditioning socket 4 <sup>2</sup> , general socket 2.5 <sup>2</sup> , lighting 1.5 <sup>2</sup> . (Circuits can be customized)	
Loading Quantity	1 set/40'HQ	



# Layout

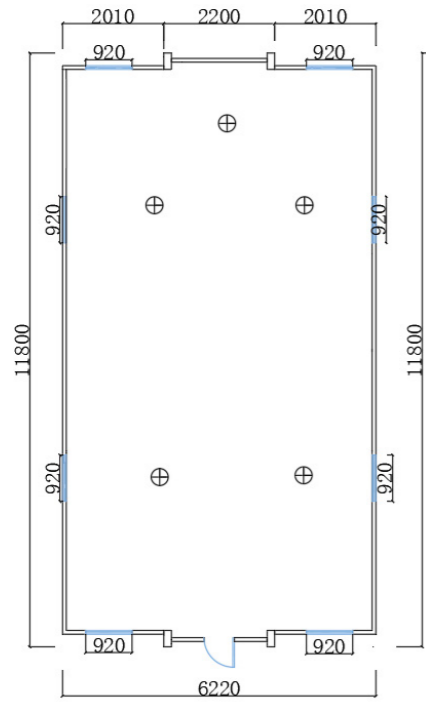

1 living room (default)

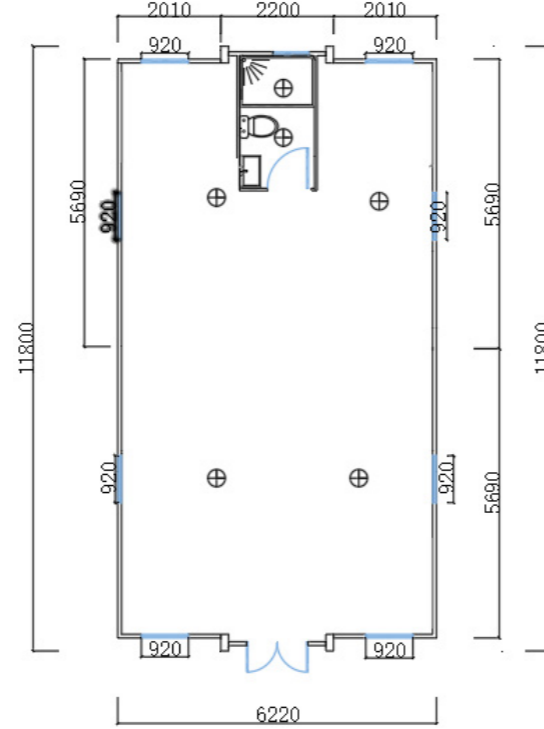

1 living room, 1 bathroom

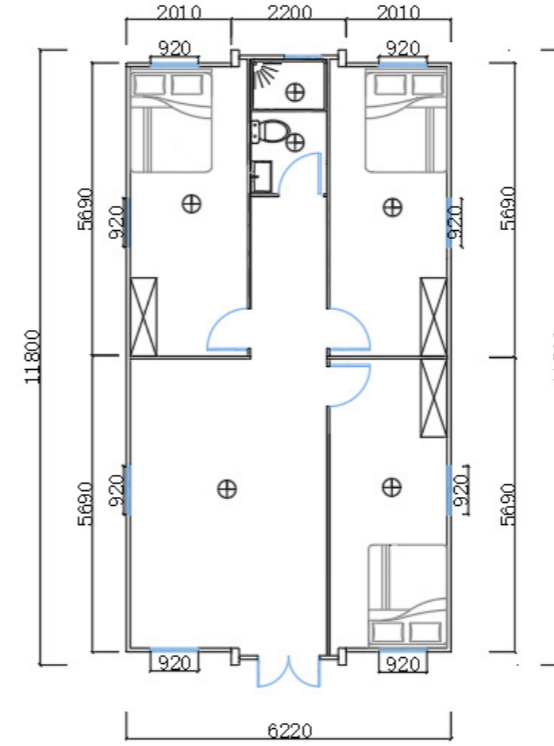

1 living room, 1 bathroom, 3 bedroom

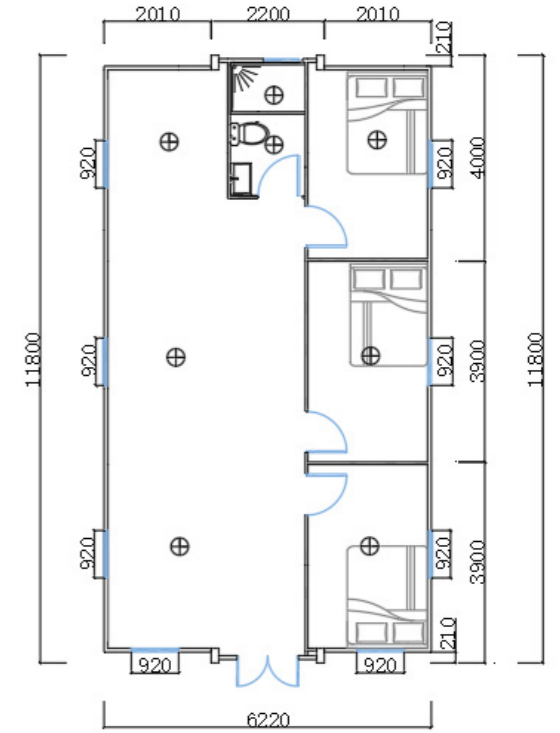

1 living room, 1 bathroom, 3 bedroom

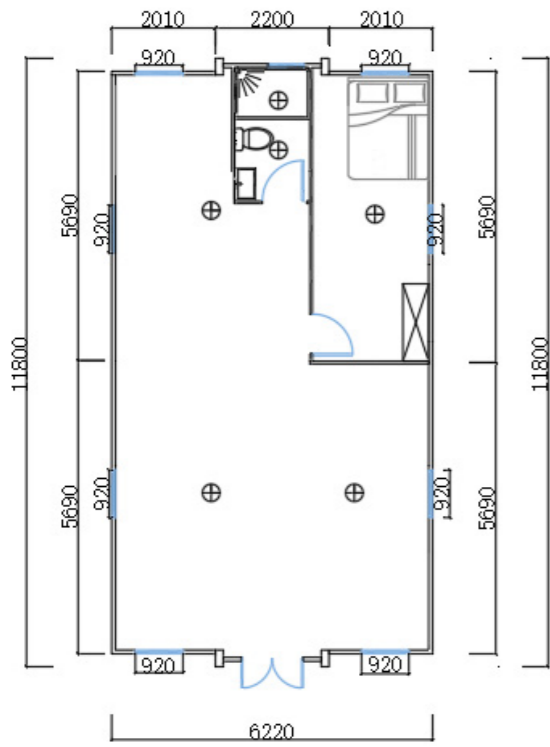

1 living room, 1 bathroom, 1 bedroom

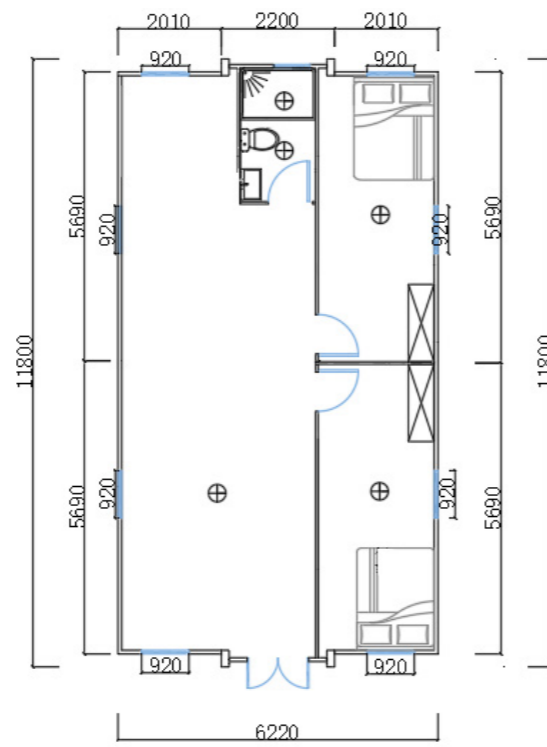

1 living room, 1 bathroom, 2 bedroom

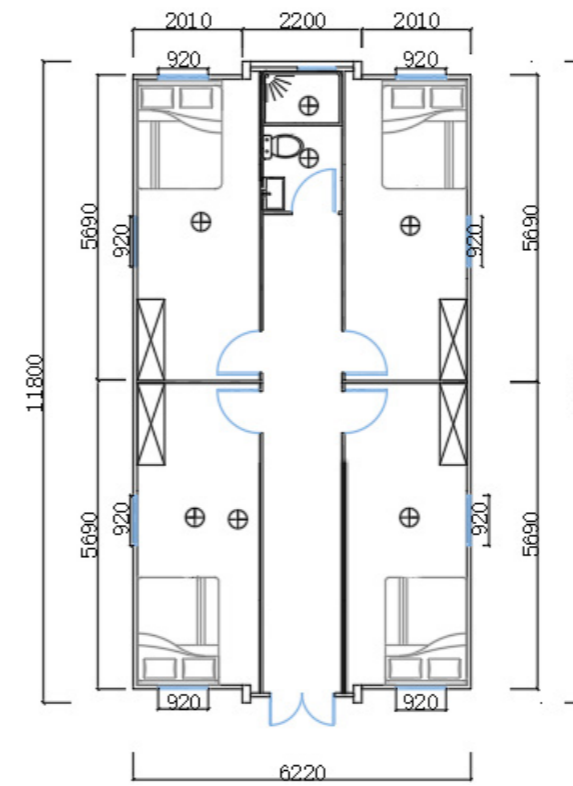

1 living room, 1 bathroom, 4 bedroom

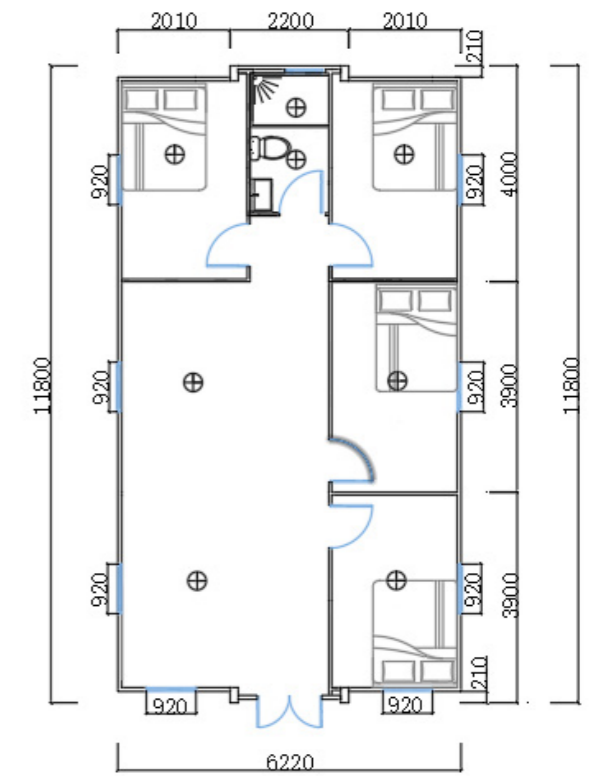

1 living room, 1 bathroom, 4 bedroom



# CUSTOMIZE

## Your Expandable Container House

We offer full customization options, allowing you to personalize every aspect of your container house, including layout, appearance, doors, windows, flooring, and interior fittings.



### Container Size

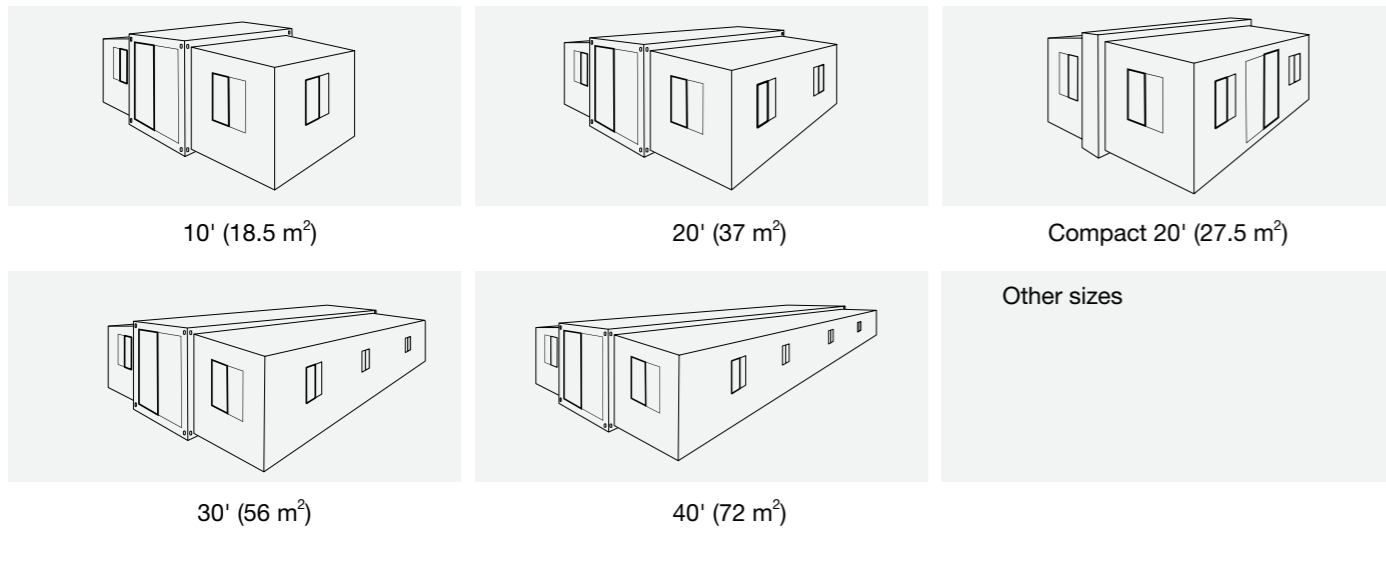

### Frame Color



### Wall Panel Color

#### Pure Color

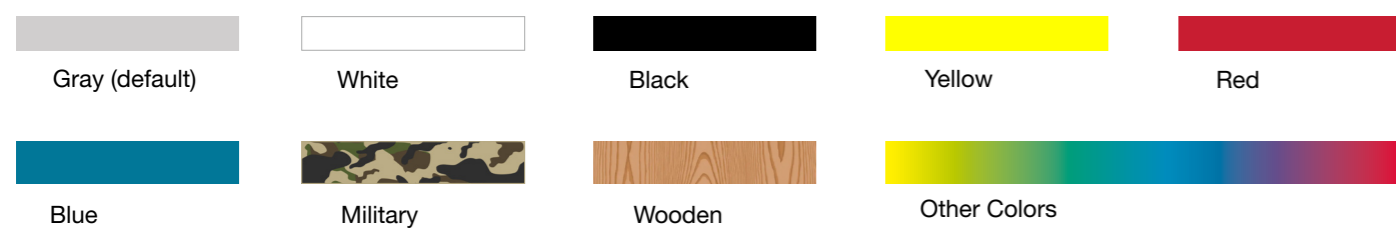

### Metal carved panels

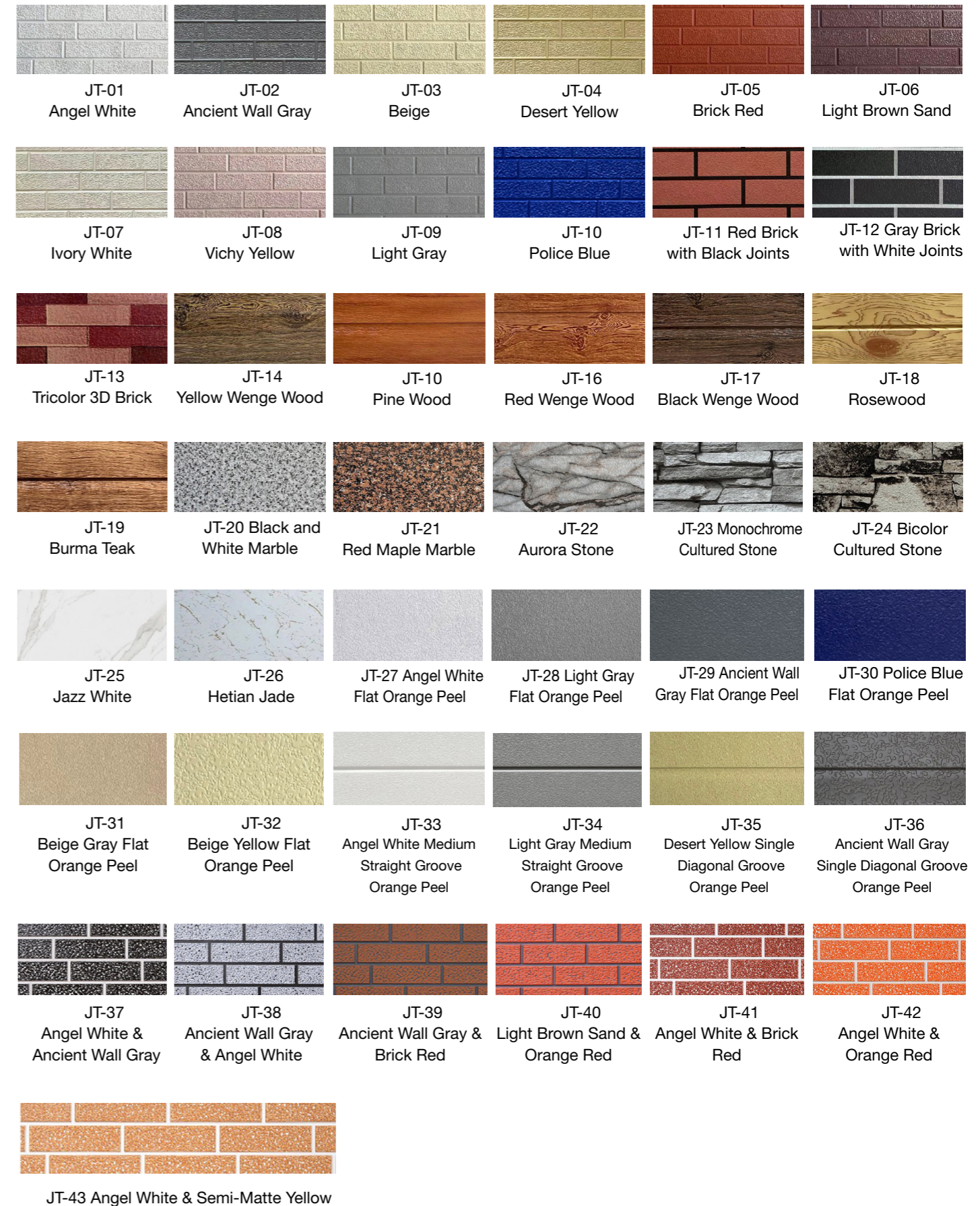



## Layout



1 living room



1 bedroom and 1 living room



2 bedroom and 1 living room



3 bedroom and 1 living room



4 bedroom and 1 living room

Others

## Specific Design

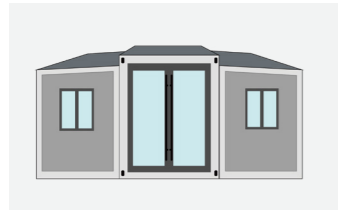

Elevated type

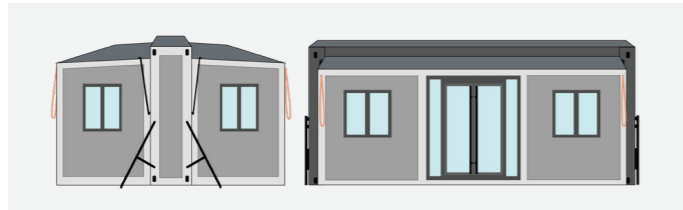

Compact type



With patio



Patio + shelter

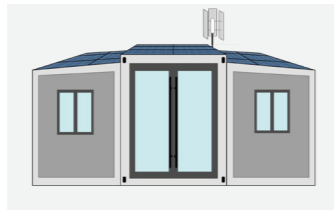

Solar panel + wind generator

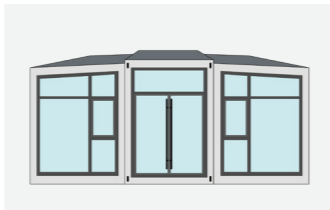

All glass



Double slope roof

Other requirements

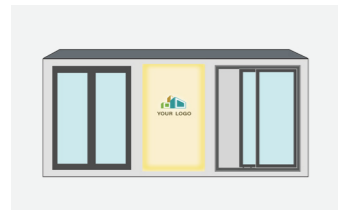

Customized logo + LED strip light



Two-story

## Entry Door

### Door Material



Steel fireproof door

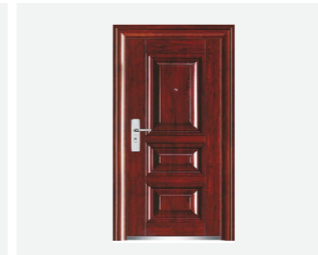

Aluminum alloy door



Thermal break door

Others

### Door Type



Single inswing

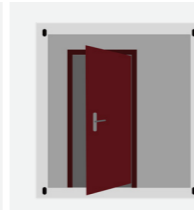

Single outswing  
- steel

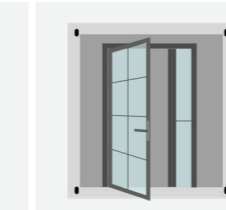

Single outswing  
- thermal break

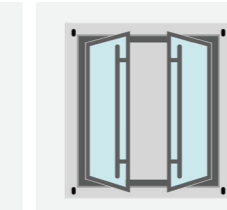

Double outswing

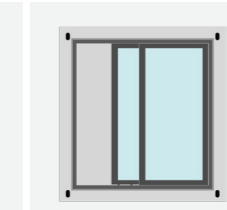

Sliding door

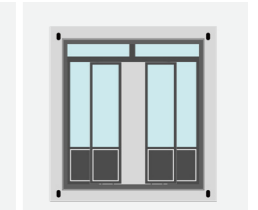

Double sliding

Others

## Window

### Window Material



Aluminum alloy jalousie

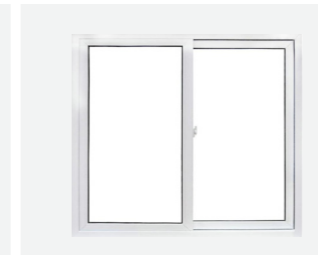

Plastic steel



Thermal break

Others

### Window Type

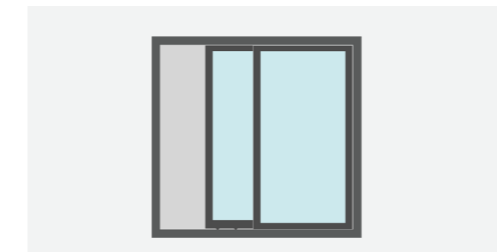

Sliding

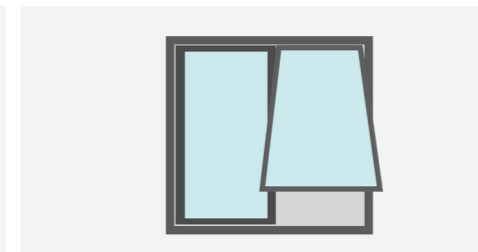

Awning

Others

## Floor



Fireproof cement fiber  
for main structure



Bamboo plywood floor  
for expandable part

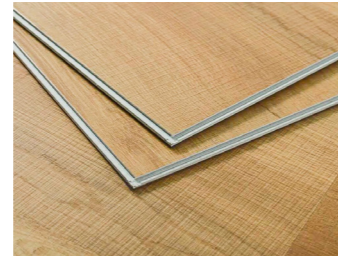

SPC floor



Vinyl flooring

Others

## Kitchen

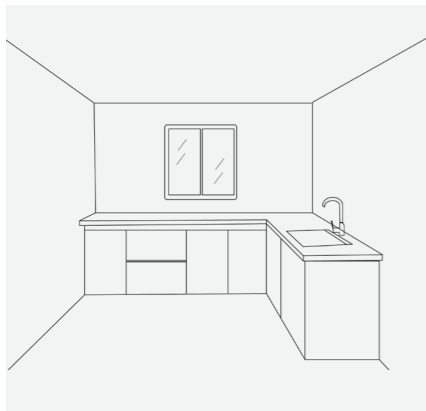

L shape cabinet



L shape cabinet & wall cabinet



L shape cabinet & wall cabinet  
with fridge position

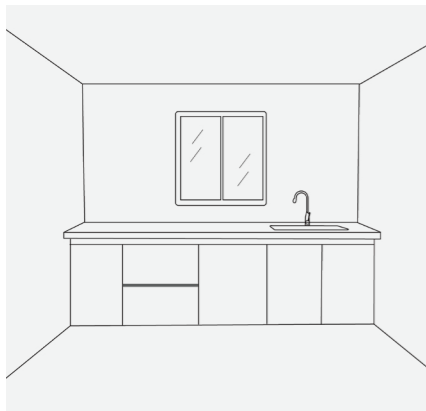

I shape cabinet

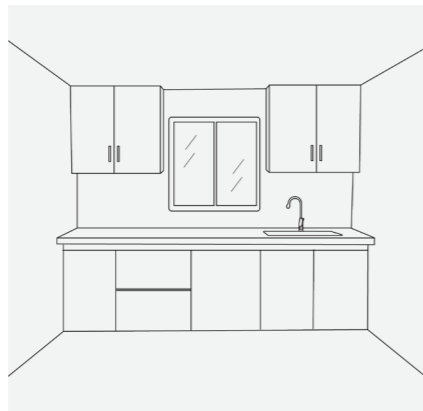

I shape cabinet & wall cabinet

No need

Other requirements

## Bedroom Door



Fire-proof steel door



Wooden door

Others

## Bathroom

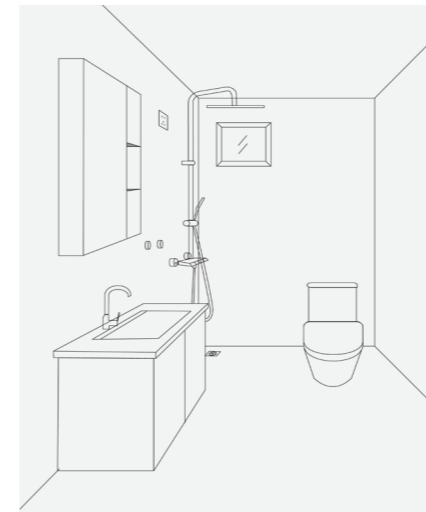

### Private bathroom

Including partitions, showerhead,  
washbasin, toilet, mirror, cabinet,  
titanium-magnesium alloy door,  
floor drain, and plumbing.

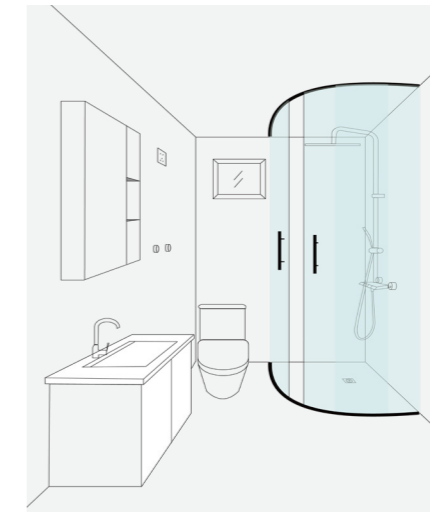

### Private bathroom + semi-circular shower room

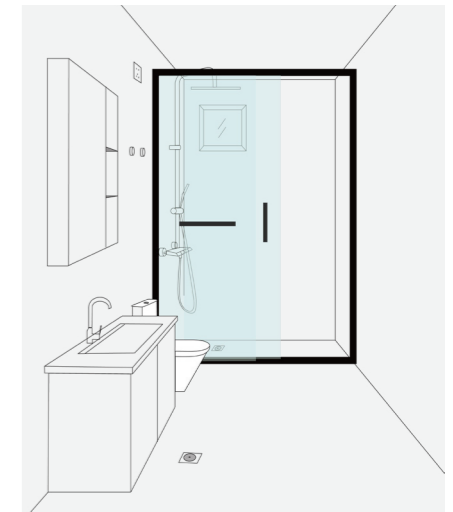

### Wet and dry separation bathroom

Including partitions, showerhead,  
washbasin, toilet, mirror, cabinet,  
titanium-magnesium alloy door,  
floor drain, and plumbing.

Others

## Other Requirements



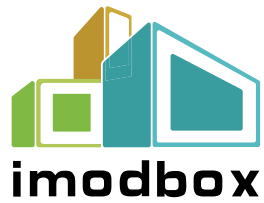

## **Hengshui Jingtong Integrated Housing Co.,LTD**

Address: Room 1202, Block #A, Huizhong Plaza, No.285 Renmin East Road, Taocheng District, Hengshui City, Hebei Province.

Mobile: +86-15297601111

E-mail: [tian@imodbox.com](mailto:tian@imodbox.com)

WhatsApp: +86-18830819992

WeChat: +86-18830819992

Website: [www.imodbox.com](http://www.imodbox.com)