

# CATALOGUE

---

## PREFAB CONTAINER HOUSES

Hengshui Jingtong Integrated Housing Co.,LTD

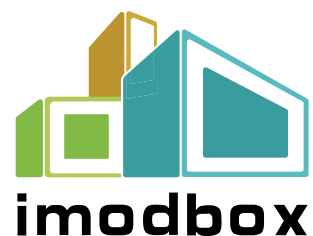

# Contents

**04 Company Profile**  
Professional factory owns years of experience for customer-oriented solutions

**06 Expandable Container Houses**  
Different sizes and layouts satisfy various space requirements

**26 Folding Container Houses**  
The fastest container type for rapid move-in

**30 Flat Pack Container House**  
The most economical solution to construction sites dormitories

**34 Apple Cabin**  
The ultimate experience of sunshine and comfort for both home and commercials

**38 Capsule House**  
Whole-house intelligence for versatile applications and environments

**44 Creative Containers**  
More colors, designs and configuration for your extraordinary project

**46 Applications & Projects**  
Container houses play important roles in residences, commercial and industries



**06**  
**Expandable Container Houses**



**26**  
**Folding Container Houses**



**30**  
**Flat Pack Container House**



**34**  
**Apple Cabin**



**38**  
**Capsule House**



**44**  
**Creative Containers**



# Company Profiles

Hengshui Jingtong Integrated Housing Co.,LTD is a professional manufacturer that excels in design, production, sales, and after-sales service. We are committed to meeting the unique needs of each customer by providing innovative, high-quality, sustainable, and cost-effective housing solutions to clients worldwide.

## 1 One Stop

Free Design & One-Stop Purchase

## 13+ Years Export

Experiences with ISO and CE Certificates

## 16 -Hours Online

Services, Best Quotations Sent within 1 Hour

## 100% -Satisfaction

Wholeheartedly serve customers for 100 satisfaction

- 13+ Experience**  
 Decades of dedicated research and experience have forged extraordinary product quality for your durable use.
- Factory Discount**  
 Chat with our factory directly and get more beneficial for your home or projects.
- Free Design**  
 Our team of expert designers will work with you to develop a plan that meets your specific needs and preferences.
- Full Customization**  
 We offer full customization options, allowing you to personalize every aspect of your container house.
- Quick Delivery**  
 Efficient production ensures quick delivery. We aim to minimize waiting and move-in times as soon as possible
- Strong Support**  
 Our commitment to customer satisfaction continues beyond the sale. Strong support to ensure a seamless experience

### Mission

To revolutionize the housing industry by providing high-quality, customizable, and sustainable prefabricated container houses that meet the diverse needs of our customers worldwide.

### Vision

To be a global leader in the prefabricated housing industry, renowned for our innovative designs, exceptional craftsmanship, and commitment to sustainability.

### Innovation, Solution And Cooperation

The vision and mission are our direction forward, and the values are our guidelines. They make our corporate better and more durable.

# Workshop & Showroom Display



Aerial photography



Materials



Semi-finished products



Floor frame welding



Wall panel assemble



Expandable container house waiting for loading

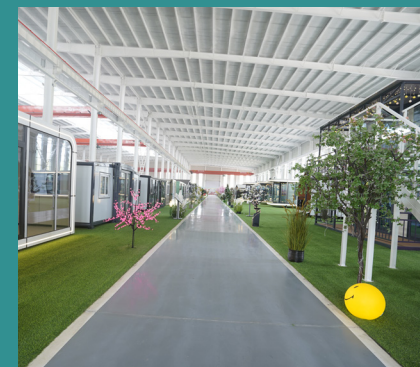

Showroom



Showroom – apple cabin



Showroom – capsule house



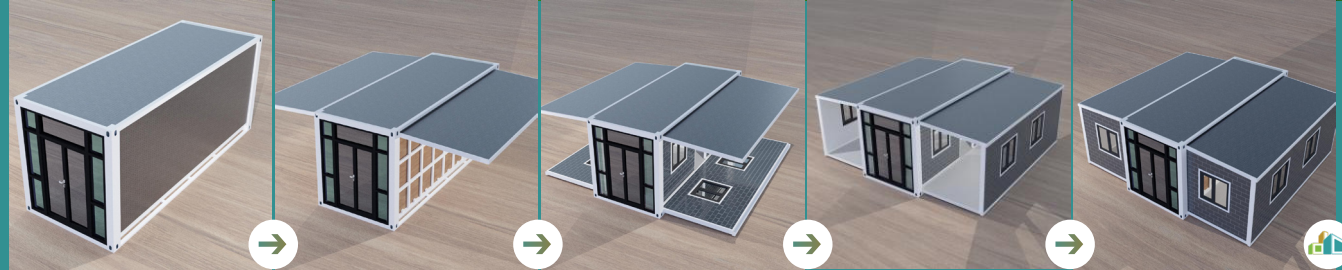

# EXPANDABLE CONTAINER HOUSE

Expandable container house is the most popular and widespread container house type, which is a modular, prefabricated home made from a shipping container. It features 1 to 3 spaces, which can provide larger and more comfortable spaces for living and working. Different size options satisfy your different space requirements. Flexible and customizable exterior and interior layout make it easy to create your ideal house within your budget. These houses are designed for quick setup and can be equipped with necessities like electricity, plumbing, and insulation. Ideal for temporary or permanent housing, they are durable, cost-effective, and can be used in remote locations. Expandable container houses also offer an eco-friendly housing solution, often incorporating recycled materials and options for sustainable technologies.

## Advantages

### Size and Expandability

20', 40', 10' and 30' options provides additional space when deployed, making it much larger than its transport configuration.

### Quick Setup

They can be deployed and made ready for use quickly, often in just a few minutes, thanks to their pre-fabricated design.

### Customization

Fully customization design, allowing buyers to select different layouts, finishes, and fittings to meet their specific needs.

### Comfortable

Well-insulated to ensure they are comfortable for living, even in extreme climates. HVAC systems are also commonly integrated.

### Eco-Friendly

Recycled materials minimize environmental impact. And energy saving system like solar panels, wind energy can be equipped.

### Cost-Effectiveness

Generally more affordable than traditional constructions, offering a good balance of cost and performance.

### Utilities

Integrated with essential utilities like electrical and plumbing systems, which are ready to connect at the deployment site.

### Durability

Made from steel structures, they are structurally sound and designed to withstand harsh weather conditions.

## Standard Container Houses



10'

10' Expandable Container House



20'

20' Expandable Container House



30'

30' Expandable Container House



40'

40' Expandable Container House



## Standard Container Houses



Elevated Type

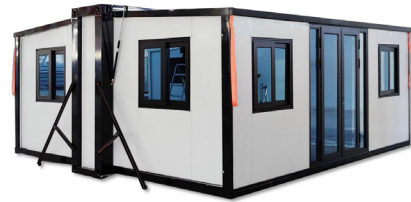

Compact Type



With Solar Panel and Wind Power Generation Equipment



Double Slope Roof



With Porch



Light and Customized Logo Type



All Glass Type



With Porch and Shelter



Flat Roof and Double Layered

## 10' Expandable Container House

**Expanded Size:** L2950 × W6300 × H2480 mm

**Internal Size:** L2510 × W6140 × H2240 mm

**Folding Size:** L2950 × W2200 × H2480 mm

**Floor Area:** 18.5 m<sup>2</sup>

**Layout:** 1 living room (default)

**Power Consumption:** 12 kW

**Total weight:** 1.6 ton

**Packing Quantity:** 4 set/40'H

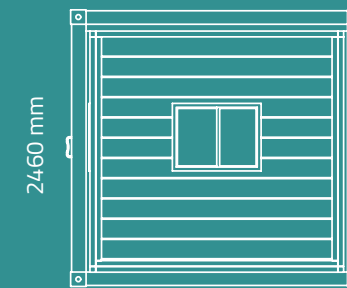

2510 mm  
Front Side View

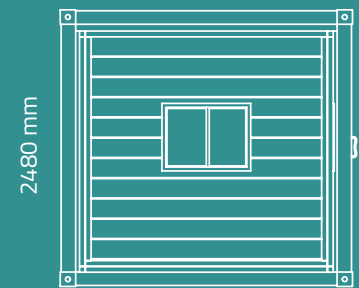

2510 mm  
Back Side View

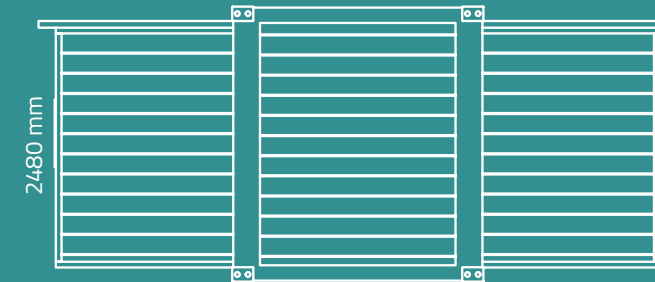

Left Side View

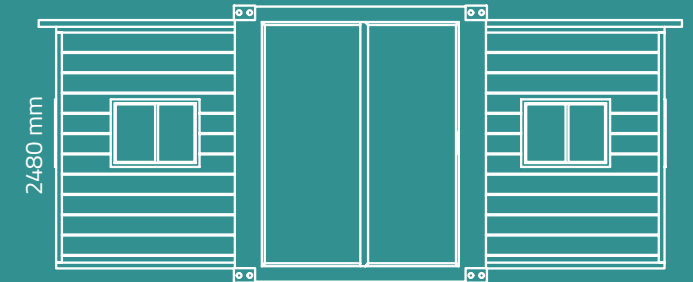

Right Side View

## 10' Expandable Container House Configuration



Name	Content	Specifications
Main Frame (Fully Galvanized)	Top Side Beam	80×100×2.5 mm square tube
	Top End Beam	Bending parts 2.0 mm
	Bottom Side Beam	80×100×2.5 mm square tube
	Bottom End Beam	Bending parts 2.0 mm
	Galvanized Lifting Lug	Galvanized hanging head 210×150×160 mm
	Steel Column	Bending parts 2.0 mm
Expandable Part Frame (Fully Galvanized)	Top Frame	40×80×1.5 mm P-shaped tube 40×80×1.5 mm Square tube
	Bottom Frame	60×80×2.0 mm Square tube
	Folding Hinge	130 mm Galvanized hinge
Overall Frame P rotective Coating	Spraying	Electrostatic Spraying / Direct Coating Powder + corrosion resistant coating
Roof Panel	External Roof Panel	t 50 mm EPS color steel sheet + 0.4 mm corrugated single sheet
	Internal Ceiling Panel	Model 200 Ceiling Panel
Wall Panel	Side Walls, Front And Back	t 65 mm EPS color steel sheet
	Internal Partition Panel	t 50 mm EPS color steel sheet
Floor	Main Floor	18 mm fireproof cement fiber floor
	Expandable Part	18 mm bamboo plywood
Doors and Windows	Steel Plastic Sliding Window	920×920 mm
	Steel Single Door	840×2030 mm
Electrical System	Circuit Breaker System	32A leakage protector × 1, Voltage 220 V, 50 Hz
	Lights	"Bull" 30×30 mm flat lamp, large ceiling lamp
	Sockets	Standard international three-hole and five-hole sockets (socket standards can be customized)
	Light Switches	Double/Single opening (switch standards can be customized)
	Wiring	Inlet wire 6 <sup>2</sup> , air conditioning socket 4 <sup>2</sup> , general socket 2.5 <sup>2</sup> , lighting 1.5 <sup>2</sup> . (Circuits can be customized)
Loading Quantity	4 sets/40'HQ	

## 20' Expandable Container House

**Expanded Size:** L5900 × W6300 × H2480 mm

**Internal Size:** L5460 × W6140 × H2240 mm

**Folding Size:** L5900 × W2200 × H2480 mm

**Floor Area:** 37 m<sup>2</sup>

**Layout:** 1 living room (default)

**Power Consumption:** 12 kW

**Total weight:** 2.8 ton

**Packing Quantity:** 2 set/40'H

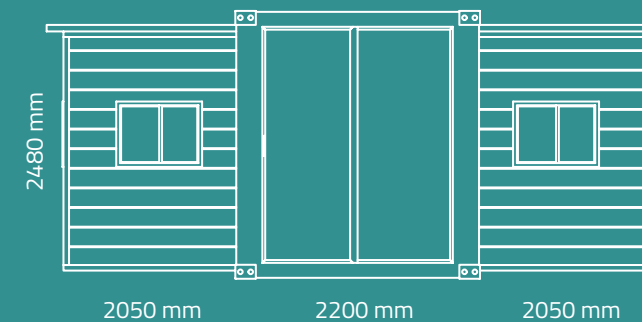

Front Side View

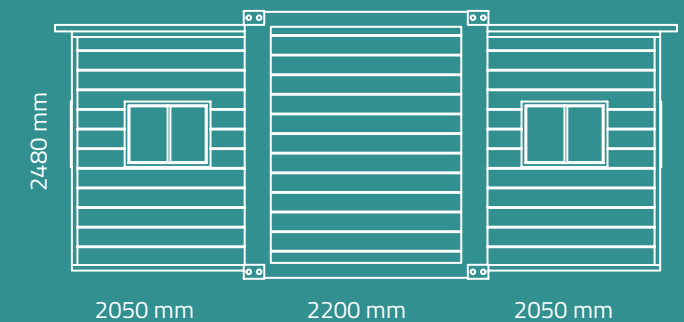

Back Side View

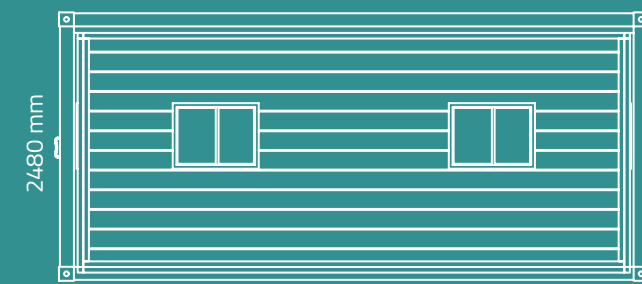

Left Side View

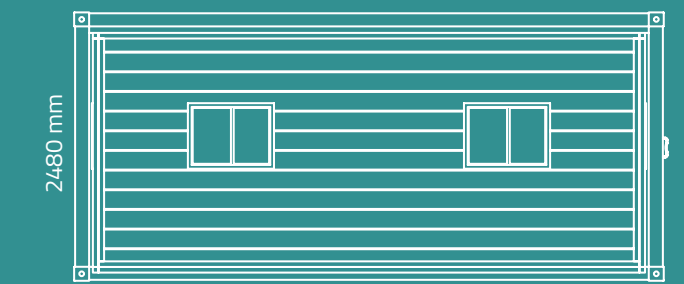

Right Side View



## 20' Expandable Container House Configuration



Name	Content	Specifications
Main Frame (Fully Galvanized)	Top Side Beam	80×100×2.5 mm square tube
	Top End Beam	Bending parts 2.0 mm
	Bottom Side Beam	80×100×2.5 mm square tube
	Bottom End Beam	Bending parts 2.0 mm
	Galvanized Lifting Lug	Galvanized hanging head 210×150×160 mm
Expandable Part Frame (Fully Galvanized)	Top Frame	40×80×1.5 mm P-shaped tube 40×80×1.5 mm Square tube
	Bottom Frame	60×80×2.0 mm Square tube
	Folding Hinge	130 mm Galvanized hinge
Overall Frame P rotective Coating	Spraying	Electrostatic Spraying / Direct Coating Powder + corrosion resistant coating
Roof Panel	External Roof Panel	t 50 mm EPS color steel sheet + 0.4 mm corrugated single sheet
	Internal Ceiling Panel	Model 200 Ceiling Panel
Wall Panel	Side Walls, Front And Back	t 65 mm EPS color steel sheet
	Internal Partition Panel	t 50 mm EPS color steel sheet
Floor	Main Floor	18 mm fireproof cement fiber floor
	Expandable Part	18 mm bamboo plywood
Doors and Windows	Steel Plastic Sliding Window	920×920 mm
	Steel Single Door	840×2030 mm
Electrical System	Circuit Breaker System	32A leakage protector × 1, Voltage 220 V, 50 Hz
	Lights	"Bull" 30×30 mm flat lamp, large ceiling lamp
	Sockets	Standard international three-hole and five-hole sockets (socket standards can be customized)
	Light Switches	Double/Single opening (switch standards can be customized)
Wiring	Inlet wire 6 <sup>2</sup> , air conditioning socket 4 <sup>2</sup> , general socket 2.5 <sup>2</sup> , lighting 1.5 <sup>2</sup> . (Circuits can be customized)	
Loading Quantity	2 sets/40'HQ	

## Layout

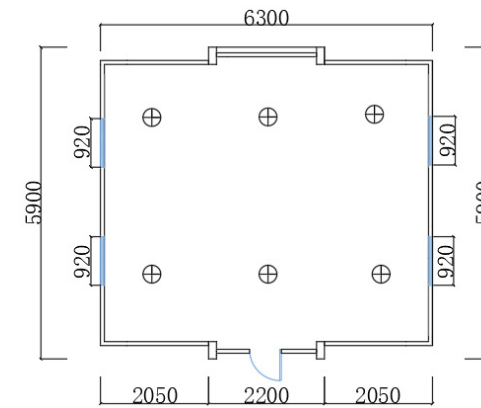

1 living room (default)

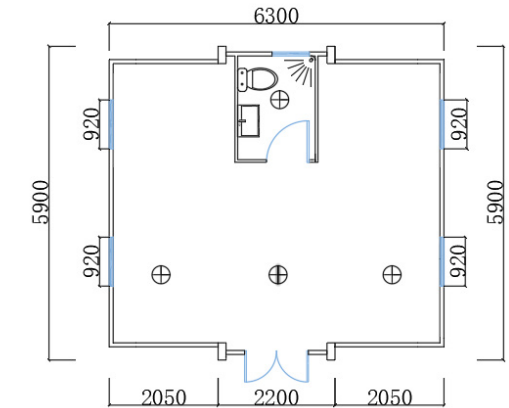

1 living room, 1 bathroom

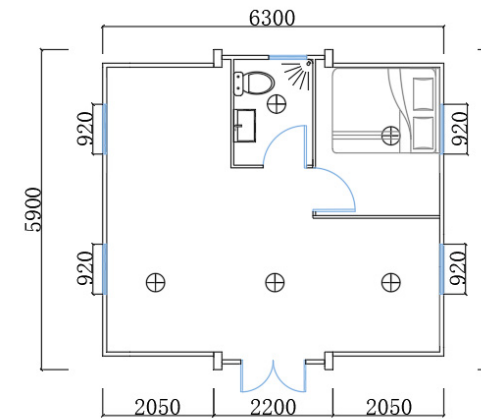

1 living room, 1 bathroom, 1 bedroom

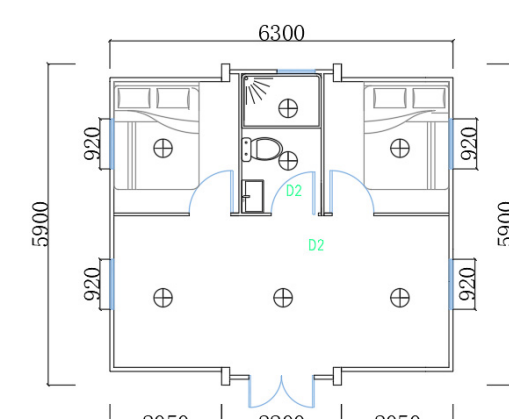

1 living room, 1 bathroom, 2 bedroom

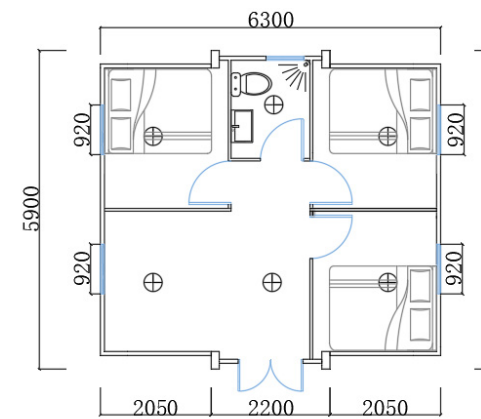

1 living room, 1 bathroom, 3 bedroom

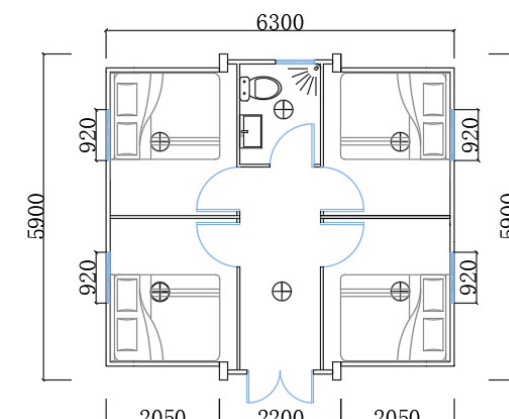

1 living room, 1 bathroom, 4 bedroom

# 30' Expandable Container House

**Expanded Size:** L9000 × W6220 × H2480 mm

**Internal Size:** L8540 × W6060 × H2240 mm

**Folding Size:** L9000 × W2200 × H2480 mm

**Floor Area:** 56 m<sup>2</sup>

**Layout:** 1 living room (default)

**Power Consumption:** 12 kW

**Total weight:** 3.75 ton

**Packing Quantity:** 1 set/40'H

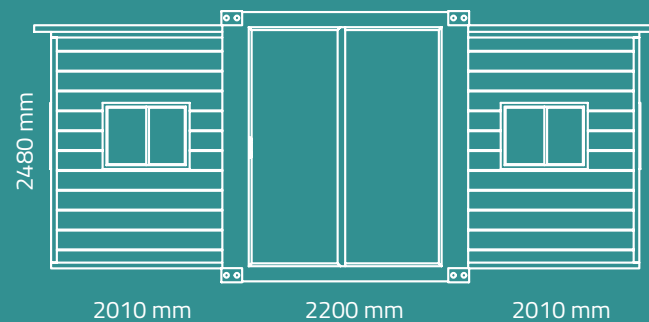

Front Side View

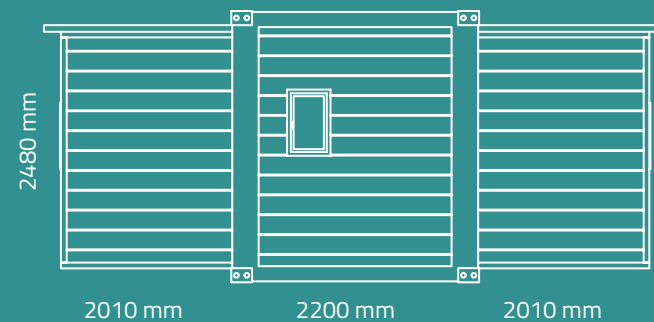

Back Side View

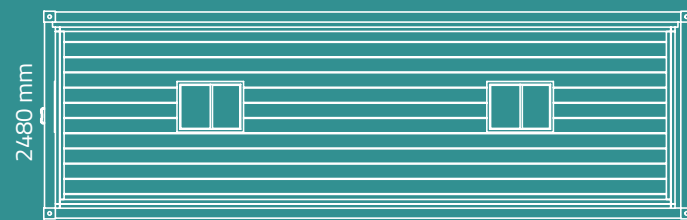

Left Side View

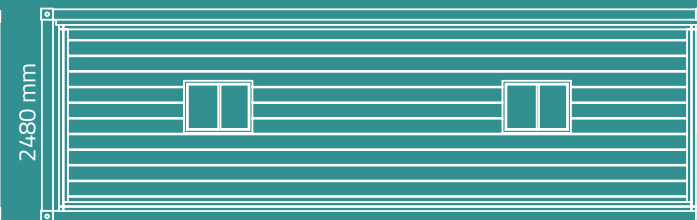

Right Side View

## 30' Expandable Container House Configuration



Name	Content	Specifications
Main Frame (Fully Galvanized)	Top Side Beam	80×100×3.0 mm square tube
	Top End Beam	Bending parts 2.5 mm
	Bottom Side Beam	80×100×3.0 mm square tube
	Bottom End Beam	Bending parts 2.5 mm
	Galvanized Lifting Lug	Galvanized hanging head 210×150×160 mm
Expandable Part Frame (Fully Galvanized)	Top Frame	40×80×1.5 mm P-shaped tube 40×80×1.5 mm Square tube
	Bottom Frame	60×80×2.0 mm Square tube
	Folding Hinge	130 mm Galvanized hinge
Overall Frame P protective Coating	Spraying	Electrostatic Spraying / Direct Coating Powder + corrosion resistant coating
Roof Panel	External Roof Panel	t 50 mm EPS color steel sheet + 0.4 mm corrugated single sheet
	Internal Ceiling Panel	Model 200 Ceiling Panel
Wall Panel	Side Walls, Front And Back	t 65 mm EPS color steel sheet
	Internal Partition Panel	t 50 mm EPS color steel sheet
Floor	Main Floor	18 mm fireproof cement fiber floor
	Expandable Part	18 mm bamboo plywood
Doors and Windows	Steel Plastic Sliding Window	920×920 mm
	Steel Single Door	840×2030 mm
Electrical System	Circuit Breaker System	32A leakage protector × 1, Voltage 220 V, 50 Hz
	Lights	"Bull" 30×30 mm flat lamp, large ceiling lamp
	Sockets	Standard international three-hole and five-hole sockets (socket standards can be customized)
	Light Switches	Double/Single opening (switch standards can be customized)
	Wiring	Inlet wire 6 <sup>2</sup> , air conditioning socket 4 <sup>2</sup> , general socket 2.5 <sup>2</sup> , lighting 1.5 <sup>2</sup> . (Circuits can be customized)
Loading Quantity	1 set/40'HQ	



# 40' Expandable Container House

**Expanded Size:** L11800 × W6220 × H2480 mm

**Internal Size:** L11540 × W6060 × H2240 mm

**Folding Size:** L11800 × W2200 × H2480 mm

**Floor Area:** 72 m<sup>2</sup>

**Layout:** 1 living room (default)

**Power Consumption:** 12 kW

**Total weight:** 5.3 ton

**Packing Quantity:** 1 set/40'H

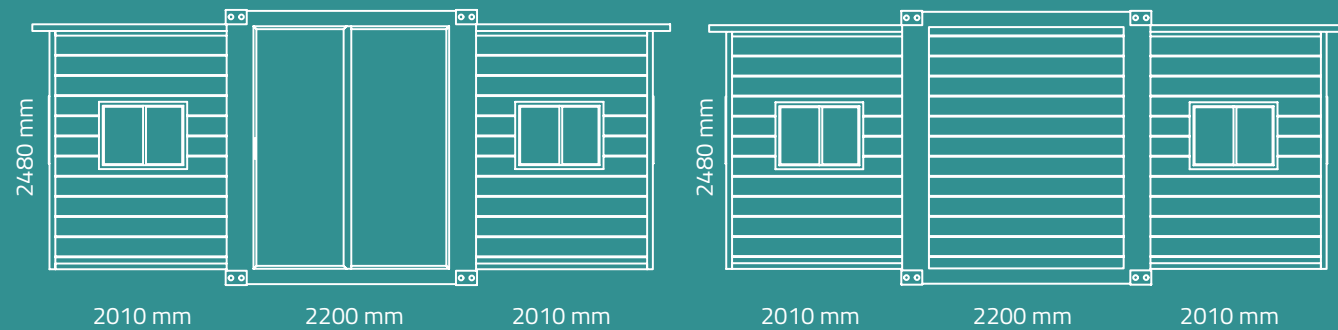

Front Side View

Back Side View

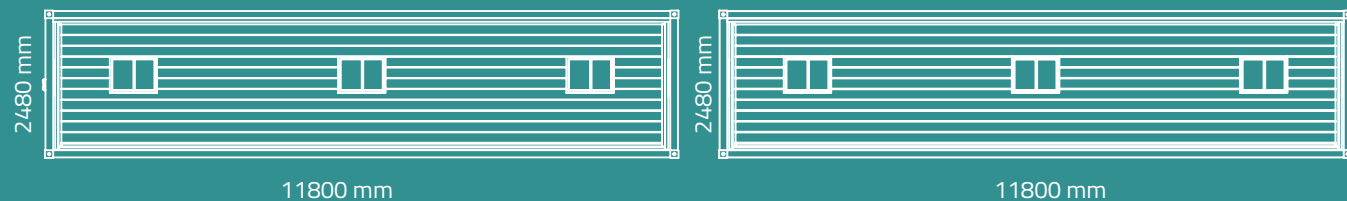

Left Side View

Right Side View

## 40' Expandable Container House Configuration



Standard 40 Feet Expandable Container House Configuration

Name	Content	Specifications
Main Frame (Fully Galvanized)	Top Side Beam	80×100×3.0 mm square tube
	Top End Beam	Bending parts 2.5 mm
	Bottom Side Beam	80×100×3.0 mm square tube
	Bottom End Beam	Bending parts 2.5 mm
	Galvanized Lifting Lug	Galvanized hanging head 210×150×160 mm
Expandable Part Frame (Fully Galvanized)	Top Frame	40×80×1.5 mm P-shaped tube 40×80×1.5 mm Square tube
	Bottom Frame	60×80×2.0 mm Square tube
	Folding Hinge	130 mm Galvanized hinge
Overall Frame P protective Coating	Spraying	Electrostatic Spraying / Direct Coating Powder + corrosion resistant coating
Roof Panel	External Roof Panel	t 50 mm EPS color steel sheet + 0.4 mm corrugated single sheet
	Internal Ceiling Panel	Model 200 Ceiling Panel
Wall Panel	Side Walls, Front And Back	t 65 mm EPS color steel sheet
	Internal Partition Panel	t 50 mm EPS color steel sheet
Floor	Main Floor	18 mm fireproof cement fiber floor
	Expandable Part	18 mm bamboo plywood
Doors and Windows	Steel Plastic Sliding Window	920×920 mm
	Steel Single Door	840×2030 mm
Electrical System	Circuit Breaker System	32A leakage protector × 1, Voltage 220 V, 50 Hz
	Lights	"Bull" 30×30 mm flat lamp, large ceiling lamp
	Sockets	Standard international three-hole and five-hole sockets (socket standards can be customized)
	Light Switches	Double/Single opening (switch standards can be customized)
Wiring	Inlet wire 6 <sup>2</sup> , air conditioning socket 4 <sup>2</sup> , general socket 2.5 <sup>2</sup> , lighting 1.5 <sup>2</sup> . (Circuits can be customized)	
Loading Quantity	1 set/40'HQ	

# Layout

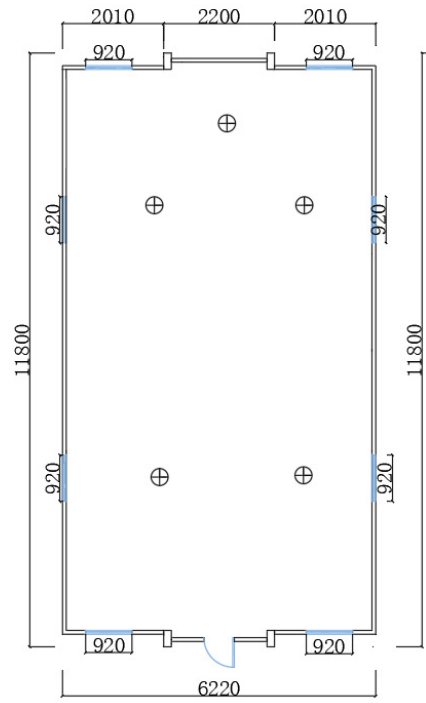

1 living room (default)

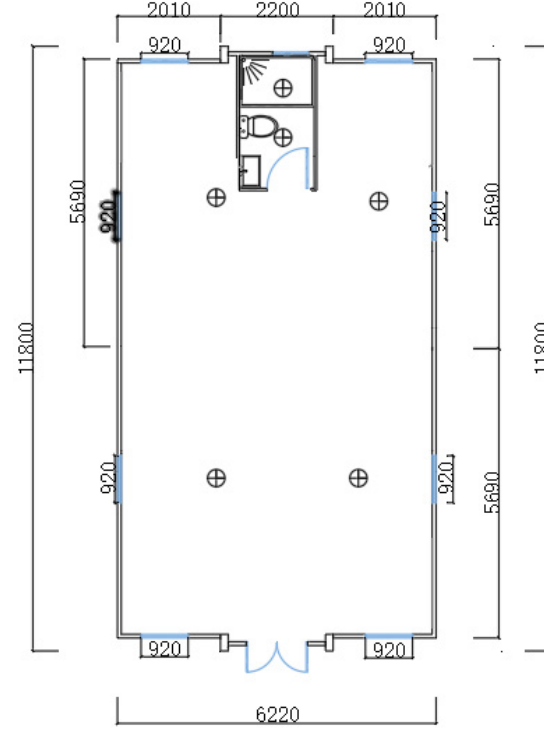

1 living room, 1 bathroom

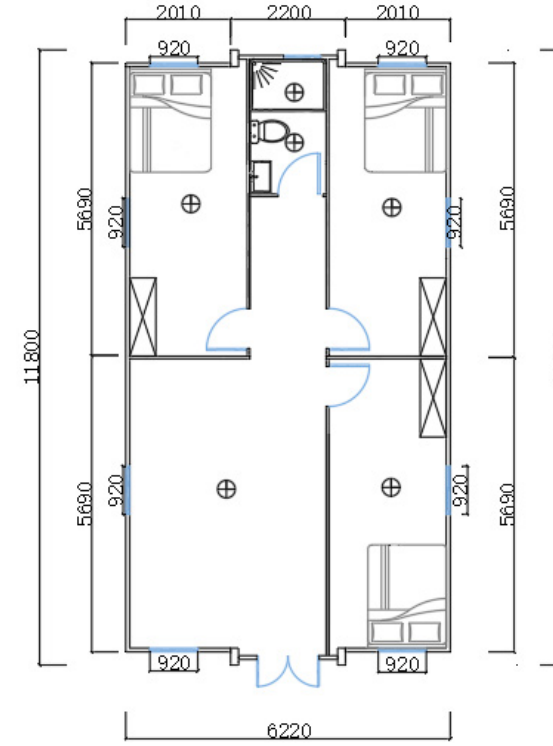

1 living room, 1 bathroom, 3 bedroom

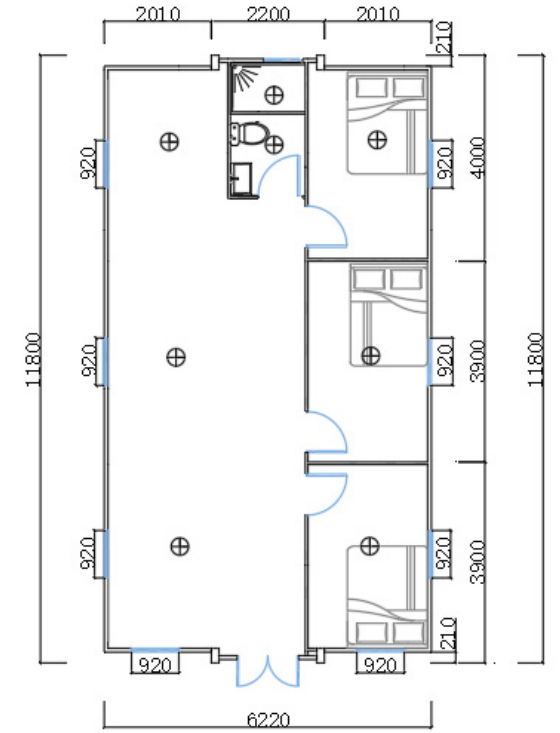

1 living room, 1 bathroom, 3 bedroom

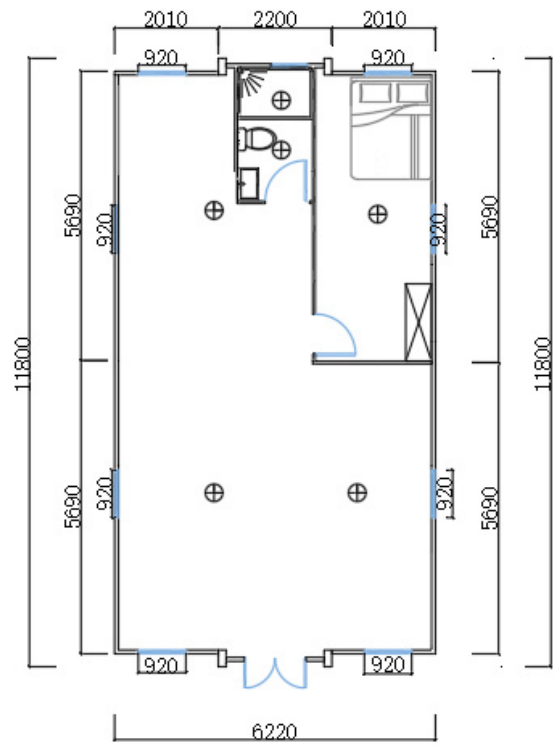

1 living room, 1 bathroom, 1 bedroom

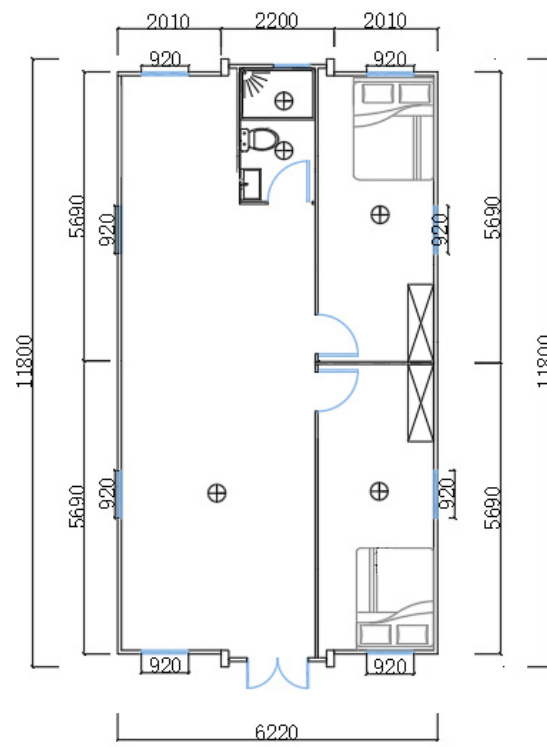

1 living room, 1 bathroom, 2 bedroom

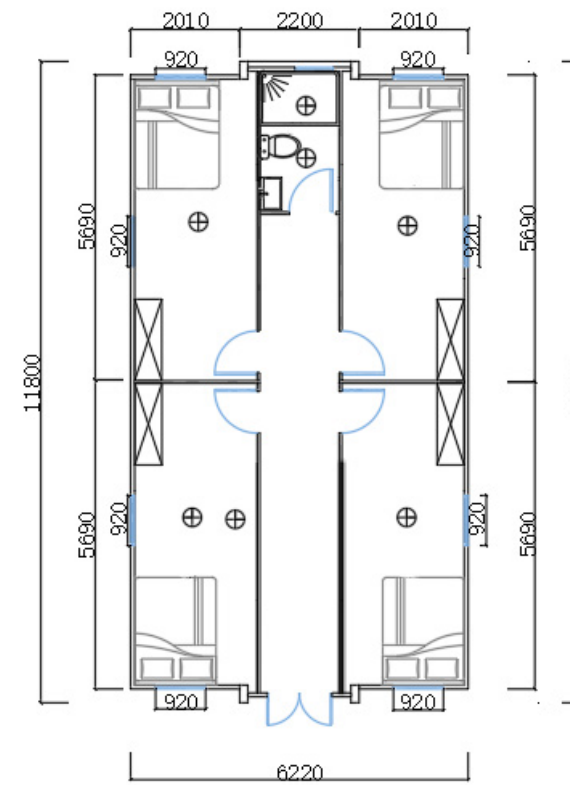

1 living room, 1 bathroom, 4 bedroom

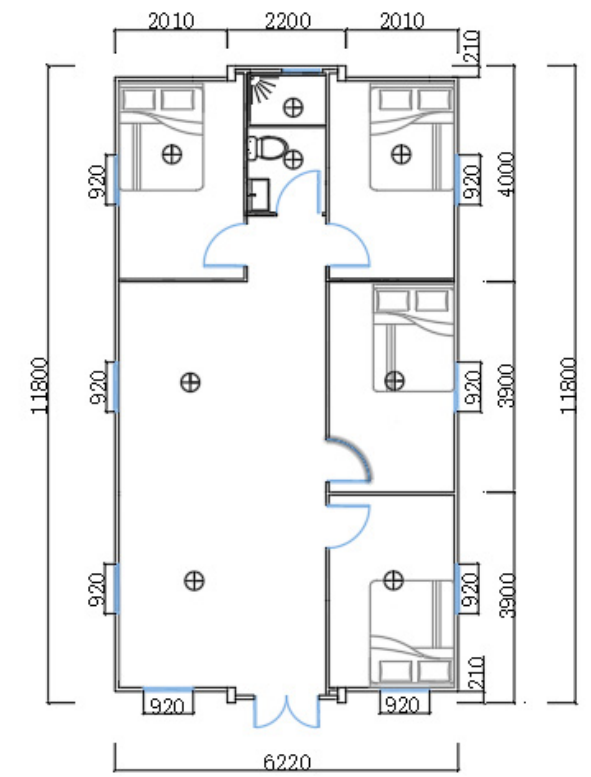

1 living room, 1 bathroom, 4 bedroom



# CUSTOMIZE

## Your Expandable Container House

We offer full customization options, allowing you to personalize every aspect of your container house, including layout, appearance, doors, windows, flooring, and interior fittings.



### Container Size

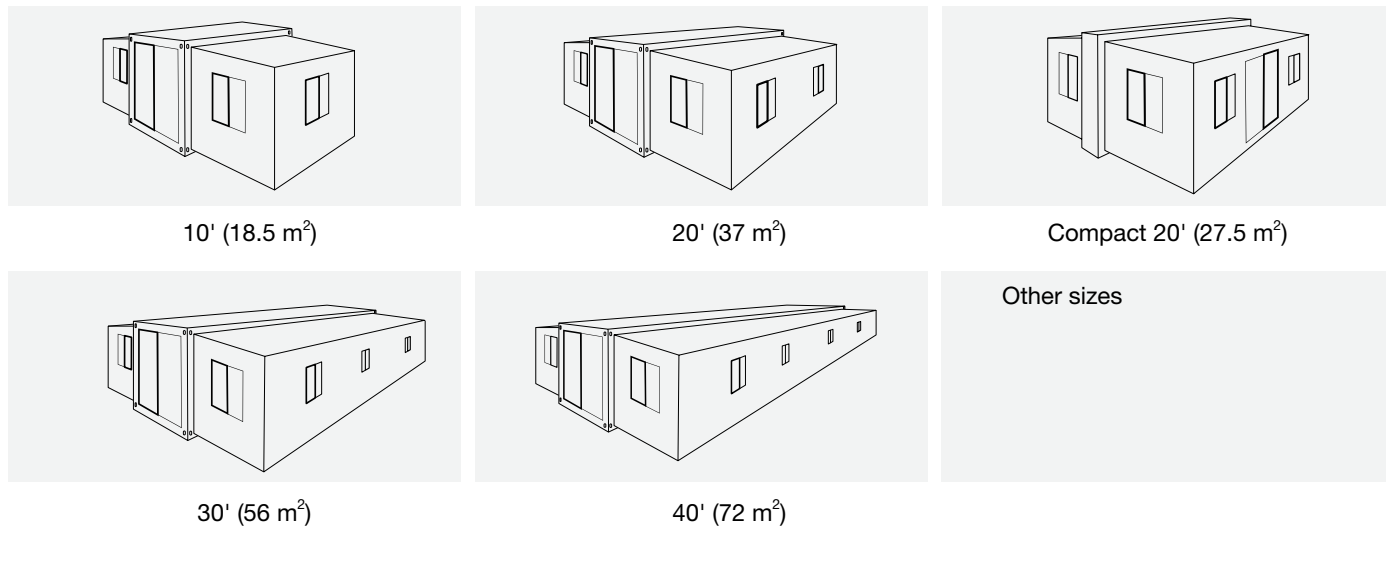

### Frame Color



### Wall Panel Color

#### Pure Color



### Metal carved panels

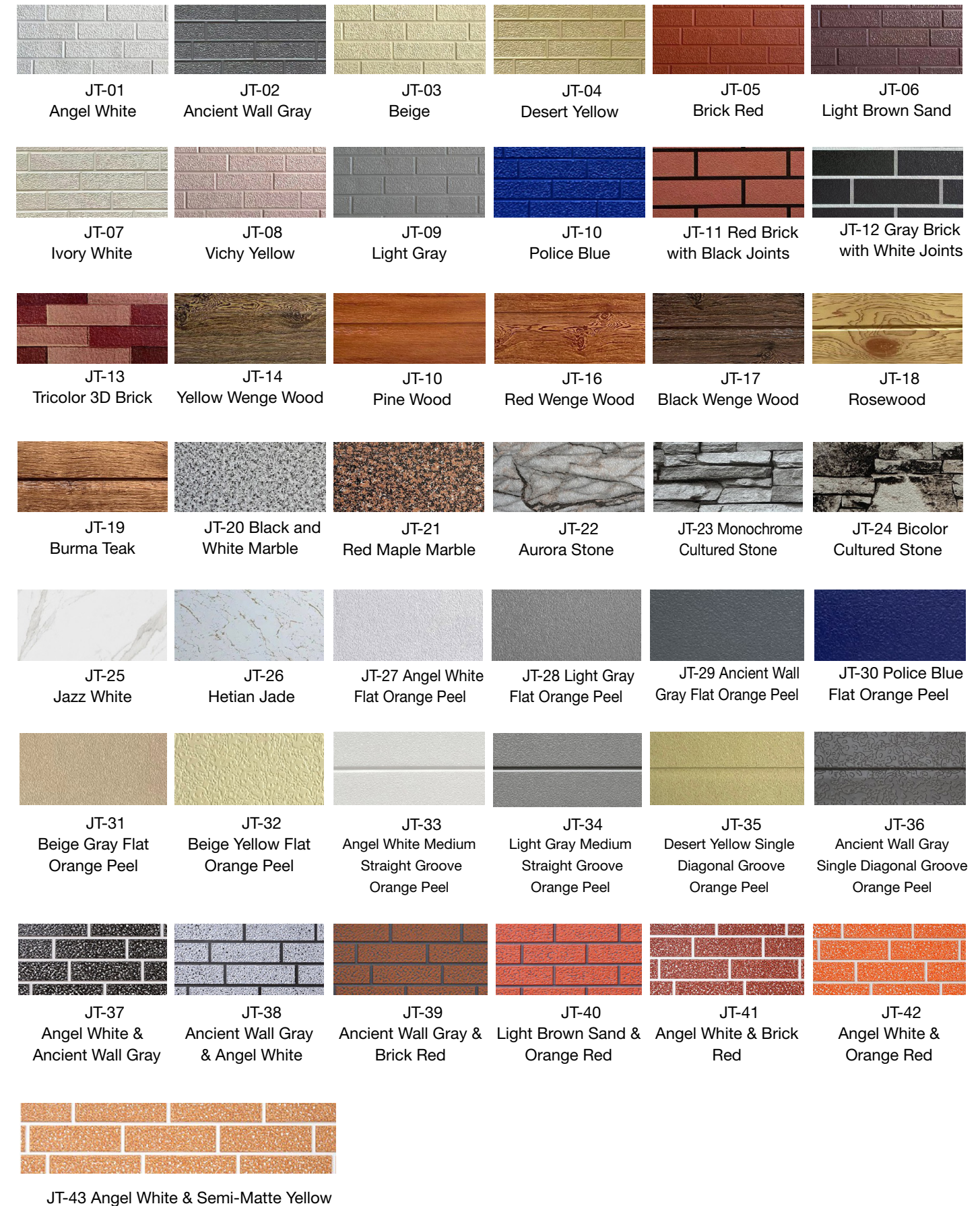



## Layout



1 living room



1 bedroom and 1 living room



2 bedroom and 1 living room



3 bedroom and 1 living room



4 bedroom and 1 living room

Others

## Specific Design

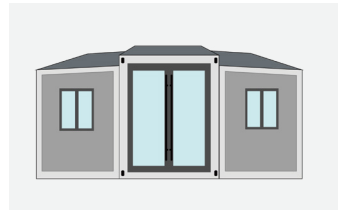

Elevated type

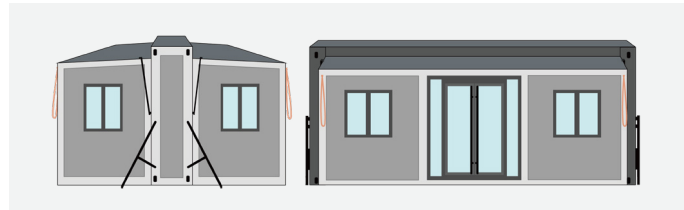

Compact type



With patio



Patio + shelter

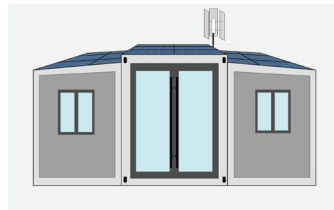

Solar panel + wind generator

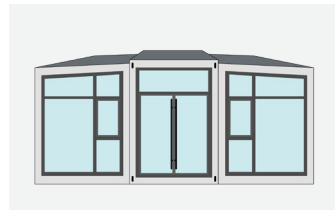

All glass



Double slope roof

Other requirements

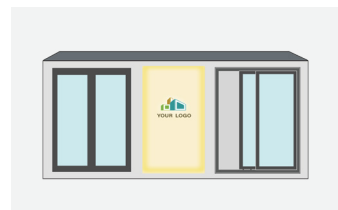

Customized logo + LED strip light



Two-story

## Entry Door

### Door Material



Steel fireproof door

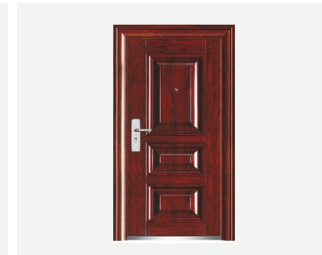

Aluminum alloy door



Thermal break door

Others

### Door Type



Single inswing



Single outswing - steel

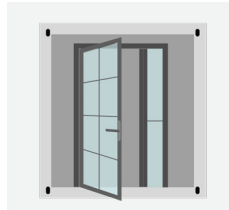

Single outswing - thermal break

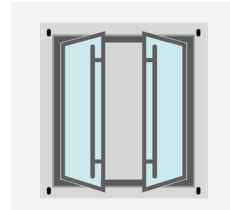

Double outswing

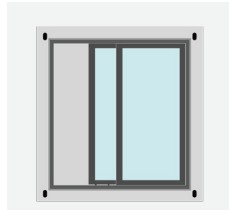

Sliding door

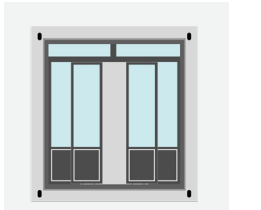

Double sliding

Others

## Window

### Window Material



Aluminum alloy jalousie

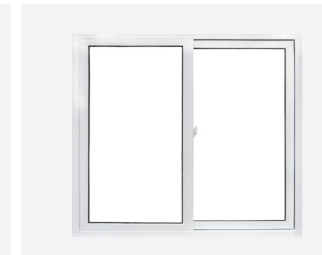

Plastic steel



Thermal break

Others

### Window Type

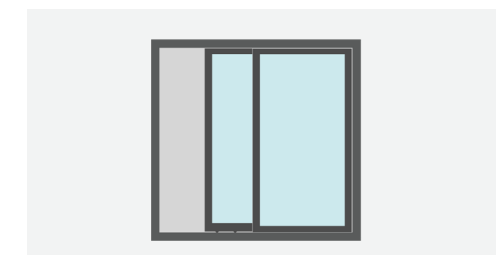

Sliding

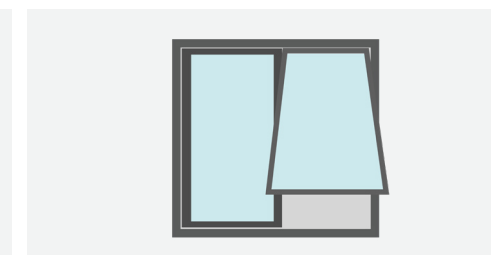

Awning

Others



## Floor



Fireproof cement fiber  
for main structure



Bamboo plywood floor  
for expandable part

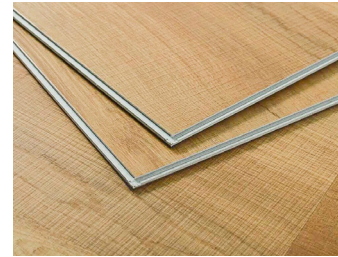

SPC floor



Vinyl flooring

Others

## Kitchen

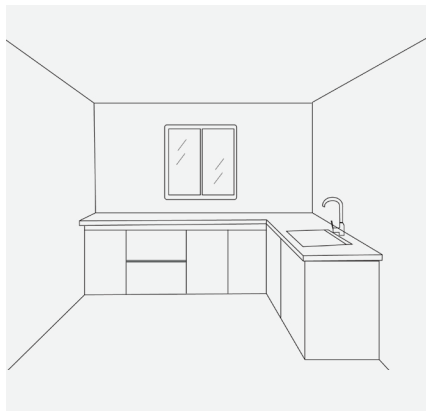

L shape cabinet



L shape cabinet & wall cabinet

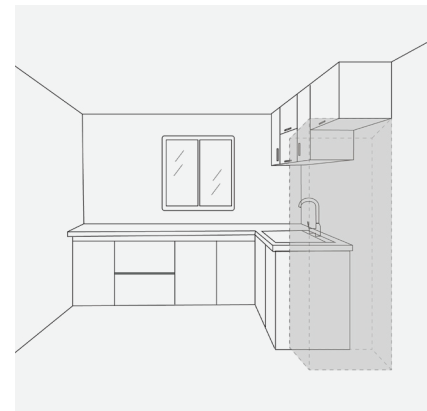

L shape cabinet & wall cabinet  
with fridge position

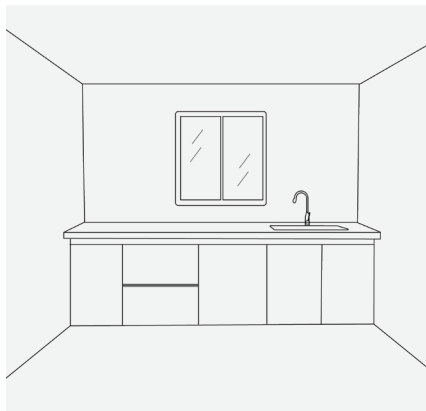

I shape cabinet

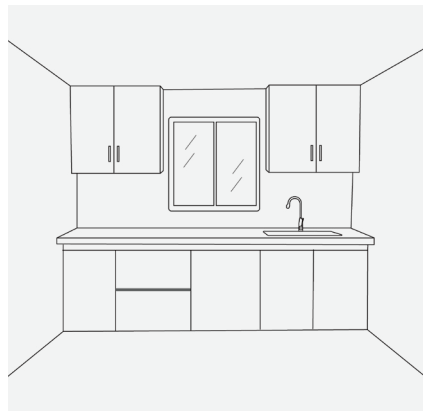

I shape cabinet & wall cabinet

No need

Other requirements

## Bedroom Door

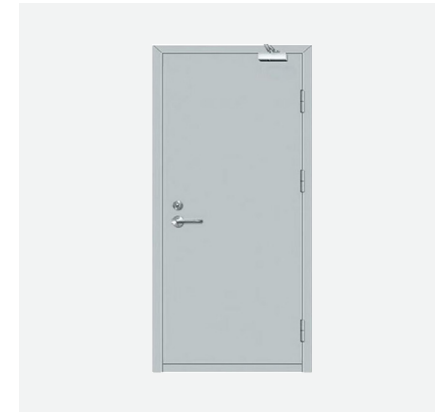

Fire-proof steel door



Wooden door

Others

## Bathroom

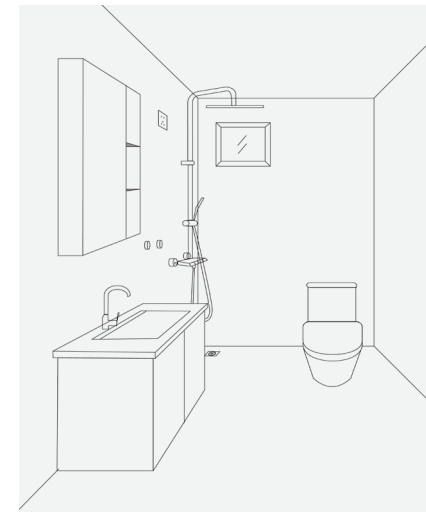

### Private bathroom

Including partitions, showerhead,  
washbasin, toilet, mirror, cabinet,  
titanium-magnesium alloy door,  
floor drain, and plumbing.

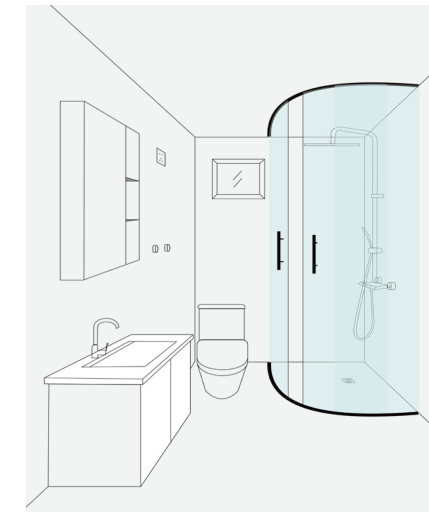

### Private bathroom + semi-circular shower room

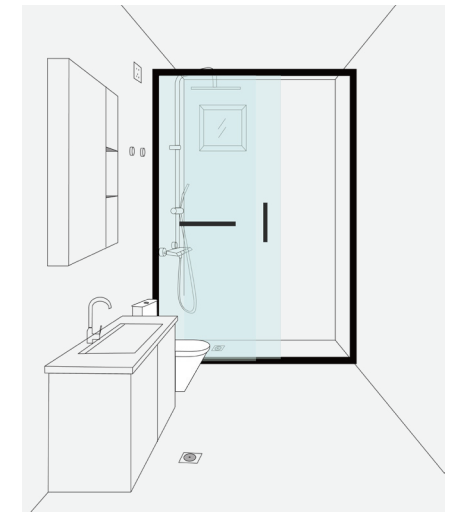

### Wet and dry separation bathroom

Including partitions, showerhead,  
washbasin, toilet, mirror, cabinet,  
titanium-magnesium alloy door,  
floor drain, and plumbing.

Others

## Other Requirements



# FOLDING CONTAINER HOUSE

**External Size:** L5800 × W2440 × H2500 mm

**Internal Size:** L5640 × W2320 × H2400 mm

**Folding Size:** L5800 × W2480 × H410 mm

**Total weight:** 1.2 ton

Folding container house, also called foldable container house, it is the early products of prefab container houses, which is widely popular in temporary uses, such as hospital, construction sites, office and military use.

Folding container house features fast installation which can be completed installation within 4 minutes. And it is also customizable for its materials, appearance, windows and doors as well as layout and configuration.

## Available Types



Pure Color



Wooden Color



Sliding door and all glass floor-to-ceiling window



Military Color



Porch & Shelter



Two-story combination design

## Product Features

### Easy to Transport & Save Space

The folding structure saves lots of space to load more container houses at the same time, which can save lots of freight fees. Besides, it is easy to load and transport.

### Safety & Durability

The entire structure is made of steel structure and anti-fireproof materials, which is anti-fire, anti-earthquake and anti-wind. Besides, the folding container house can be assembled and disassembled more than 6 times and the lifespan is more than 15 years.

### Rapid installation

Compared with expandable container house, the folding container house has the simpler installation steps and cost less times in installation. All installations can be completed within 4 minutes, which is suitable for construction site or urgent and temporary use.

### Customizable

The appearance of foldable container houses is available for pure color, military, wooden, stone and various other colors to suit your special requirements. Besides, the materials, doors&windows, layout, configurations are all customizable to make it more suitable for your specific needs.



## Folding Container House Configuration



Name	Content	Specifications
Basic Features	External dimensions	L5800 × W2440 × H2500 mm
	Internal dimensions	L5640 × W2320 × H2400 mm
	Folding state	L5800 × W2480 × H410 mm
	Total weight	1200 kg
Frame Structure	Top main beam	Q235B P-shaped square tube 60×80×1.3 mm
	Bottom main beam	Q235B Rectangular square tube 60×140×1.3 mm
	Front and rear main beams	Q235B special-shaped square tube 60×80×1.2 mm
	Side wall frame	Q235B P-shaped square tube 40×80×1.2 mm
	Bottom load-bearing	Q235B Rectangular square tube 40×40×1.2 mm
	Top load-bearing	Q235B Rectangular square tube 40×40×1.2 mm
	Hanging head	Q235B 125×200×4 mm
	Folding hinge	Galvanized hinge 13 mm
Roof	Overall frame protective coating	Electrostatic spraying/high gloss white
	External top plate	Corrugated board 0.4 mm
	Internal ceiling	Color steel veneer V831×0.25 mm
Wall Panel	Insulated glass wool	Fiberglass cotton roll 50 mm (bulk density 16 kg)
	Sidewall	50 mm composite board 0.23 mm +basalt wool (density 50 kg)±0.1 mm
	Front and rear wall panels	65 mm composite board 0.23 mm +basalt wool (density 50 kg)±0.1 mm
Floor	Fireproof glass magnesium floor 15 mm	
Electrical System	Electrical wiring must be installed strictly in accordance with moisture-proof regulations, and all electrical products must comply with CE certification. According to electrical engineering specifications, the wiring is connected as follows: indoor: incoming line with 42 national standard soft copper wire, 1 x 20A circuit breaker, socket incoming line 2.52, 1 x five-hole single switch socket, 1 x air conditioner socket, 1 x long strip LED light.	
Standard Security Door	High quality security door (warm white) dimensions: 970 × 1970 mm	
Window	930×930 mm plastic steel integrated security window, glass thickness 4 mm (warm white)	
Quality Assurance	The entire house reaches Class A fireproof standard.	

## Installation



### 1 Hook Up

Use the crane hooks to fix onto the four corner of folding container houses.

### 2 Lift Up

Use the crane to lift its roof slowly until the house is unfolded and stop the crane there.

### 3 Flip Up

Expand the front and rear wall of the folding container house. Push the front and rear wall from inside, and make it stand in the correct place.

### 4 Set Up

- Use the bolts to fix the whole structure. There wire be predrilled holes for bolts on the columns, and we will provide enough bolts for your installation.
- Install the door lock. To prevent the door lock from damaging the ceiling, we do not pre-install the door lock but instead place it separately. You can install the door lock after assembling the house. Please note: When disassembling or moving the house to another location, please remove the door lock in advance.

## Gallery







# FLAT PACK CONTAINER HOUSE

**External Size:** L5800 × W2440 × H2896 mm

**Internal Size:** L5630 × W2230 × H2515 mm

**Fireproof:** Grade A

**Wind-Resistance:** 0.5 kN/m<sup>2</sup>

**Anti-seismic:** Grade 8

**Roof live load:** 0.5 kN/m<sup>2</sup>

Flat pack container houses represent a modern, efficient, and sustainable solution for housing needs. The original structure have been manufactured and assembled in our factory and then they will be transported to your construction site for assembly. The assembly is easy and fast. They will just need several days, which saves lots of time and labor costs compared with traditional construction method.

Additional, they are flexible to be stacked and custom configurations. Their ease of assembly, durability, and customizable design make them an appealing choice for a wide range of applications, from temporary housing and emergency shelters to permanent residences and innovative architectural projects.

## Product Features

### Modular Design

Allows for flexible layout and customization.

### Cost-Effective

Easier and faster installation reduce labor and material costs.

### Good in performance

They provide excellent thermal, insulation as well as good wind and seismic performance.

### Stackable Configuration

Enables vertical stacking for multi-story living spaces.

### Quick Assembly

Can be assembled on-site within a few days for a full construction site, which saves lots of time compared with traditional construction method.

### Durability

Constructed from sturdy steel materials that can withstand various weather conditions.

### Portable

Easy to transport and relocate as needed. We will provide installation & disassembly guidance for your convenient operation.

## Specifications

Basic Information of Flat Pack Container House



**External Dimensions (L×W×H):** 5800×2400×2896 mm

**Internal Dimensions (L×W×H):** 5630×2230×2515 mm

**Thermal insulation performance:**  $\lambda = 0.043 \text{ W}/(\text{m}\cdot\text{K})$

**Wind resistance performance:** 0.50 kN/m<sup>2</sup>

**Sound insulation performance:** Sound insulation  $\geq 30 \text{ dB}$

**Fire resistance performance:** Class A

**Waterproof performance:** Class II

**Seismic performance:** Level 8

**Floor live load:** 2.0 kN/m<sup>2</sup>

**Roof live load:** 0.50 kN/m<sup>2</sup>

**Structure Surface Treatment:** Electrostatic spray white

**Connection method:** High-strength bolt connection



## Technical Parameters of Flat Pack Container House

Part	Name	Components	Quantity	Unit
Main frame (bare steel)	Top frame	170 mm top side beam 2.3 mm × 2 Top crossbeam × 2 pieces Purlins × 50 C-shaped steel × 6 20×20×6000 square tube × 2 Explosion-proof junction box × 1	1	set
	Bottom frame	160 mm, bottom side beam 2.3 mm × 2 Bottom crossbeam × 2 Purlins × 120 C-shaped steel × 9	1	set
	Column	2535×150×210×2.3 mm	4	pc
	Top/bottom corner castings	-	1	set
	L-corner	-	1	set
	Color steel roof	Color steel single panel 360° seam 0.4 mm	1	set
	831 ceiling panel	YX28-277-831, 0.3 mm	1	set
	Top insulation	75 mm thick single foil glass wool 14 kg/m <sup>3</sup> + PE film	1	set
	Drainage	PVC 50×2.0×2700	4	pc
	Floor	Ground	18 mm glass magnesium board	1
1.6 mm PVC plastic floor			1	set
Wall panel	Composite board	1150 double-sided 0.30 mm - 75 mm rock wool, density 50 kg/m <sup>3</sup> , H-shaped, one side orange peel texture, one side flat white, double-sided PE film	15	pc
Doors and windows	Doors and windows	Steel door 840×2035 mm	1	Set
		Plastic steel sliding window 1110×1120 mm - 2 pieces, double sliding, with screen window, anti-theft grille (UPVC)	2	Set
Electrical appliances	Lights	LED decorative light 36W × 2	1	set
	Sockets	10A five-hole socket - 3 pieces, three-hole socket 16A - 1 piece		
	Switches	Single key switch - 1 piece, concealed distribution box - 1 piece		
	Electrical wiring	2×1.5m <sup>2</sup> lighting wire, 3×2.5m <sup>2</sup> socket wire, 3×4m <sup>2</sup> air conditioner wire, 3×6m <sup>2</sup> main wire		
	Industrial sockets	220V 50Hz 3P32A		
Decoration	Column corner covers	2535 mm color steel profiled part	4	pcs
	House bottom	U-shaped water diversion channel	1	set
Accessories	Wall panel clips	Z-shaped clip	1	set
	Accessories	Matching screws, self-drilling screws, floor nails, cross half-round head	1	set

## Installation

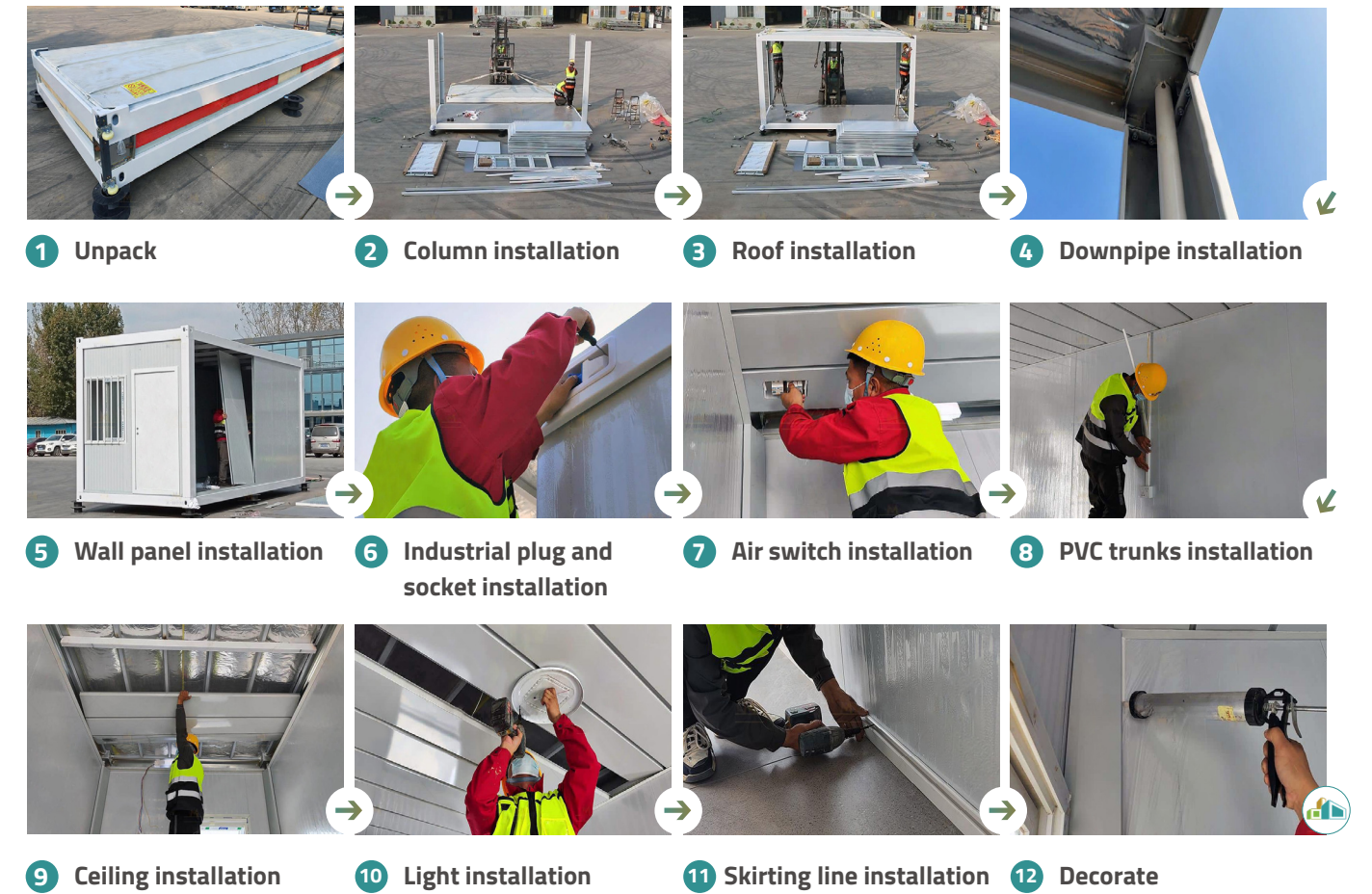

## Gallery







# APPLE CABIN

**Dimensions:** L6000 × W3300 × H3000 mm

**Floor Area:** 20 m<sup>2</sup>

**House Type:** One bedroom, one bathroom

**Number of People Accommodated:** 2 people

**Power Consumption:** 12 kW

**Total Weight:** 5.4 tons

The Apple Cabin, as a new generation of intelligent mobile living products, features a simple and elegant exterior that blends perfectly with nature. The interior layout is spacious and naturally comfortable, with the overall structure made of fully galvanized steel frames and an aviation aluminum shell. The design is aesthetically pleasing and avant-garde, easy to assemble, and suitable for use as an office, dining space, or guesthouse.

## Perimeter Protection System

### Steel Structure

Hot-dipped galvanized steel frame

### Shell

Aluminum alloy shell coating + fluorocarbon baking paint fully filled with thermal insulation layer (polyurethane foam)

### Glass curtain wall

Low-e hollow insulated glass

### Window

Low-e hollow insulated glass

### Door

High-end thermal break entrance door (including smart door lock)

### Periphery

Perimeter ambient light strip

## Interior Decoration

### Interior wall

9 mm OSB (B3 waterproof) + aluminum composite panel walls and ceiling

### Flooring

Eco-friendly composite flooring (cement fiberboard + composite floor)

### Bathroom panel

Aluminum composite panel walls

### Bathroom door

privacy glass door

### Bathroom floor

High-grade non-slip floor

### Toilet

Huida smart toilet

### Heater

Midea 60L storage water heater (indoor)

### Ventilation

Opple bathroom heater with lighting, ventilation, and heating

### Washbasin

Huida high-end washbasin, bathroom mirror, pull-out faucet, showerhead, floor drain

### Towel rack

Multifunctional towel rack (optional towel dryer)

### Drainage

System drainage pipes

### Lighting

Whole House LED lighting system + indoor ambient lighting

### Hydropower

Whole house plumbing and electrical system (flame retardant wires/branded circuit breakers/stainless steel corrugated water pipes)

### Air conditioner

Midea 1.5 P heating and cooling air conditioner (Level 1 energy efficiency)

### Storage cabinet

High-end eco-board customization



## Intelligent and Environmentally Friendly Equipment

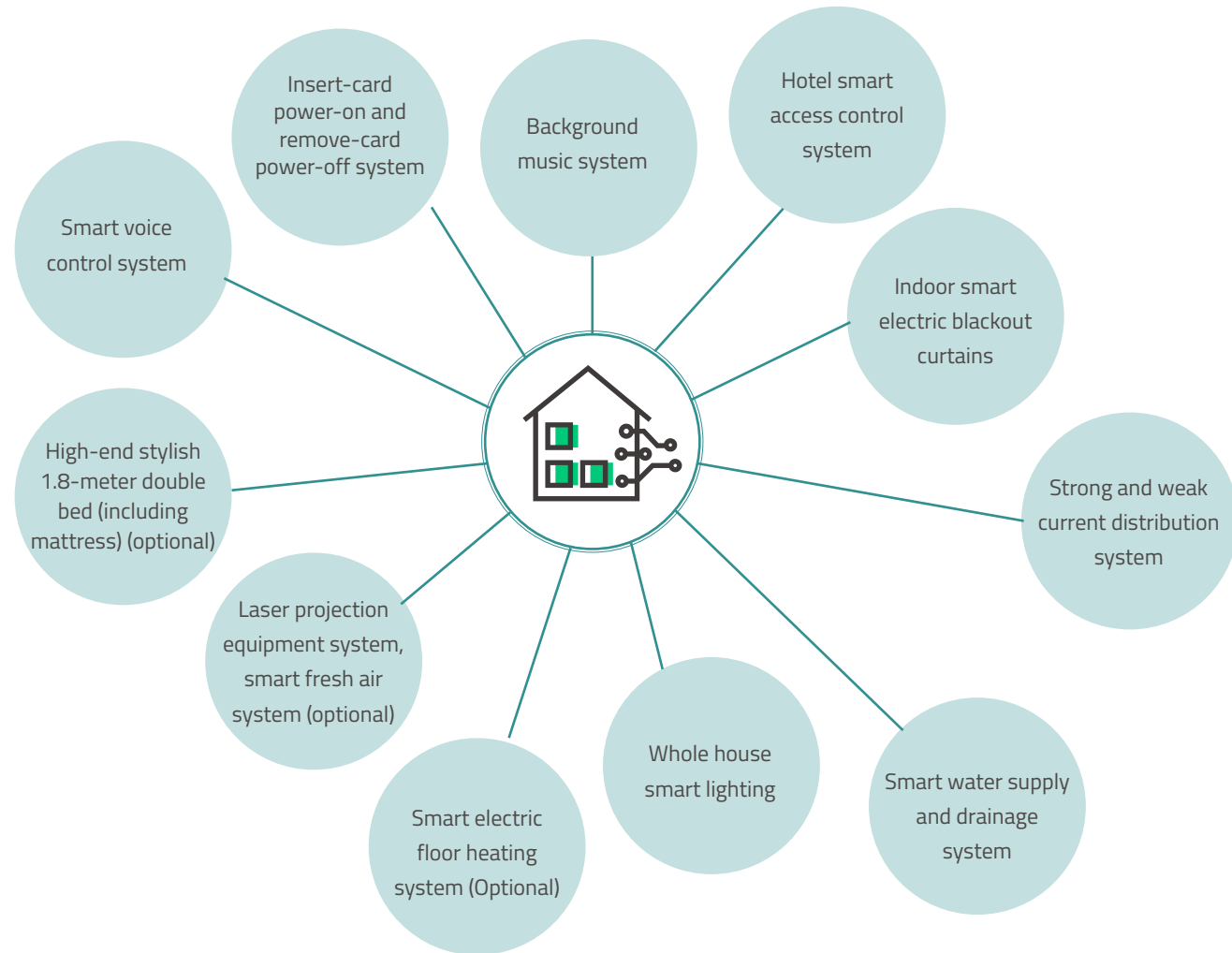

## Advantages

### Prefabricated

All configurations are prefabricated in the factory, you can achieve immediately move-in.

### Modern and intelligent

It provide a special enjoy for both living and working. It can also be used in the vacation village as the feature room.

### Mobile Socket

Utilizes a Power Track, Sockets are Removable, Only Need to Match the Corresponding Sockets When Exporting, No Need for Rewiring

### Durable

Steel structure are eco-friendly and is resistant to earthquake, wind, fire and other bad weathers.

### New Type of Water Pipe

Stainless Steel Corrugated Water Pipe, Resistant to Extreme Cold, No Scaling, One-Piece Design, Never Leaks

## Gallery

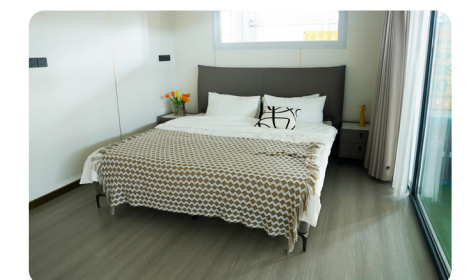
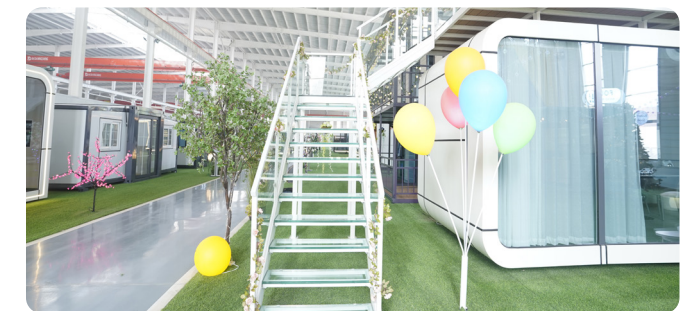





# CAPSULE HOUSE

## – Ideal for Vacation & Camping

The capsule house boasts a novel and futuristic appearance, utilizing an eco-friendly design approach. The overall framework is sleek and straightforward, making the layout a classic example of high-end camping accommodation products in the industry. With its broad applicability, it is an ideal choice for tourism and vacations.

- ✓ **Modern and intelligent**  
Unique appearance and whole-house intelligent system make the capsule house high grade and more pleasing.
- ✓ **Different option**  
8.5 m and 11.5 m options match with different customers of families, individual as well as couples.
- ✓ **Ideal for hotel and camping**  
The design and system is ideal for high class hotels, vacation village and camping.
- ✓ **Durable**  
All steel structure is durable and resistant to wind, earthquake, fire and other bad weathers.





# 8.5 m Capsule House

**Dimensions:** L8560 × W3460 × H3400 mm

**Floor Area:** 29.6 m<sup>2</sup>

**Layout:** one bedroom, one bathroom and one balcony

**Number of People:** 2 people

**Power Consumption:** 12 kW

**Total weight:** 7 ton



## Perimeter Protection System

### Main Frame

Hot-dip galvanized steel pipe + Galvalume light steel keel

### Shell And Insulation

Aluminum alloy shell coating + fluorocarbon baking paint, 50 mm extruded board + polyurethane filling

### Bottom

Aluminum composite panel + cement fiberboard + wood-plastic composite decking

### Support And Hoisting

20 mm thick bottom support, top hoisting ears

### Glass Curtain Wall

Tempered hollow Low-e insulated glass 6+18A+6

### Door

Entrance door (with smart lock)

### Balcony

Enclosure (laminated tempered glass) thermal break aluminum alloy balcony door (with lock)

### Perimeter

Perimeter ambient light strip + decorative lighting

## Intelligent & Eco-Friendly System



## Interior Decoration

### Interior wall

9 mm OSB board (B3 waterproof) + bamboo charcoal fiber integrated wall panel

### Flooring

SPC eco-friendly wood flooring (stone plastic composite) for rooms and bathrooms

### Suspended ceiling

9 mm OSB board (B3 waterproof) + bamboo charcoal fiber integrated ceiling

### Lighting

Whole-house LED lighting system + indoor ambient lighting

### Bathroom wall panel

Bamboo charcoal fiber interior wall panels

### Bathroom door

Privacy glass door

### Bathroom flooring

Stone plastic composite flooring (with moisture-proof cotton)

### Bathroom configuration

Washbasin, vanity, bathroom mirror, faucet Shower, storage rack, floor drain

### Bathroom ventilation

Integrated bathroom heater with lighting, ventilation, and heating

### Bathroom others

Shower room base protection mat, glass partition, glass door, water barrier stone

### Toilet

Flush toilet

### Bathroom heater

Midea storage water heater 60 L

### Drainage

Sewage pipeline system

### Water supply

Whole-house water supply system (branded water pipes)

### Electricity

Whole-house electrical system (flame-retardant wires, branded circuit breakers)

### Air conditioner

Midea split air conditioner 1.5 P (including installation, copper pipes, remote control)

### Accessories

T-strips, structural adhesive, glass adhesive, foam adhesive, hardware accessories, etc.

## Optional Configuration

- Skylight: laminated + hollow insulated glass, electric skylight sunshade
- Smart voice control system
- Indoor smart electric blackout curtains
- Whole-house intelligent integrated lighting control system
- Smart underfloor heating system
- Laser projection equipment system, smart fresh air system



# 11.5 m Capsule House

**Dimensions:** L11560 × W3460 × H3300 mm

**Floor Area:** 38.8 m<sup>2</sup>

**Layout:** two bedroom, one bathroom and one balcony

**Number of People:** 2–4 people

**Power Consumption:** 12 kW

**Total weight:** 9 ton



## Perimeter Protection System

### Steel Structure

Hot-dip galvanized steel frame

### Shell

Fully covered aluminum alloy shell + fluorocarbon baking paint with full insulation layer (polyurethane foam)

### Glass Curtain Wall

Tempered hollow Low-e insulated glass

### Skylight

Laminated + insulated double glazing

### Door

Entrance door (with smart lock)

### Balcony

Enclosure (laminated tempered glass) thermal break aluminum alloy balcony door (with lock)

### Perimeter

Perimeter ambient light strip

## Intelligent & Eco-Friendly System



## Interior Decoration

### Interior wall

9 mm OSB board (B3 waterproof) + Carbon Crystal Panel Wall and Ceiling

### Flooring

SPC eco-friendly wood flooring (stone plastic composite) for rooms and bathrooms

### Bathroom wall panel

Carbon crystal panel wall

### Bathroom door

Privacy glass door

### Bathroom flooring

High grade anti-slip flooring

### Bathroom configuration

Huida High-end Wash Basin, Bathroom Mirror, Pull-out Faucet, Shower, Floor Drain

### Bathroom ventilation

Oppl integrated bathroom heater with lighting, ventilation, and heating

### Toilet

Huida smart toilet

### Bathroom heater

Midea storage water heater 60 L

### Drainage

Sewage pipeline system

### Lighting

Whole-house LED lighting system + indoor ambient lighting

### Water & Electricity

Whole-house Water and Electrical System (Flame-retardant Wires, Branded Circuit Breaker, Stainless Steel Corrugated Water Tank)

### Air conditioner

Midea 2HP Ducted Heating and Cooling Air Conditioner (First-Class Energy Efficiency)

### Storage Cabinet

Customized High-end Eco-friendly Board

### Bedroom Door

Premium Interior Door

### Accessories

T-strips, structural adhesive, glass adhesive, foam adhesive, hardware accessories, etc.

## Optional Configuration

- Skylight: laminated + hollow insulated glass, electric skylight sunshade
- Smart voice control system
- Indoor smart electric blackout curtains
- Whole-house intelligent integrated lighting control system
- Smart underfloor heating system
- Laser projection equipment system, smart fresh air system

# 「CREATIVE CONTAINERS」

We can not only provide standard prefabricated container houses for your efficient and easy installation. We can provide creative containers for your unique and extraordinary design. You just tell us your purpose and your ideas, we will design and complete the preliminary installation at our factory. You can fulfill them within a short time.

Our creative containers are suitable for dormitories, offices, shops and other uses. Our aim is to make your dreaming design be true.

Here are several designs of creative containers, just enjoy them and inspire your creativity.

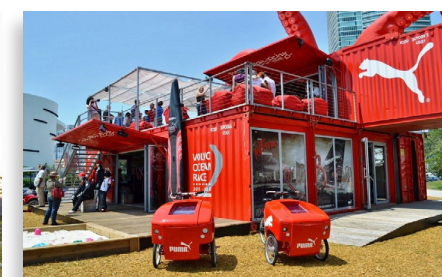
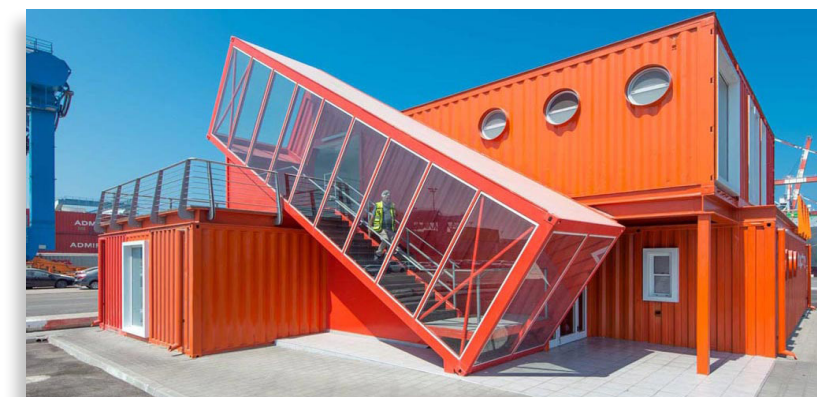
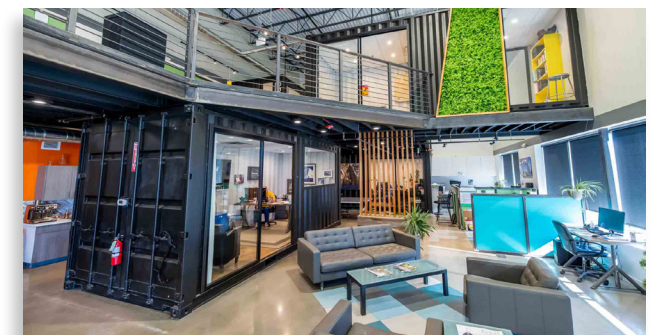
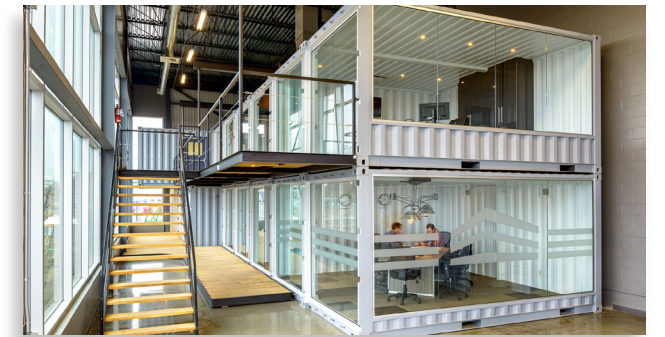



# APPLICATIONS & PROJECTS

Prefabricated container houses are incredibly versatile, excelling as residences, modern office spaces, construction site dormitories, and emergency relief shelters. With their robust structure, quick installation, and cost-effectiveness, they are the perfect choice for various scenarios.

 Residence

 Hotel

 Office

 Hospital

 Shops

 Construction site

 Military

 Temporary use

## Residence





 Office



 Military



 Shop



 Hotel

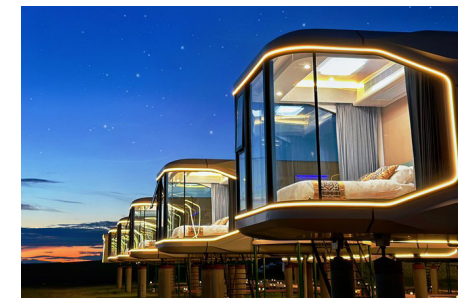



 Hospital



 Temporary Use



 Construction Site





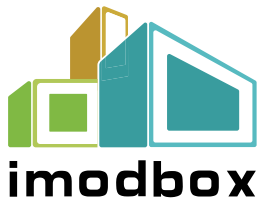

## Hengshui Jingtong Integrated Housing Co.,LTD

Address: Room 1202, Block #A, Huizhong Plaza, No.285 Renmin East Road, Taocheng District, Hengshui City, Hebei Province.

Mobile: +86-15297601111

E-mail: [tian@imodbox.com](mailto:tian@imodbox.com)

WhatsApp: +86-18830819992

WeChat: +86-18830819992

Website: [www.imodbox.com](http://www.imodbox.com)