

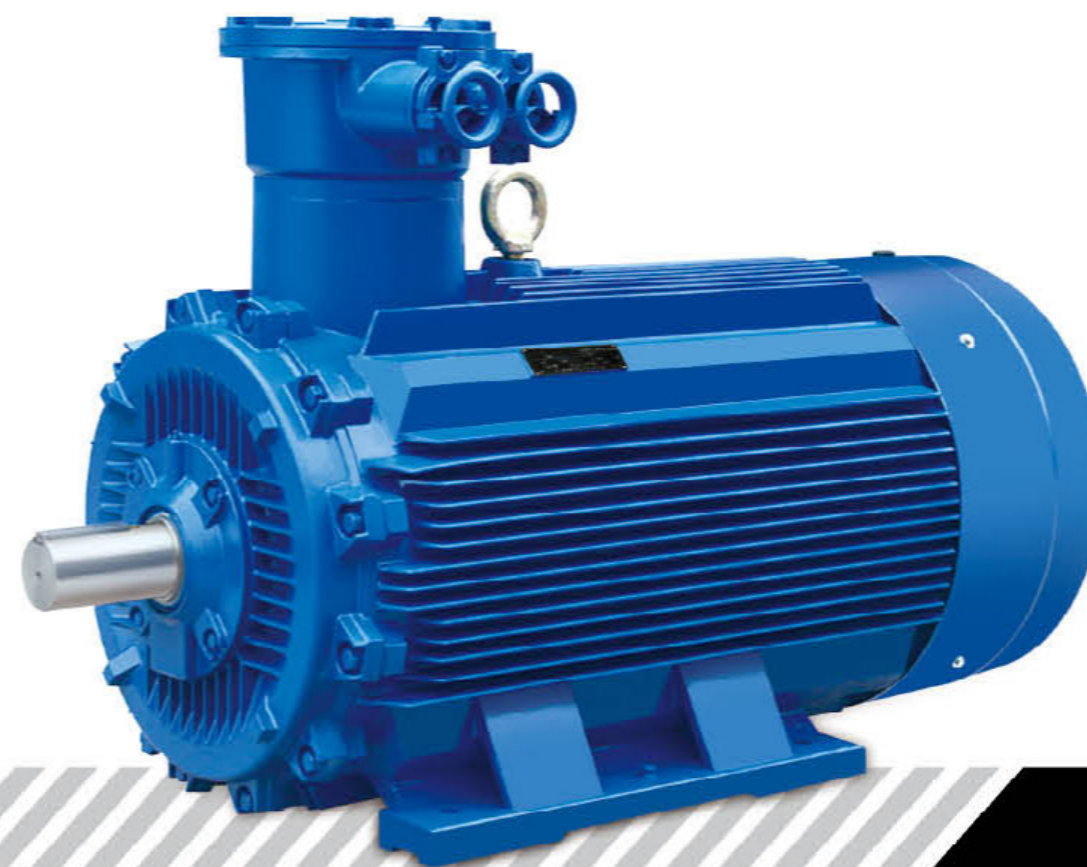

四川继泽电机有限公司
SICHUAN JIZE MOTOR CO.,LTD.



[扫一扫]添加二维码



四川继泽电机有限公司
SICHUAN JIZE MOTOR CO.,LTD.

地址:四川省德阳市广汉市阳江路16-3号

Add: No.16-3, Yangjiang Road, Guanghan City, Deyang City, Sichuan Province

在本样本中向您提供的信息得到极其认真仔细的编辑,其内容不断更新。尽管经过仔细审核,仍不能保证毫无差错。四川继泽电机有限公司保留有在任何时候修改或增加信息或数据而事先不作通知的权利。





Quality system 质量体系

公司始终不渝地严格贯彻执行 ISO9001 质量管理体系的规定，从市场调查，产品设计和开发、原材料进货、加工与装配、出厂检验、直到售后服务实施全过程的质量控制。

Modern manufacturing philosophy 现代化的生产理念

公司坚持质量第一的方针，采用先进的生产设备，推行精益生产管理，不断提高产品的质量和品味，以品牌魅力和良好信誉赢得海内外顾客的信赖，从而增强了市场竞争力。

Professional & Control 专业·把控

公司在生产过程当中严格按照国际质量体系标准执行；生产部门在领料时须进行产前检验，生产过程中每一道工序须进行检验，工序完成后须对产品进行全方位性能检测。

关于我们 ABOUT US

四川继泽电机有限公司是一家专业生产各类中小型电机的现代企业，产品主要有 YE2 系列超高效三相异步电动机、YE3 系列超高效三相异步电动机、YE4 系列超高效铜转子、YE3 系列格兰富超高效铝壳电机、YD 系列变极多速三相电动机、YDT 系列变极多速三相异步电动机、YBX3 隔爆型三相异步电动机、Y-H 船用三相笼式异步电动机系列、YCT 系列电磁调速电动机、MS 系列铝壳三相异步电动机、YVF2 系列变频调速三相异步电动机、YEJ 系列电磁制动三相异步电动机、YK2 系列螺杆电机、Y 系列 (IP23) 开放式电机等产品。

四川继泽电机有限公司视人才为企业的发展之本，具有雄厚的科技研发团队，拥有行业内最先进的自动化数控生产设备，先进的工艺装备，运用先进的设计软件进行产品设计，完善的现代化管理体系，严格按“ISO-9001”国家质量体系认证管理生产，使新产品开发速度和成功率大提高，为同行业领先水平，本公司有先进的电机检测设备，使产品质量得到有力保证，也因此赢得了国内外客户的广泛信赖和赞誉，本公司通过中国的 CCC 认证和 CQC 认证、ISO-9001 国际质量体系认证、CE 认证、SGS 认证 (ROHS)，并取得国家电机产品出口质量许可证，我们以不断的创新面对市场；产品畅销全国各地并出口东南亚地区、德国、意大利、波兰、英国、法国、中东地区、南美洲、非洲、亚洲等 80 多个国家和地区。在国内广泛应用于空压机、清洗机、水泵、风机、机械、减速机等行业。

我们愿以最优质的产品、最优惠的价格、最周到的售前、售中、售后服务，与社会各界朋友竭诚合作，携手共进、共创美好未来。

SICHUAN JIZE MOTOR CO., LTD. is a modern enterprise specializing in the production of various small and medium-sized motors. Its products mainly include YE2 series ultra-efficient three-phase asynchronous motors, YE3 series ultra-efficient three-phase asynchronous motors, YE4 series ultra-efficient copper rotors, and YE3 series grids. Lanfu ultra-efficient aluminum housing motor, YD series pole-changing multi-speed three-phase motor, YDT series pole-changing multi-speed three-phase asynchronous motor, YBX3 flameproof three-phase asynchronous motor, YH marine three-phase cage asynchronous motor series, YCT series Electromagnetic speed regulating motor, MS series aluminum shell three-phase asynchronous motor, YVF2 series variable frequency speed regulating three-phase asynchronous motor, YEJ series electromagnetic brake three-phase asynchronous motor, YK2 series screw motor, Y series (IP23) open motor and other products.

SICHUAN JIZE ELECTRIC CO., LTD. regards talents as the foundation of enterprise development, has a strong scientific and technological research and development team, has the most advanced automated CNC production equipment in the industry, advanced process equipment, and uses advanced design software for product design, perfect modernization The management system, strictly in accordance with the "ISO-9001" national quality system certification management production, greatly improved the speed and success rate of new product development, leading the industry, the company has advanced motor testing equipment, so that product quality can be effectively guaranteed. As a result, it has won widespread trust and praise from customers at home and abroad. The company has passed China's CCC certification and CQC certification, ISO-9001 international quality system certification, CE certification, SGS certification (ROHS), and obtained the national electrical product export quality license. , We face the market with continuous innovation; our products sell well all over the country and are exported to more than 80 countries and regions such as Southeast Asia, Germany, Italy, Poland, the United Kingdom, France, the Middle East, South America, Africa, and Asia. It is widely used in air compressor, cleaning machine, water pump, fan, machinery, reducer and other host industries in China.

We are willing to cooperate wholeheartedly with friends from all walks of life with the highest quality products, the most favorable prices, the most thoughtful pre-sales, in-sales, and after-sales services, and work together to create a better future.

品質保證

QUALITY

ASSURANCE



继泽凭借精良的设备，完善的工艺流程，现代化的生产管理，为世界各地的客户生产高品质的产品。

在建设以企业为主体，研发和创新相结合的技术合作模式基础上，继泽采取“走出去，请进来”的形式，开展业内的技术交流、人才培养等，推动继泽国际化进程。

CONTENTS 目录

无以感谢，唯报品质！

	<p>YE2 Series 超高效三相异步电动机 Premium efficiency three-phase asynchronous induction motor</p> <p>P01</p>		<p>YE3 Series 格兰富超高效铝壳电机 Grundfos ultra-efficient aluminum motor</p> <p>P14</p>		<p>YBX3 Series 隔爆型三相异步电动机 Flameproof three-phase asynchronous motor</p> <p>P33</p>		<p>YVF2 Series 变频调速三相异步电动机 Variable frequency speed regulation three-phase asynchronous motor</p> <p>P49</p>
<p>YE3 Series 超高效三相异步电动机 Premium efficiency three-phase asynchronous induction motor</p> <p>P07</p>		<p>YD Series 变极多速三相异步电动机 Pole-changing multi-speed three phase asynchronous electric motor</p> <p>P20</p>		<p>MS Series 铝壳高效三相异步电动机 Aluminum shell high efficiency three-phase asynchronous motor</p> <p>P40</p>		<p>YCT Series 电磁调速电机 Adjustable-speed motor</p> <p>P52</p>	
	<p>YE4 Series 系列超高效铜转子 Series Ultra high efficiency copper rotor</p> <p>P12</p>		<p>YDT Series 变极多速三相异步电动机 Pole-changing multi-speed three phase asynchronous electric motor</p> <p>P23</p>		<p>YEJ Series 电磁制动三相异步电动机 Electromagnetic brake three-phase asynchronous motor</p> <p>P45</p>		<p>YK2 Series 螺杆电机 Motor for screw compressor</p> <p>P55</p>
	<p>Y-H Series 船用三相笼式异步电动机 Marine three-phase cage asynchronous motor</p> <p>P26</p>		<p>IP23 Series Y 系列 (IP23) 开放式电机 Y series (IP23) motor</p> <p>P57</p>				

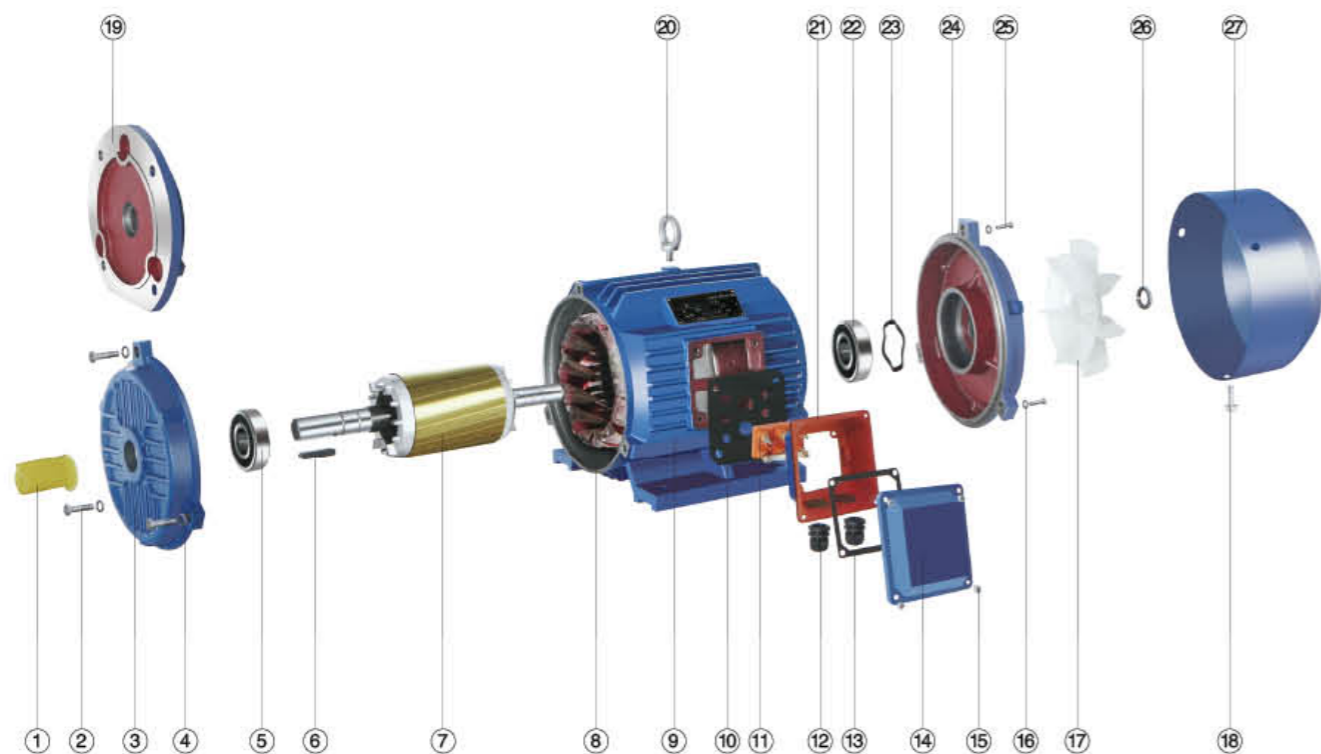

产品分解图

EXPLODED VIEW

1. 轴套 (Shaft cover)
2. 螺栓 (Bolt)
3. 前端盖 (Front endshield)
4. 弹簧垫圈 (Spring washer)
5. 轴承 (Bearing)
6. 键 (Key)
7. 转子 (Rotor)
8. 定子 (Stator)
9. 机座 (Frame)
10. 皮垫 (Leather washer)

11. 接线板 (Terminal board)
12. 护套 (Jacket)
13. 密封垫 (Gasket)
14. 接线盒盖 (Terminal box lid)
15. 螺丝 (Screw)
16. 弹簧垫圈 (Spring washer)
17. 风叶 (Fan)
18. 风罩螺丝 (Fan cowl screw)
19. B5 法兰 (B5 flange)
20. 吊环 (Eyebolt)

21. 接线盒座 (Terminal box base)
22. 轴承 (Bearing)
23. 波形垫圈 (Wave form)
24. 后端盖 (Rear endshield)
25. 螺栓 (Bolt)
26. 弹簧垫圈 (Spring washer)
27. 风罩 (Fan cowl)

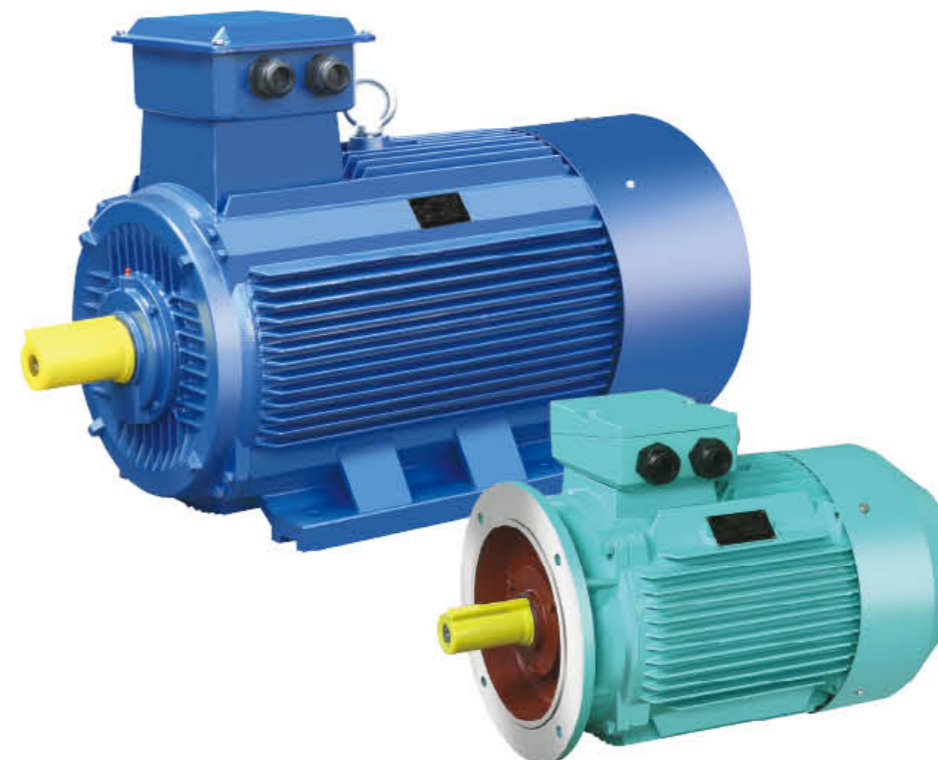

产品概述

YE2 系列三相异步电动机符合 GB 18613-2012《中小型三相异步电动机能效限定值及能效等级》中规定的三级效率标准。同时，符合国家最新发布的 STANDARD JB/T11707-2013 行业标准与 IE2 的 IEC60034-30-2008 能效等级标准。其提高高效率设计，符合国家对生产制造行业提出节能降耗的要求。

YE2 系列电机的安装尺寸符合 IEC60034 标准。具有结构合理，外形美观、效率高、噪音低，防护等级、绝缘等级高等优点，可广泛应用于风机、水泵、机床、压缩机运输机械等驱动各种通用机械设备，也可在石油、化工、钢铁、矿山等其它环境比较恶劣的场所使用。

PRODUCT OVERVIEW

The three-phase asynchronous motor of the IE2 series is in line with the third efficiency standard in the provisions of GB 18613-2012 "the energy efficiency limit and the energy efficiency rating of small and medium-sized three-phase asynchronous motors". And the improvement of the efficiency in its design is in line with the state's requirements on the energy saving and consumption reducing of the manufacturing sector.

YE2 series motors with the mounting dimension in accordance with standard IEC60034, It has good features like optimum structure, attractive appearance, low noise, high efficiency, high protection class as well as high insulation class. IE2 series motors can be widely used in various kinds of general use machineries like fans, pumps, machin tools, compressors, transportation and so on, and can also be used in the hazardous areas with oil and chemical, steel plants, mining industry.

使用条件

环境温度: $-15^{\circ}\text{C} \leq 0 \leq 40^{\circ}\text{C}$
 海拔: 不超过 1000m
 额定电压: 380V, 可选 220-760V 之间任何电压值
 额定频率: 50Hz、60Hz
 防护等级: IP55
 绝缘等级: F 级、H 级
 冷却方式: IC411
 工作方式: S1
 连接方式: 3kw 及以下 Y 接法、4kw 及以上为 Δ 接法

OPERATING CONDITIONS

Ambient temperature: $-15^{\circ}\text{C} \leq 0 \leq 40^{\circ}\text{C}$
 Altitude: not exceeding 1000m
 Rated voltage: 380V or any voltage between 220-760V
 Rated frequency: 50Hz、60Hz
 Protection class: IP55
 Insulation class: F、H
 Cooling method: IC411
 Duty: S1(continuous)
 Connection: Star-connection for up to 3kw, delta-connection for 4kw and above.



技术参数 / TECHNICAL DATE

电机型号 Type No.	额定功率 Rated output		额定电流			额定转速 Rated speed (r/min)	额定电流			额定转速 Rated speed (r/min)	效率 EFF %	功率因素 Power factor cos Φ	额定转矩 Rated torque N.m	堵转转矩 Locked torque TST/TFL	堵转电流 Locked current IST/TFL	最大转矩 Max torque TM/TFL	噪声 Noise level LW dB(A)	重量 Weight (Kg)
	(kW)	HP	Rated current IFL 380V A	Rated current IFL 400V A	Rated current IFL 420V A		Rated current IFL 440V A	Rated current IFL 460V A	Rated current IFL 480V A									
			380-420V/50Hz			440-480V/60Hz												
同步转速 1000r/min																		
YE2-90S-6	0.75	1.0	2.1	2.00	1.90	910	1.81	1.73	1.66	1120	75.9	0.71	7.66	2.0	6.0	2.1	57	21
YE2-90L-6	1.1	1.5	3	2.85	2.71	910	2.59	2.48	2.38	1120	78.1	0.72	11.2	2.0	6.0	2.1	57	24
YE2-100L-6	1.5	2.0	4	3.80	3.62	940	3.45	3.30	3.17	1130	79.8	0.72	15.2	2.0	6.5	2.1	61	33
YE2-112M-6	2.2	3.0	5.7	5.42	5.16	940	4.92	4.71	4.51	1155	81.8	0.72	21.8	2.0	6.6	2.1	65	42
YE2-132S-6	3	4.0	7.6	7.22	6.88	960	6.56	6.28	6.02	1170	83.3	0.72	29.4	1.9	6.8	2.1	69	59
YE2-132M1-6	4	5.5	9.7	9.22	8.78	960	8.38	8.01	7.68	1170	84.6	0.74	39.2	1.9	6.8	2.1	69	72
YE2-132M2-6	5.5	7.5	13	12.4	11.8	960	11.2	10.7	10.3	1170	86.0	0.75	53.9	1.9	7.0	2.1	69	78
YE2-160M-6	7.5	10	16.8	16.0	15.2	970	14.5	13.9	13.3	1170	87.2	0.78	73.5	2.0	7.0	2.1	70	112
YE2-160L-6	11	15	23.9	22.7	21.6	970	20.6	19.7	18.9	1170	88.7	0.79	108	2.0	7.2	2.1	70	134
YE2-180L-6	15	20	31.8	30.2	28.8	970	27.5	26.3	25.2	1175	89.7	0.80	146	1.9	7.3	2.1	73	178
YE2-200L1-6	18.5	25	38.9	37.0	35.2	980	33.6	32.1	30.8	1175	90.4	0.80	180	1.9	7.3	2.1	73	226
YE2-200L2-6	22	30	45.4	43.1	41.1	980	39.2	37.5	35.9	1175	90.9	0.81	214	1.9	7.4	2.1	73	243
YE2-225M-6	30	40	60.6	57.6	54.8	980	52.3	50.1	48.0	1180	91.7	0.82	291	1.9	6.9	2.1	74	295
YE2-250M-6	37	50	73.5	69.8	66.5	980	63.5	60.7	58.2	1180	92.2	0.83	359	1.9	7.1	2.1	76	368
YE2-280S-6	45	60	86.8	82.5	78.5	980	75.0	71.7	68.7	1185	92.7	0.85	434	1.9	7.3	2.0	78	496
YE2-280M-6	55	75	104	98.8	94.1	980	89.8	85.9	82.3	1185	93.1	0.86	531	1.9	7.3	2.0	78	545
YE2-315S-6	75	100	145	137.8	131.2	980	125.2	119.8	114.8	1185	93.7	0.84	723	1.9	6.6	2.0	83	910
YE2-315M-6	90	120	171	162.5	154.7	980	147.7	141.3	135.4	1185	94.0	0.85	868	1.9	6.7	2.0	83	1030
YE2-315L1-6	110	150	209	198.6	189.1	980	180.5	172.7	165.5	1185	94.3	0.85	1061	1.9	6.7	2.0	83	1120
YE2-315L2-6	132	180	247	234.7	223.5	980	213.3	204.0	195.5	1185	94.6	0.86	1273	1.9	6.8	2.0	83	1185
YE2-355M1-6	160	220	298	283.1	269.6	980	257.4	246.2	235.9	1185	94.8	0.86	1543	1.9	6.8	2.0	85	1530
YE2-355M2-6	200	270	372	353.4	336.6	980	321.3	307.3	294.5	1185	95.0	0.86	1929	1.9	6.8	2.0	85	1690
YE2-355L-6	250	340	465	441.8	420.7	980	401.6	384.1	368.1	1185	95.0	0.86	2412	1.9	6.8	2.0	85	1855



技术参数 / TECHNICAL DATE

电机型号 Type No.	额定功率 Rated output	额定转速 Rated speed (r/min)	电流 Current In (A)	效率 EFF %	功率因素 Power factor cos Φ	堵转转矩 Locked torque TST/TFL	堵转电流 Locked current IST/TFL	最大转矩 Max torque TM/TFL
YE2	(kW)	(r/min)	(A)	%	cos Φ	Rated torque TST/TFL	Rated current IST/TFL	Rated torque TM/TFL
同步转速 750r/min								
YE2-80M1-8	0.18	630	0.88	51	0.61	1.8	3.3	1.9
YE2-80M2-8	0.25	640	1.15	54	0.61	1.8	3.3	1.9
YE2-90S-8	0.37	660	1.49	62	0.61	1.8	4.0	1.9
YE2-90L-8	0.55	660	2.17	63	0.61	1.8	4.0	1.9
YE2-100L1-8	0.75	690	2.40	71	0.67	1.8	4.0	2.0
YE2-100L2-8	1.1	690	3.32	73	0.69	1.8	5.0	2.0
YE2-112M-8	1.5	700	4.40	75	0.69	1.8	5.0	2.0
YE2-132S-8	2.2	710	6.04	78	0.71	1.8	6.0	2.0
YE2-132M-8	3.0	710	7.90	79	0.73	1.8	6.0	2.0
YE2-160M1-8	4.0	720	10.3	81	0.73	1.9	6.0	2.0
YE2-160M2-8	5.5	720	13.6	83	0.74	2.0	6.0	2.0
YE2-160L-8	7.5	720	17.8	85.5	0.75	2.0	6.0	2.0
YE2-180L-8	11	730	25.1	87.5	0.76	2.0	6.6	2.0
YE2-200L-8	15	730	34.1	88	0.76	2.0	6.6	2.0
YE2-225S-8	18.5	730	41.1	90	0.76	1.9	6.6	2.0
YE2-225M-8	22	740	47.4	90.5	0.78	1.9	6.6	2.0
YE2-250M-8	30	740	63.4	91	0.79	1.9	6.6	2.0
YE2-280S-8	37	740	77.8	91.5	0.79	1.9	6.6	2.0
YE2-280M-8	45	740	94.1	92	0.79	1.9	6.6	2.0
YE2-315S-8	55	740	111	92.8	0.81	1.8	6.6	2.0
YE2-315M-8	75	740	151	93	0.81	1.8	6.6	2.0
YE2-315L1-8	90	740	178	93.8	0.82	1.8	6.6	2.0
YE2-315L2-8	110	740	217	94	0.82	1.8	6.6	2.0
YE2-355M1-8	132	740	261	94.2	0.82	1.8	6.4	2.0
YE2-355M2-8	160	740	315	94.2	0.82	1.8	6.4	2.0
YE2-355L-8	200	740	387	94.5	0.83	1.8	6.4	2.0
同步转速 600r/min								
YE2-315S-10	45	590	99.6	91.5	0.75	1.5	6.2	2.0
YE2-315M-10	55	590	121	92	0.75	1.5	6.2	2.0
YE2-315L1-10	75	590	162	92.5	0.76	1.5	6.2	2.0
YE2-315L2-10	90	590	191	93	0.77	1.5	6.2	2.0
YE2-355M1-10	110	590	230	93.2	0.78	1.3	6.0	2.0
YE2-355M2-10	132	590	275	93.5	0.78	1.3	6.0	2.0
YE2-355L-10	160	590	333	93.5	0.78	1.3	6.0	2.0

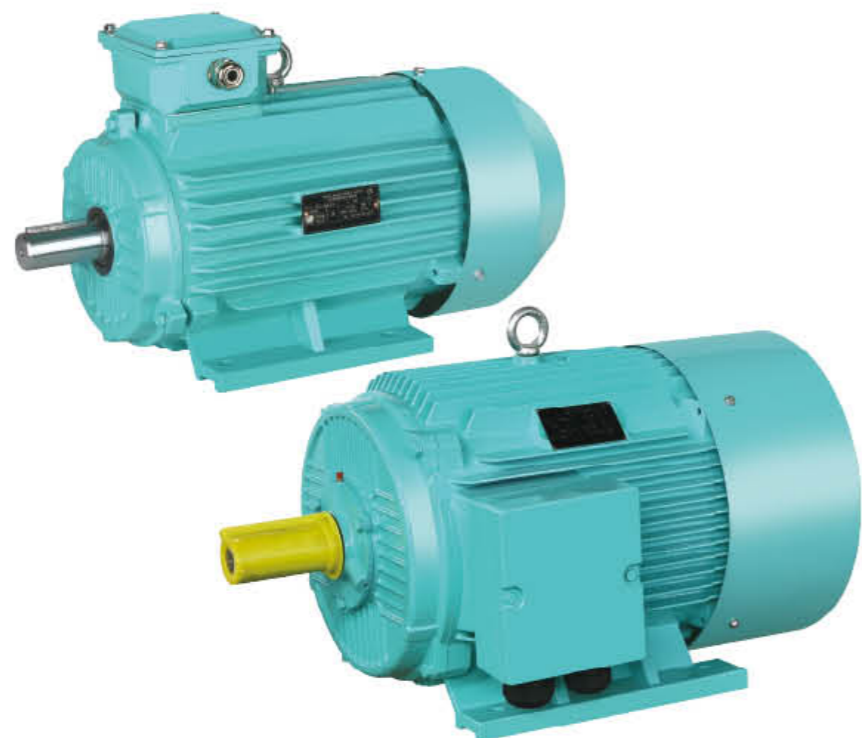

产品概述:

YE3 系列高效率三相异步电动机是我公司根据 JB/T28575-2020《YE3 系列高效率三相异步电动机技术条件 80-355》，TEC60034-30 最新标准的能效等级，按照 IEC60034-2 旋转电机第二部分“旋转电机损耗和效率的试验测定方法”，自主开发设计的。该系列产品效率高、节能环保，新产品集中了我公司多年生产电机的先进技术和生产经验，采用了新技术、新工艺和新材料，使电机的效率指标完全达到 GB18613-2020 中小型三相异步电动机能效限定值（即 2 级能效），产品设计新颖、造型美观、噪声低、效率高、结构紧凑、使用维护方便等特点。电机采用 F 级绝缘，全系列温升按 B 级考核。从而大大提高了安全可靠。电机的安装尺寸符合 IEC 标准规定，外壳防护等级为 IP54(IP55)。

YE3 系列电动机可广泛用于机床、风机、水泵、压缩机、包装机械、矿山机械、建筑机械等各类机械传动设备。

PRODUCT OVERVIEW

YE3 series high efficiency three-phase induction motor are developed according to JB/T28575-2020《high efficiency three-phase induction motor (frame size 80-355)》，the latest efficiency standard of IEC60034-30, and IEC60034-2 Part 2: losses and testing method of rotating motor, and also complies with Grade 3 efficiency of GB18613-2020: energy efficiency rating for medium-small three-phase asynchronous motor. This series motor has such characteristics as new maintenance. Complying with international conventions, standard motors have class F insulation, with a class B temperature rise to offer more reliability and security in operation. IE3 series motor mounting dimension conforms to IEC standard and IP54(IP55) protection class.

YE3 series high efficiency three-phase induction motor can be widely used in transmission industry such as machine tool, pump, ventilator, compressor, transport machinery, construction machinery.

使用条件:

环境温度: -15℃ ≤ 0 ≤ 40℃
海拔: 不超过 1000m
额定电压: 380V, 可选 220-760V 之间任何电压值
额定频率: 50Hz、60Hz
防护等级: IP55
绝缘等级: F 级、H 级
冷却方式: IC411
工作方式: S1
连接方式: 3kw 及以下 Y 接法、4kw 及以上为 Δ 接法

OPERATING CONDITIONS

Ambient temperature: -15℃ ≤ 0 ≤ 40℃
Altitude: not exceeding 1000m
Rated voltage: 380V or any voltage between 220-760V
Rated frequency: 50Hz、60Hz
Protection class: IP55
Insulation class: F、H
Cooling method: IC411
Duty: S1(continuous)
Connection: Star-connection for up to 3kw, delta-connection for 4kw and above.

技术参数 / TECHNICAL DATE

电机型号 Type No.	额定功率 Rated output	电压 Voltage	电流 CURRENT	额定转速 Rated speed	效率 EFF	能效等级 Energy efficiency rating	功率因素 Power factor	堵转转矩 Locked torque Rated torque TST/TFL	堵转电流 Locked current Rated current IST/TFL	最大转矩 Max torque Rated torque TM/TFL	噪声 Noise level LW dB(A)	重量 Weight (Kg)
同步转速3000转/分 (2极) 380V 50Hz Synchronous Speed 3000r/min(2 poles)												
YE3-80M1-2	0.75	380	1.8	2870	80.7	3	0.82	2.2	7.0	2.3	62	16
YE3-80M2-2	1.1	380	2.43	2875	82.7	3	0.83	2.2	7.3	2.3	62	20
YE3-90S-2	1.5	380	3.22	2880	84.2	3	0.84	2.2	7.6	2.3	67	20
YE3-90L-2	2.2	380	4.58	2880	85.9	3	0.85	2.2	7.6	2.3	67	23
YE3-100L-2	3	380	6.02	2880	87.1	3	0.87	2.2	7.8	2.3	74	32
YE3-112M-2	4	380	7.84	2915	88.1	3	0.88	2.2	8.3	2.3	77	37
YE3-132S1-2	5.5	380	10.65	2935	89.2	3	0.88	2.0	8.3	2.3	79	57
YE3-132S2-2	7.5	380	14.37	2930	90.1	3	0.88	2.0	7.9	2.3	79	60
YE3-160M1-2	11	380	20.59	2950	91.2	3	0.89	2.0	8.1	2.3	81	106
YE3-160M2-2	15	380	27.90	2945	91.9	3	0.89	2.0	8.1	2.3	81	140
YE3-160L-2	18.5	380	34.18	2945	92.4	3	0.89	2.0	8.2	2.3	81	131
YE3-180M-2	22	380	40.25	2950	92.7	3	0.89	2.0	8.2	2.3	83	168
YE3-200L1-2	30	380	55.67	2965	93.3	3	0.89	2.0	7.6	2.3	84	219
YE3-200L2-2	37	380	67.41	2965	93.7	3	0.89	2.0	7.6	2.3	84	236
YE3-225M-2	45	380	80.82	2965	94.0	3	0.90	2.0	7.7	2.3	86	288
YE3-250M-2	55	380	98.46	2975	94.3	3	0.90	2.0	7.1	2.3	89	382
YE3-280S-2	75	380	133.70	2975	94.7	3	0.90	1.8	7.1	2.3	91	494
YE3-280M-2	90	380	159.94	2975	95.0	3	0.90	1.8	7.1	2.3	91	550
YE3-315S-2	110	380	195.07	2985	95.2	3	0.90	1.8	7.1	2.3	92	890
YE3-315M-2	132	380	233.59	2985	95.4	3	0.90	1.8	7.1	2.3	92	995
YE3-315L1-2	160	380	279.44	2985	95.6	3	0.91	1.8	7.2	2.3	92	1040
YE3-315L2-2	200	380	348.57	2985	95.8	3	0.91	1.8	7.2	2.2	92	1145
YE3-355M1-2	250	380	435.71	2985	95.8	3	0.91	1.6	7.2	2.2	100	1714
YE3-355M2-2	250	380	435.71	2985	95.8	3	0.91	1.6	7.2	2.2	100	1714
YE3-355L-2	315	380	549.00	2985	95.8	3	0.91	1.6	7.2	2.2	100	1870



技术参数 / TECHNICAL DATE

电机型号 Type No.	额定功率 Rated output	电压 Voltage	电流 CURRENT	额定转速 Rated speed	效率 EFF	能效等级 Energy efficiency rating	功率因素 Power factor	堵转转矩 Locked torque Rated torque TST/TFL	堵转电流 Locked current Rated current IST/TFL	最大转矩 Max torque Rated torque TM/TFL	噪声 Noise level LW dB(A)	重量 Weight (Kg)
YE3	(kW)	V	T(A)	(r/min)	%	(级)	cos Φ					
同步转速1500转/分 (4极) 380V 50Hz Synchronous Speed 1500r/min(4 poles)												
YE3-80M2-4	0.75	380	1.80	1430	82.5	3	0.75	2.3	6.6	2.3	56	17
YE3-90S-4	1.1	380	2.70	1430	84.1	3	0.76	2.3	6.8	2.3	59	19
YE3-90L-4	1.5	380	3.47	1430	85.3	3	0.77	2.3	7.0	2.3	59	23
YE3-100L1-4	2.2	380	4.76	1440	86.7	3	0.81	2.3	7.6	2.3	64	33
YE3-100L2-4	3	380	6.34	1455	87.7	3	0.82	2.2	7.6	2.3	64	35
YE3-112M-4	4	380	8.37	1465	88.6	3	0.82	2.0	7.8	2.3	65	41
YE3-132S-4	5.5	380	14.37	1465	89.6	3	0.83	2.0	7.9	2.3	71	60
YE3-132M-4	7.5	380	11.24	1470	90.4	3	0.84	2.0	7.5	2.3	71	72
YE3-160M-4	11	380	15.01	1470	91.4	3	0.85	2.0	7.7	2.3	73	110
YE3-160L-4	15	380	22.00	1470	92.1	3	0.86	2.0	7.8	2.3	73	130
YE3-180M-4	18.5	380	28.77	1470	92.6	3	0.86	2.0	7.8	2.3	76	167
YE3-180L-4	22	380	35.30	1475	93.0	3	0.86	2.0	7.8	2.3	76	182
YE3-200L-4	30	380	41.53	1480	93.6	3	0.86	2.0	7.3	2.3	76	232
YE3-225S-4	37	380	57.42	1480	93.9	3	0.86	2.0	7.4	2.3	78	280
YE3-225M-4	45	380	69.62	1485	94.2	3	0.86	2.0	7.4	2.3	78	309
YE3-250M-4	55	380	102.72	1490	94.6	3	0.86	2.0	7.4	2.3	79	382
YE3-280S-4	75	380	136.00	1490	95.0	3	0.88	2.0	6.7	2.3	80	480
YE3-280M-4	90	380	163.23	1490	95.2	3	0.88	2.0	6.9	2.3	80	480
YE3-315S-4	110	380	197.00	1490	95.4	3	0.89	2.0	7.0	2.2	88	960
YE3-315M-4	132	380	235.72	1490	95.6	3	0.89	2.0	7.0	2.2	88	1046
YE3-315L1-4	160	380	285.12	1490	95.8	3	0.89	2.0	7.1	2.2	88	1115
YE3-315L2-4	200	380	351.71	1490	96.0	3	0.90	2.0	7.1	2.2	88	1200
YE3-355M1-4	250	380	439.64	1495	96.0	3	0.90	2.0	7.1	2.2	95	1697
YE3-355M2-4	250	380	439.64	1495	96.0	3	0.90	2.0	7.1	2.2	95	1697
YE3-355L-4	315	380	553.94	1495	96.0	3	0.90	2.0	7.1	2.2	95	2000



技术参数 / TECHNICAL DATE

电机型号 Type No.	额定功率 Rated output	电压 Voltage	电流 CURRENT	额定转速 Rated speed	效率 EFF	能效等级 Energy efficiency rating	功率因素 Power factor	堵转转矩 Locked torque Rated torque TST/TFL	堵转电流 Locked current Rated current IST/TFL	最大转矩 Max torque Rated torque TM/TFL	噪声 Noise level LW dB(A)	重量 Weight (Kg)
YE3	(kW)	V	T(A)	(r/min)	%	(级)	cos Φ					
同步转速1000转/分 (6极) 380V 50Hz Synchronous Speed 1000r/min(6poles)												
YE3-90S-6	0.75	380	2.03	945	78.9	3	0.71	2.0	6.0	2.1	57	20
YE3-90L-6	1.1	380	2.83	950	81.0	3	0.73	2.0	6.0	2.1	57	20
YE3-100L-6	1.5	380	3.78	950	82.5	3	0.73	2.0	6.5	2.1	61	31
YE3-112M-6	2.2	380	5.36	965	84.3	3	0.74	2.0	6.6	2.1	65	37
YE3-132S-6	3	380	7.20	975	85.6	3	0.74	1.9	6.8	2.1	69	54
YE3-132M1-6	4	380	9.46	975	86.8	3	0.74	1.9	6.8	2.1	69	64
YE3-132M2-6	5.5	380	11.44	975	88.0	3	0.75	1.9	7.0	2.1	69	73
YE3-160M-6	7.5	380	16.19	980	89.1	3	0.79	2.0	7.0	2.1	70	104
YE3-160L-6	11	380	23.14	980	90.3	3	0.80	2.0	7.2	2.1	70	126
YE3-180L-6	15	380	30.85	980	91.2	3	0.81	1.9	7.3	2.1	73	169
YE3-200L1-6	18.5	380	37.84	985	91.7	3	0.81	1.9	7.3	2.1	73	211
YE3-200L2-6	22	380	44.42	985	92.2	3	0.81	1.9	7.4	2.1	73	225
YE3-225M-6	30	380	59.89	985	92.9	3	0.83	1.9	6.9	2.1	74	281
YE3-250M-6	37	380	71.73	985	93.3	3	0.84	1.9	7.1	2.1	76	378
YE3-280S-6	45	380	85.85	990	93.7	3	0.85	1.9	7.3	2.0	78	475
YE3-280M-6	55	380	103.26	990	94.1	3	0.86	1.9	7.3	2.0	78	541
YE3-315S-6	75	380	143.40	990	94.6	3	0.84	1.9	6.6	2.0	83	870
YE3-315M-6	90	380	169.52	990	94.9	3	0.85	1.9	6.7	2.0	83	965
YE3-315L1-6	110	380	206.11	990	95.1	3	0.85	1.9	6.7	2.0	83	1052
YE3-315L2-6	132	380	244.45	990	95.4	3	0.86	1.9	6.8	2.0	83	1130
YE3-355M1-6	160	380	296.00	995	95.6	3	0.86	1.9	6.8	2.0	85	1650
YE3-355M2-6	200	380	364.60	995	95.8	3	0.87	1.9	6.8	2.0	85	1700
YE3-355L-6	250	380	455.75	995	95.8	3	0.87	1.9	6.8	2.0	85	1890

技术参数 / TECHNICAL DATE

电机型号 Type No.	额定功率 Rated output	电压 Voltage	电流 CURRENT	额定转速 Rated speed	效率 EFF	能效等级 Energy efficiency rating	功率因素 Power factor	堵转转矩 Locked torque Rated torque TST/TFL	堵转电流 Locked current Rated current IST/TFL	最大转矩 Max torque Rated torque TM/TFL	噪声 Noise level LW dB(A)	重量 Weight
YE3	(kW)	V	T(A)	(r/min)	%	(级)	cos Φ					(Kg)
同步转速750转/分 (8极) 380V 50Hz Synchronous Speed 750r/min(8poles)												
YE3-100L1-8	0.75	380	2.26	690	75.0	3	0.67	1.8	4.0	2.0	57	32
YE3-100L2-8	1.1	380	3.11	690	77.7	3	0.69	1.8	5.0	2.0	57	33
YE3-112M-8	1.5	380	4.08	700	79.7	3	0.70	1.8	5.0	2.0	61	37
YE3-132S-8	2.2	380	5.74	710	81.9	3	0.71	1.8	6.0	2.0	65	54
YE3-132M-8	3	380	7.47	710	83.5	3	0.73	1.8	6.0	2.0	69	54
YE3-160M1-8	4	380	9.81	720	84.8	3	0.73	1.9	6.0	2.0	69	104
YE3-160M2-8	5.5	380	13.10	720	86.2	3	0.74	2.0	6.0	2.0	69	104
YE3-160L-8	7.5	380	17.40	720	87.3	3	0.75	2.0	6.0	2.0	70	126
YE3-180L-8	11	380	25.15	730	88.6	3	0.75	2.0	6.6	2.0	70	219
YE3-200L1-8	15	380	33.47	730	89.6	3	0.76	2.0	6.6	2.0	73	225
YE3-200L2-8	15	380	33.47	730	89.6	3	0.76	2.0	6.6	2.0	73	225
YE3-225S-8	18.5	380	41.05	730	90.1	3	0.76	1.9	6.6	2.0	73	280
YE3-225M-8	22	380	47.30	740	90.6	3	0.78	1.9	6.6	2.0	74	280
YE3-250M-8	30	380	63.20	740	91.3	3	0.79	1.9	6.6	2.0	76	378
YE3-280S-8	37	380	77.51	740	91.8	3	0.79	1.9	6.6	2.0	78	475
YE3-280M-8	45	380	93.87	740	92.2	3	0.79	1.9	6.6	2.0	78	541
YE3-315S-8	55	380	111.53	740	92.5	3	0.81	1.8	6.6	2.0	83	995
YE3-315M-8	75	380	151.28	740	93.1	3	0.81	1.8	6.6	2.0	83	1046
YE3-315L1-8	90	380	178.55	740	93.4	3	0.82	1.8	6.6	2.0	83	1052
YE3-315L2-8	110	380	217.52	740	93.7	3	0.82	1.8	6.6	2.0	83	1130
YE3-355M1-8	132	380	260.20	740	94.0	3	0.82	1.8	6.4	2.0	85	1714
YE3-355M2-8	160	380	314.39	740	94.3	3	0.82	1.8	6.4	2.0	85	1870
YE3-355L-8	200	380	387.02	740	94.6	3	0.83	1.8	6.4	2.0	85	1890



铜转子电机优点

1. 使电机体积小化；
2. 提高电动机效率（节能、省电）；
3. 降低电动机温升，延长电动机的工作寿命；
4. 铜转子电机可靠性高；

Advantages of copper rotor motor

1. make the motor smaller in size;
2. improve motor efficiency (energy saving, power saving);
3. reduce the temperature rise of the motor and prolong the working life of the motor;
4. copper rotor motor high reliability;

铜转子电动机介绍

Introduction to Copper Rotor Motors

感应电动机主要由端盖、风机、定子、转子和轴承等组成。目前广泛用于工业、电器等各个行业的电动机主要是铝转子电动机，在特殊环境少量使用永磁电动机等，直到 20 世纪五六十年代才将铜用在电动机的转子上加工成铜转子，从而出现了铜转子电动机。

只是国内生产的铸铜转子及剖开的铜转子电动机。近年来，美国、德国、法国、等十多个国家陆续开始了铸铜转子的研发，铜转子电动机能受到各国的青睐因为其特有的优势。

Induction motors are mainly composed of end caps, fans, stators, rotors and bearings. At present, widely used in industrial, electrical and other industries of the motor is mainly aluminum rotor motor, a small amount of special environment in the use of permanent magnet motors, etc., until the world in the fifties and sixties will be used in the motor rotor copper rotor There was a copper rotor motor.

Only the domestic production of copper rotor and cut open copper rotor motor. In recent years, the United States, Germany, France, and so on more than 10 countries have started the development of copper rotor, copper rotor motor can be favored by the country because of its unique advantages.

铜转子三大应用领域

Copper rotor three applications

1. 工业超高效电动机

IE3 超高效率电动机开发

IE3(IE4+) 超超高效率电动机

2. 工业电机小型化

铜转子应用优势：体积小，重量轻，成本低，可以降低基座使用（专用配套领域）

减速机用电动机：压缩机的运用已经在此领域实现大批量生产。

3. 铜转子电动机的应用 --- 新能源车用驱动电机

目前已有 GM,Hyundai, Yulon, AC propulsion, Tesla, ABB 等高速异步感应驱动领域的一流公司在应用铜转子电动机，

与国内中低速车（双 100）近 50 家客户合作，并已经批量化。

YE4 系列超高效铜转子
YE4 Series Ultra high efficiency copper rotor



新能源汽车电机铜转子
New energy automobile motor copper rotor

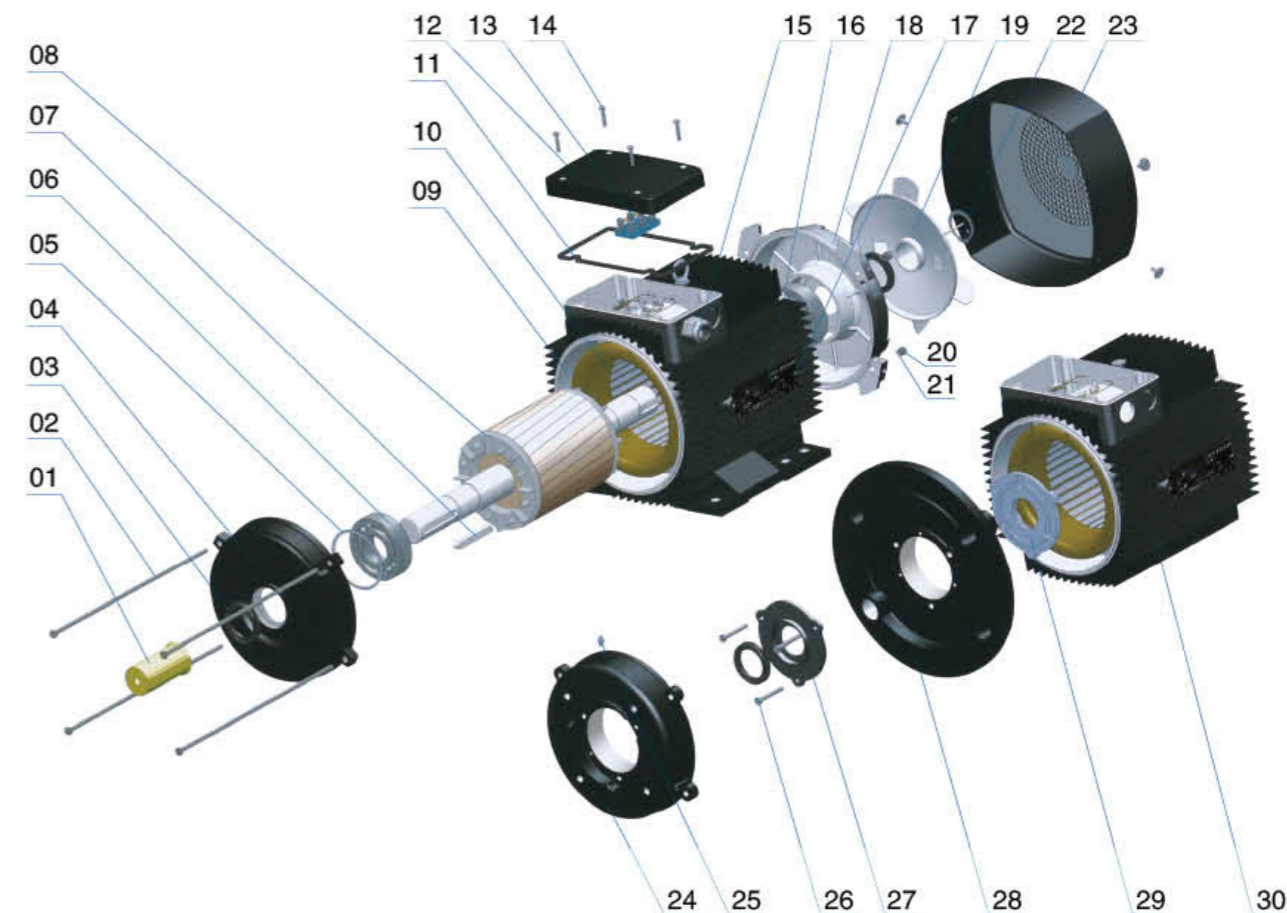

产品分解图

EXPLODED VIEW

- | | | |
|----------------------------|----------------------------------|-----------------------------------|
| 1. 轴套 (Shaft cover) | 11. 接线盒密封圈 (Seal) | 21. 弹簧垫圈 (Washer) |
| 2. 螺栓 (Bolt) | 12. 接线盒盖 (Electrical wiring lid) | 22. 轴用挡圈 (Ring-shield) |
| 3. 油封 (Oil seal) | 13. 接线板 (Wiring board) | 23. 风罩 (Fan cowl) |
| 4. B3 前端盖 (B3 shield) | 14. 螺钉 (Bolt) | 24. B14 前端盖 (B14 flange) |
| 5. 波纹垫圈 (Wave washer) | 15. 螺套 (Barrel) | 25. 油嘴 (Nozzle) |
| 6. 轴承 (Bearing) | 16. 铭牌 (Nameplate) | 26. 螺栓 (Bolt) |
| 7. 轴键 (Shaft key) | 17. 铆钉 (Rivet) | 27. 轴承外盖 (Outer bearing cover) |
| 8. 转子 (Rotor) | 18. 后端盖 (Rear endshield) | 28. B5 前端盖 (B5 flange) |
| 9. B3 机壳 (B3 motor casing) | 19. 风叶 (Fan) | 29. 轴承内盖 (Internal bearing cover) |
| 10. 定子绕组 (Winding) | 20. 螺母 (Nut) | 30. B5 机壳 (B5 motor casing) |



产品概述:

YE3 系列是本公司依据 JB/T11707-2013 最新开发的全封闭自扇风冷式鼠笼型高效率三相异步电动机。该系列电动机的效率指标达到中国 GB18613-2012《中小型三相异步电动机能效限定值及能效等级》中的 3 级能效，符合 IEC60034-30 标准中的 IE3 能效等级。YE3 系列高效率三相异步电动机可用于驱动风机、泵类等长期负载运行，各项性能指标达到国际先进水平，高效从而达到节能减排的目的。YE3 高效率三相异步电动机的安装尺寸、功率等级符合国际电工委员会 IEC60072-1 标准，中心高 H160 及以上电机可配装不停机注排油装置，并预留有安装热敏电阻和防潮加热带的空间，方便用户选用。温升按 80K 考核，电动机温升裕量大，寿命长；转子采用铸铝工艺，运行可靠性高。该系列电动机功率范围：0.75-7.5kw；机座中心高：H80-H132。

PRODUCT OVERVIEW

YE3 series aluminium — housing three phase asynchronous motors are developed from Y2 series three phase asynchronous motors, since aluminium — alloy material has been introduced into its housing, end shield, terminal box and removable feet, IE2 series aluminium — housing motors own a beautiful appearance and a smooth surface. Despite that, dimensions and output power of IE2 series aluminium — housing motors are the same as those of IE2 series or Y2 series three phase asynchronous motors. IE2 series aluminium — housing motors have lots of futures such as high efficiency and energy saving, large starting torque, excellent performance, low noise and vibration, compact structure, high reliability, easy operation and etc. Operating conditions of IE2 series aluminium — housing motors are identical with Y2 series motors, while efficiency class are in line with Chinese National standard GB 18613 — 2012 class III.

使用条件

环境温度：-15℃ < 40℃
海拔：不超过 1000m
额定电压：380V、400V、415V
频率：50Hz、60Hz
接法：额定功率 3kW 及以下电机为 Y 接法
额定功率 4kW 及以上电机为 Δ 接法
工作制：连续工作制 (S1)
防护等级：IP54/IP55
绝缘等级：B 级 / F 级
冷却方式：IC411

OPERATING CONDITIONS

Ambient temperature: -15℃ < 40℃
Altitude: Up to 1000 meters
Rated voltage: 380V、400V、415V
Rated frequency: 50Hz、60Hz
Connection: Output ≤ 3kW, "Y" connection
Output ≤ 4kW, "Δ" connection
Duty: Continuous (S1)
Ingress protection: IP54/IP55
Insulation: Class B / Class F
Cooling method: IC411

技术参数 / TECHNICAL DATE

电机型号 Type No.	额定功率 Rated output		满载时 Full Load						额定转矩 Rated torque (Tn) N.m	堵转转矩 Locked torque TST/TFL	堵转电流 Locked current Rated current IST/ITFL	最大转矩 Max torque Rated torque TM/TFL	噪声 Noise level LW dB(A)	重量 Weight (Kg)
	(kW)	HP	转速 Speed (r/min)	电流 IN(A)			效率 EFF %	功率因素 Power factor cos Φ						
YE3				380V	400V	415V								
同步转速 3000r/min														
YE3-80M1-2	0.75	1	2833	1.8	1.71	1.64	77.4	0.82	2.53	2.3	6.8	2.3	62	15
YE3-80M2-2	1.1	1.5	2833	2.53	2.4	2.32	79.6	0.83	3.71	2.3	7.1	2.3	62	16
YE3-90S-2	1.5	2	2847	3.34	3.17	3.06	81.3	0.84	5.03	2.3	7.3	2.3	67	19
YE3-90L-2	2.2	3	2847	4.73	4.49	4.33	83.2	0.85	7.38	2.3	7.6	2.3	67	23
YE3-100L-2	3	4	2876	6.19	5.88	5.67	84.6	0.87	9.96	2.2	7.8	2.3	74	30
YE3-112M-2	4	5.5	2885	8.05	7.65	7.37	85.8	0.88	13.24	2.2	8.1	2.3	77	39
YE3-132S1-2	5.5	7.5	2904	10.9	10.4	10	87.0	0.88	18.09	2.2	8.2	2.3	79	56
YE3-132S2-2	7.5	10	2904	14.5	13.8	13.3	88.1	0.89	24.66	2.2	7.8	2.3	79	59
YE3-160M1-2	11	15	2933	21	20	19.2	89.4	0.89	35.81	2.2	7.9	2.3	81	100
YE3-160M2-2	15	20	2933	28.4	26.9	26	90.3	0.89	48.84	2.2	7.9	2.3	81	115
YE3-160L-2	18.5	25	2933	34.7	33	31.8	90.9	0.89	60.24	2.2	8.0	2.3	81	135
YE3-180M-2	22	30	2943	41.1	39.1	37.7	91.3	0.89	71.38	2.2	8.1	2.3	83	163
YE3-200L1-2	30	40	2952	55.7	52.9	51	92.2	0.89	97.04	2.0	7.5	2.3	84	219
YE3-200L2-2	37	50	2952	68.3	64.9	62.5	92.5	0.89	119.7	2.0	7.5	2.3	84	242
YE3-225M-2	45	60	2962	82.7	78.6	75.7	92.9	0.89	145.1	2.2	7.5	2.3	86	291
YE3-250M-2	55	75	2967	100.7	95.7	92.2	93.2	0.89	177.0	2.2	7.6	2.3	89	387
YE3-280S-2	75	100	2971	136.5	129.7	125	93.8	0.89	241.1	1.8	6.9	2.3	91	501
YE3-280M-2	90	120	2971	163.3	155.1	149.5	94.1	0.89	289.3	1.8	6.9	2.3	91	528
YE3-315S-2	110	150	2976	196.9	187.1	180.3	94.3	0.90	353.0	1.8	7.0	2.2	92	958
YE3-315M-2	132	180	2976	235.6	223.8	215.7	94.6	0.90	423.5	1.8	7.0	2.2	92	1133
YE3-315L1-2	160	220	2976	281.8	267.7	258	94.8	0.91	513.4	1.8	7.1	2.2	92	1225
YE3-315L2-2	200	270	2976	351.5	333.9	321.9	95.0	0.91	641.7	1.8	7.1	2.2	92	1290
YE3-355M-2	250	340	2981	439.4	417.4	402.3	95.0	0.91	800.8	1.6	7.1	2.2	100	1840
YE3-355L-2	315	430	2981	553.6	525.9	506.9	95.0	0.91	1009.0	1.6	7.2	2.2	100	1930
YE3-4001-2	355	480	2980	614.6	583.8	562.7	95.4	0.92	1137.7	1.3	6.5	2.0	106	2850
YE3-4002-2	400	550	2980	692.8	657.8	634.1	95.4	0.92	1281.9	1.3	6.5	2.0	106	3000
YE3-4003-2	450	600	2980	779	740.1	713.3	95.4	0.92	1442.1	1.3	6.5	2.0	109	3150
YE3-4004-2	500	680	2980	865.6	822.3	792.6	95.4	0.92	1602.3	1.3	6.5	2.0	109	3300
YE3-4005-2	560	760	2980	969.4	921	887.7	95.4	0.92	1794.6	1.3	6.5	2.0	109	3450

技术参数 / TECHNICAL DATE

电机型号 Type No.	额定功率 Rated output		满载时 Full Load					额定转矩 Rated torque (Tn) N.m	堵转转矩 Locked torque TST/TFL	堵转电流 Locked current Rated torque IST/TFL	最大转矩 Max torque Rated torque TM/TFL	噪声 Noise level LW dB(A)	重量 Weight (Kg)	
	(kW)	HP	转速 Speed (r/min)	电流 IN(A)			效率 EFF %							功率因素 Power factor cos Φ
YE3				380V	400V	415V								
同步转速 750r/min														
YE3-80M1-8	0.18	0.25	650	0.88	0.84	0.8	51.0	0.61	2.64	1.8	3.3	1.9	52	15.5
YE3-80M2-8	0.25	0.37	650	1.15	1.1	1.06	54.0	0.61	3.67	1.8	3.3	1.9	56	16.5
YE3-90S-8	0.37	0.5	660	1.49	1.41	1.36	62.0	0.61	5.35	1.8	4.0	1.9	56	20
YE3-90L-8	0.55	0.75	660	2.17	2.07	1.99	63.0	0.61	7.96	1.8	4.0	2.0	56	24
YE3-100L1-8	0.75	1	690	2.4	2.28	2.19	71.0	0.67	10.40	1.8	4.0	2.0	59	30
YE3-100L2-8	1.1	1.5	690	3.32	3.15	3.04	73.0	0.69	15.20	1.8	5.0	2.0	59	32
YE3-112M-8	1.5	2	700	4.4	4.18	4.03	75.0	0.69	20.50	1.8	5.0	2.0	61	40
YE3-132S-8	2.2	3	710	6.04	5.73	5.53	78.0	0.71	29.60	1.8	6.0	2.0	64	52
YE3-132M-8	3	4	710	7.9	7.51	7.24	79.0	0.73	40.40	1.8	6.0	2.0	64	63
YE3-160M1-8	4	5.5	720	10.3	9.76	9.41	81.0	0.73	53.10	1.9	6.0	2.0	68	90
YE3-160M2-8	5.5	7.5	720	13.6	12.9	12.5	83.0	0.74	73.00	2.0	6.0	2.0	68	100
YE3-160L-8	7.5	10	720	17.8	16.9	16.3	85.5	0.75	99.50	2.0	6.0	2.0	68	124
YE3-180L-8	11	15	730	25.1	23.9	23	87.5	0.76	143.9	2.0	6.6	2.0	70	160
YE3-200L-8	15	20	730	34.1	32.4	31.2	88.0	0.76	196.2	2.0	6.6	2.0	73	212
YE3-225S-8	18.5	25	730	41.1	39.0	37.6	90.0	0.76	242.0	1.9	6.6	2.0	73	255
YE3-225M-8	22	30	730	47.4	45.0	43.4	90.5	0.78	287.8	1.9	6.6	2.0	73	285
YE3-250M-8	30	40	735	63.4	60.2	58.1	91.0	0.79	389.8	1.9	6.6	2.0	75	370
YE3-280S-8	37	50	735	77.8	73.9	71.2	91.5	0.79	480.7	1.9	6.6	2.0	76	485
YE3-280M-8	45	60	735	94.1	89.4	86.1	92.0	0.79	584.7	1.9	6.6	2.0	76	540
YE3-315S-8	55	75	735	111.2	105.6	101.8	92.8	0.81	714.6	1.8	6.6	2.0	82	820
YE3-315M-8	75	100	735	151.3	143.7	138.5	93.0	0.81	974.5	1.8	6.6	2.0	82	970
YE3-315L1-8	90	120	740	177.8	168.9	162.8	93.8	0.82	1161.5	1.8	6.6	2.0	82	1050
YE3-315L2-8	110	150	740	216.8	206	198.5	94.0	0.82	1419.6	1.8	6.4	2.0	82	1130
YE3-355M1-8	132	180	740	261	248	239	93.7	0.82	1703.5	1.8	6.4	2.0	90	1720
YE3-355M2-8	160	220	740	314.7	299	288.2	94.2	0.82	2064.9	1.8	6.4	2.0	90	1800
YE3-355L-8	200	270	740	387.4	368.1	354.8	94.5	0.83	2581.1	1.8	6.4	2.0	90	1950
YE3-4001-8	250	340	740	484.3	460.1	443.4	94.5	0.83	3226.4	1.6	6.0	1.8	95	2850
YE3-4002-8	280	380	740	542.4	515.3	496.7	94.5	0.83	3613.5	1.6	6.0	1.8	95	2950
YE3-4003-8	315	430	740	610.2	579.7	558.7	94.5	0.83	4065.2	1.6	6.0	1.8	98	3200
YE3-4004-8	355	480	740	687.7	653.3	629.7	94.5	0.83	4581.4	1.6	6.0	1.8	98	3400
同步转速 600r/min														
YE3-315S-10	45	60	590	99.6	94.7	91.2	91.5	0.75	728.4	1.5	6.2	2.0	82	830
YE3-315M-10	55	75	590	121.1	115.1	110.9	92.0	0.75	89.3	1.5	6.2	2.0	82	940
YE3-315L1-10	75	100	590	162.1	154	148.4	92.5	0.76	1214.0	1.5	6.2	2.0	82	1070
YE3-315L2-10	90	120	590	191	181.4	174.9	93.0	0.77	1456.8	1.5	6.2	2.0	82	1150
YE3-355M1-10	110	150	590	229.9	218.4	210.5	93.2	0.78	1780.5	1.3	6.0	2.0	90	1660
YE3-355M2-10	132	180	590	275	261.3	251.8	93.5	0.78	2136.6	1.3	6.0	2.0	90	1780
YE3-355L-10	160	220	590	333.3	316.7	305.2	93.5	0.78	2589.8	1.3	6.0	2.0	90	1950
YE3-4001-10	200	270	595	415.3	394.6	380.3	93.8	0.78	3210.1	1.2	5.5	1.6	93	2820
YE3-4002-10	250	340	595	519.2	493.2	475.4	93.8	0.78	4012.6	1.2	5.5	1.6	93	2950
YE3-4003-10	280	380	595	581.5	552.4	532.4	93.8	0.78	4494.1	1.2	5.5	1.6	97	3100
YE3-4004-10	315	430	595	654.2	621.4	599	93.8	0.78	5055.9	1.2	5.5	1.6	97	3350



产品概述:

YD 系列变极多速三相电动机是我国统一设计的 Y2 系列电动机的派生系列之一，具有性能优良，外形美观，与国外同类产品有较好的互换性等优点。防护等级为 IP44。

本电机有二速、三速、四速三种类型，其转速可逐级变换。适用于机械、矿山、冶金、纺织、印染、化工、农械等需要分级变速的设备上，也可简化或代替机械传动中的齿轮减速箱。

本系列的外形及安装尺寸与 Y2 系列相同。

PRODUCT OVERVIEW

YD series three-phase multi-speed induction motors are one of the derived series of Y2 series induction motors of our national uniform design, it have following features: excellent performance, attractive appearance and good interchangeability for the same kind of products abroad. The protection class IP44.

The motors are designed in three types: double speed, three speed and four speed. These speed rates can be changed in stages. The motors are widely used on applications in the equipments where the changed rates in stages are needed, such as mechanism, mine, metallurgy, textiles, printing and dyeing, chemical industry, agricultural etc. They can also simplify or take the place of reducing gearbox in the mechanical drive lines.

使用条件:

环境温度: $-15^{\circ}\text{C} < 0 < 40^{\circ}\text{C}$
 海拔: 不超过 1000m
 额定电压: 380V
 额定频率: 50HZ
 绝缘等级: B 级
 防护等级: IP44
 冷却方式: IC411
 连接方式: 3kw 及以下 Y 接法, 4kw 及以上为 Δ 接法
 工作制: S1

OPERATING CONDITIONS

Ambient temperature: $-15^{\circ}\text{C} < 0 < 40^{\circ}\text{C}$
 Altitude: Not exceeding 1000m meters
 Rated voltage: 380V
 Rated frequency: 50HZ
 Insulation class: Class B
 Protection type: IP44
 Cooling type: IC411
 Connection: Y Start-connection for up to 3KW,
 Δ Delta-connection for 4KW and above.
 Duty/Rating: Continuous (S1)



产品概述:

YDT 系列电机转为风机、泵类负载配套用变极多速三相异步电动机，是 Y 系列电机的派生产品。
该系列电机设计新颖，按风机、泵类负载为二次方递减转矩特性：电机功率与转速三次方成正比，转矩与转速的平方成正比关系，根据转速配套要求，合理匹配相应的功率，从而节省大量的能源，堪称风机负载类型的理想动力。广泛运用于冶金、矿山、纺织、印染、化工、轻工、建筑及民用设施等部门。
YDT 系列电机安装尺寸与 Y 系列电机相同，防护等级为 IP44。具有高效、节能、噪音低、绝缘性能好、运行可靠、维修方便等优点。
YDT 系列电机符合国际 IEC 标准，主要技术招标达到国内外同类产品的先进水平。
本公司 YDT 系列电机按 JB/T8681-1998 标准生产。

PRODUCT OVERVIEW

Among series YDT motors, the pole-and speed-changing 3-phase asynchronous motor specially matched for the load of fanblowers or pumps is an outgrowth from series Y motors.
The series motors are novel in design their rotational speed will decrease by deg-rees of quadratic relation with the increase in the load of fanblowers or pumps, their torque properties: the power of motor is directly proportional to the quadrate of rotational speed. Due to it that they can reasonably match the corresponding power according to the complemental requirement of rotational speed, they can save a lot of energy, therefore may be rated as an ideal dynamic force for the fanblowers of load type they are widely used in metallurgy, mining, textile, dyeing, chemical industry, light industry, architecture, civil facilities and other departments virtues of high efficiency, saving energy, low noise, little vibration, fine isolation reliable operation easy maintenance, etc.
Series YDT motors conform to the international standards of IEC, Their main qualifications have reached the advanced standard among the same products both at home and abroad.
This company produces series YDT motors strictly according to the standards of JB/T8681-1998.

使用条件:

Y 异步电动机
D 多速
T 风机、泵类负载
250 机座中心高
M 机座代号 S-短、M-中、L-长
-6/8 极数

OPERATING CONDITIONS

Y Asynchronous motor
D Speed
T Load of fanblowers or pumps
250 Frame size
M Frame no. S-Short, M-Medium, L-Long
-6/8 Poles

使用条件 / SERVICE CONDITION

- 1、环境温度：随季节而变化，但不超过40℃。
 - 2、海拔：不超过1000米。
 - 3、额定频率为50赫兹。
 - 4、额定电压380伏。
 - 5、工作方法：连续（S1）
 - 6、起动方式：满压直接起动。
- 1、 Ambient temperature: to be altered with the change of seasons but do not exceed 40°C
- 2、 Altitude: to be used lower than 1,000 meters above sea level.
- 3、 Rated frequency: 50HZ
- 4、 Rated voltage: 380V
- 5、 Duty: continuous (s1)
- 6、 Method of starting: can be started directly on full voltage for all sizes of motors.

引出线标志 / DESIGNATION FOR LEADING-OUT WIRE

HIGH SPEED 高速	MIDDLE SPEED 中速	LOW SPEED 低速	APPLICABLE TYPE (POLE NUMBERS) 适合类型号(极数)
380V ○W ₂ ○U ₂ ○V ₂ ○U ₁ ○V ₁ ○W ₁		380V ○W ₂ ○U ₂ ○V ₂ ○U ₁ ○V ₁ ○W ₁	6/8 4/6
U ₁ V ₁ W ₁ ○U ₂ ○V ₂ ○W ₂		○U ₂ ○V ₂ ○W ₂ ○U ₁ ○V ₁ ○W ₁	2/4 4/8
U ₁ V ₁ W ₁ ○U ₂ ○V ₂ ○W ₂ ○U ₂ ○V ₂ ○W ₂	○U ₂ ○V ₂ ○W ₂ ○U ₁ ○V ₁ ○W ₁ ○U ₂ ○V ₂ ○W ₂	○U ₂ ○V ₂ ○W ₂ ○U ₁ ○V ₁ ○W ₁ ○U ₂ ○V ₂ ○W ₂	4/6/8

接法及出现端子 / COMPANION FLANGE AND LEADING-OUT TERMINAL

VELOCITY RATIO 速比	SYNCHRONOUS SPEED 同步转速				
	1500/1000	1000/750	3000/1500	1500/750	1500/1000/750
CONNECTION 接法	Y/Y	Y/Y	2Y/Y	2Y/Y	2Y/Y/Y
TERMINAL 出线端子	6	6	6	6	9

技术参数 / TECHNICAL DATE

Type 型号	Output 功率 (KW)	Current 电流 (A)	Speed 转速 (r/min)	Efficiency 效率 (%)	powerFactor 功率因数 (COSe)	Noiselevel DB 噪音 (A)	Locked torque Rated torque TST/TFL	Locked current Rated current IST/ITL
YDT80M ₂ -2/4	0.75/0.17	1.9/0.7	2850/1410	68.0/58.0	0.82/0.60	79	2.0/1.4	7.5/5.5
YDT80M ₁ -2/4	0.95/0.25	2.4/0.9	2850/1410	70.0/64.0	0.81/0.65	79	2.0/1.4	7.5/5.5
YDT90S-2/4	1.40/0.30	3.5/0.9	2810/1430	71.0/70.0	0.82/0.72	79	2.0/1.4	7.5/5.5
YDT90L-2/4	1.90/0.40	4.3/1.1	2810/1430	75.0/72.0	0.86/0.73	83	2.0/1.4	7.5/5.5
YDT100L ₁ -2/4	2.50/0.65	5.3/1.8	2890/1420	82.0/74.0	0.87/0.72	83	2.0/1.4	7.5/5.5
YDT100L ₂ -2/4	3.10/0.80	6.4/2.2	2890/1420	82.0/76.0	0.87/0.72	87	2.0/1.4	7.5/5.5
YDT112M-2/4	4.40/1.10	9.2/2.5	2875/1440	82.0/80.0	0.88/0.74	87	2.0/1.4	7.5/5.5
YDT132S-2/4	5.90/1.40	11.7/3.5	2910/1450	83.0/80.0	0.91/0.74	87	1.9/1.3	7.5/5.5
YDT132M-2/4	8.00/2.00	15.3/4.7	2910/1450	85.0/83.0	0.91/0.77	91	1.9/1.3	7.5/5.5
YDT160M-2/4	12.50/2.80	24.1/6.6	2930/1460	86.0/85.0	0.91/0.75	91	1.9/1.3	7.5/5.5
YDT160L-2/4	16.50/3.80	31.0/8.7	2930/1460	87.0/86.0	0.91/0.76	95	1.9/1.3	7.5/5.5
YDT90S-4/6	1.10/0.32	2.9/1.1	1400/930	70.0/63.0	0.78/0.66	95	1.8/1.6	7.0/6.0
YDT90L-4/6	1.40/0.45	3.5/1.5	1400/930	72.0/68.0	0.81/0.66	75	1.8/1.6	7.0/6.0
YDT100L ₁ -4/6	2.20/0.70	5.3/2.2	1430/945	80.0/73.0	0.79/0.66	75	1.8/1.6	7.0/6.0
YDT100L ₂ -4/6	2.50/0.90	6.0/2.9	1430/945	81.0/74.0	0.78/0.67	78	1.8/1.6	7.0/6.0
YDT112M-4/6	3.20/1.10	7.1/3.1	1440/955	82.0/78.0	0.82/0.68	78	1.8/1.6	7.0/6.0
YDT132S-4/6	4.70/1.50	10.0/4.1	1450/970	84.0/81.0	0.83/0.68	82	1.8/1.6	7.0/6.0
YDT132M-4/6	6.70/2.20	13.8/5.7	1450/970	85.0/83.0	0.85/0.69	82	1.8/1.6	7.0/6.0
YDT160M-4/6	9.50/3.10	19.3/8.0	1455/975	87.0/83.0	0.84/0.69	82	1.8/1.6	7.5/7.0
YDT160L-4/6	12.00/4.00	24.4/10.0	1455/975	88.0/83.0	0.84/0.69	86	1.8/1.6	7.5/7.0
YDT180M-4/6	15.50/5.10	29.0/11.5	1460/980	87.0/81.0	0.84/0.72	86	1.5/1.5	7.5/7.0
YDT180L-4/6	18.50/6.20	34.3/13.9	1460/980	87.0/81.0	0.85/0.74	90	1.5/1.5	7.5/7.0
YDT200L-4/6	26.00/8.70	48.2/19.1	1465/980	88.0/83.0	0.85/0.77	90	1.5/1.5	7.5/7.0
YDT225S-4/6	33.00/11.00	60.7/24.2	1470/980	89.0/84.0	0.86/0.84	92	1.5/1.5	7.5/7.0
YDT225M-4/6	39.00/13.00	71.3/27.3	1470/980	90.0/85.0	0.86/0.85	92	1.5/1.5	7.5/7.0
YDT250M-4/6	47.00/16.00	84.2/32.3	1475/985	90.0/85.0	0.89/0.87	92	1.5/1.5	7.5/7.0
YDT280S-4/6	55.00/18.50	99.6/37.3	1480/985	90.0/85.0	0.88/0.86	94	1.5/1.5	7.5/7.0
YDT280M ₁ -4/6	70.00/25.00	125.0/48.4	1480/985	91.0/87.0	0.88/0.87	94	1.5/1.5	7.5/7.0
YDT280M ₂ -4/6	84.00/28.00	150.6/54.8	1480/985	91.0/87.0	0.88/0.87	98	1.5/1.5	7.5/7.0
YDT315S-4/6	95.00/32.00	177.4/65.3	1485/985	91.0/89.0	0.86/0.79	98	1.5/1.5	7.5/7.0
YDT315M-4/6	115.00/38.00	217.5/77.9	1485/985	92.0/90.0	0.86/0.78	98	1.5/1.5	7.5/7.0
YDT315L-4/6	135.00/45.00	260.0/90.5	1485/985	92.0/90.0	0.86/0.80	100	1.5/1.5	7.5/7.0
YDT315L ₂ -4/6	160.00/55.00	294.0/113.4	1485/985	93.0/91.0	0.86/0.80	100	1.5/1.5	7.5/7.0
YDT90S-4/8	1.00/0.22	2.5/1.0	1400/670	70.0/55.0	0.82/0.62	100	1.9/1.5	7.0/5.0
YDT90L-4/8	1.30/0.30	3.1/1.2	1400/670	72.0/58.0	0.82/0.63	75	1.9/1.5	7.0/5.0
YDT100L ₁ -4/8	2.00/0.55	4.7/2.1	1420/690	80.0/65.0	0.80/0.61	75	1.9/1.5	7.0/5.0
YDT100L ₂ -4/8	2.40/0.65	5.5/2.4	1420/690	80.0/66.0	0.81/0.61	78	1.9/1.5	7.0/5.0
YDT112M-4/8	3.20/0.90	7.4/3.3	1440/700	83.0/71.0	0.78/0.59	78	1.9/1.5	7.0/5.0
YDT132S-4/8	4.50/1.10	9.7/3.7	1450/715	84.0/75.0	0.82/0.59	82	2.0/1.2	7.0/5.0
YDT132M-4/8	6.30/1.50	13.2/4.9	1450/715	85.0/78.0	0.83/0.59	82	2.0/1.2	7.0/5.0
YDT160M-4/8	8.90/2.00	18.2/5.4	1440/720	85.0/82.0	0.85/0.67	82	2.0/1.2	7.0/5.0
YDT160L-4/8	12.00/2.70	23.5/6.9	1440/720	86.0/84.0	0.86/0.67	86	2.0/1.2	7.0/5.0

技术参数 / TECHNICAL DATE

Type 型号	Output 功率 (KW)	Current 电流 (A)	Speed 转速 (r/min)	Efficiency 效率 (%)	powerFactor 功率因数 (COSφ)	Noiselevel DB 噪音 (A)	Locked torque Rated torque TST/TFL	Locked current Rated torque IST/TFL
YDT180M-4/8	16.00/4.00	31.8/10.9	1470/725	88.0/84.0	0.85/0.65	90	2.0/1.2	7.0/5.0
YDT180L-4/8	19.50/5.00	38.6/13.4	1470/725	89.0/85.0	0.85/0.66		2.0/1.2	7.0/5.0
YDT200L-4/8	29.00/7.50	56.8/19.6	1475/730	90.0/87.0	0.85/0.66	92	2.0/1.2	7.0/5.0
YDT225M-4/8	40.00/9.50	74.6/25.5	1475/735	91.0/88.0	0.88/0.64	94	2.0/1.3	7.5/5.0
YDT250M-4/8	52.00/14.50	97.3/37.0	1480/735	91.0/88.0	0.87/0.66		2.0/1.3	7.5/5.0
YDT280S-4/8	65.00/17.00	122.8/41.8	1485/735	91.0/89.0	0.87/0.68	98	2.0/1.3	7.5/5.0
YDT280M-4/8	75.00/18.50	137.4/43.9	1485/740	91.0/90.0	0.88/0.70		2.0/1.3	7.5/5.0
YDT315S-4/8	92.00/25.00	174.8/58.7	1485/740	91.0/90.0	0.86/0.70		2.0/1.3	7.5/5.0
YDT315M-4/8	110.00/30.00	208.3/70.1	1485/740	92.0/91.0	0.86/0.70	100	2.0/1.3	7.5/5.0
YDT315L-4/8	135.00/36.00	253.3/84.0	1485/740	92.0/91.0	0.87/0.70		2.0/1.3	7.5/5.0
YDT315L-4/8	155.00/41.00	288.0/94.7	1485/740	92.0/91.0	0.87/0.71		2.0/1.3	7.5/5.0
YDT90S-6/8	0.65/0.25	2.3/1.3	930/700	85.0/52.0	0.63/0.85		1.8/1.6	7.0/6.0
YDT90L-6/8	0.80/0.35	2.9/1.6	930/700	67.0/56.0	0.62/0.58	73	1.8/1.6	7.0/6.0
YDT100L-6/8	1.30/0.55	4.1/2.3	950/700	71.0/62.0	0.66/0.58		1.8/1.6	7.0/6.0
YDT100L-6/8	1.60/0.75	3.2/2.9	950/700	74.0/66.0	0.67/0.59	75	1.8/1.6	7.0/6.0
YDT112M-6/8	2.20/0.90	6.0/3.4	950/705	74.0/67.0	0.68/0.69		1.8/1.6	7.0/6.0
YDT132S-6/8	2.60/1.20	6.9/4.1	960/720	79.0/73.0	0.71/0.60	79	1.8/1.6	7.0/6.0
YDT132M-6/8	3.30/1.60	8.0/5.3	960/720	80.0/76.0	0.76/0.60		1.8/1.6	7.0/6.0
YDT132M-6/8	4.50/2.20	11.0/7.1	960/720	82.0/77.0	0.75/0.60		1.8/1.6	7.0/6.0
YDT160M-6/8	6.50/3.20	14.9/9.5	970/725	84.0/80.0	0.76/0.61	83	1.8/1.6	7.0/6.0
YDT160L-6/8	9.00/4.50	20.3/13.0	970/725	86.0/82.0	0.77/0.62	86	1.8/1.6	7.0/6.0
YDT180L-6/8	13.00/6.50	26.0/15.1	970/725	86.0/81.0	0.77/0.65		1.5/1.5	7.0/6.0
YDT200L-6/8	17.00/8.50	35.5/20.6	970/730	87.0/82.0	0.80/0.66	88	1.5/1.5	7.0/6.0
YDT200L-6/8	22.00/11.00	44.3/27.8	970/730	88.0/83.0	0.80/0.68		1.5/1.5	7.0/6.0
YDT225M-6/8	30.00/15.00	62.3/32.2	980/730	89.0/87.0	0.83/0.78	92	1.5/1.5	7.0/6.0
YDT250M-6/8	37.00/18.00	72.1/38.5	980/735	90.0/87.0	0.86/0.80		1.5/1.5	7.0/6.0
YDT280S-6/8	45.00/22.00	86.8/46.2	985/735	90.0/88.0	0.86/0.81	96	1.5/1.5	7.0/6.0
YDT280M-6/8	55.00/28.00	104.7/57.2	985/735	91.0/89.0	0.82/0.81		1.5/1.5	7.0/6.0
YDT280M-6/8	65.00/32.00	122.0/66.6	985/735	91.0/89.0	0.82/0.81		1.5/1.5	7.0/6.0
YDT315S-6/8	75.00/37.00	145.1/40.4	985/735	91.0/90.0	0.84/0.78	100	1.5/1.5	7.0/6.0
YDT315M-6/8	90.00/45.00	171.6/90.4	985/735	92.0/91.0	0.85/0.82		1.5/1.5	7.0/6.0
YDT315L-6/8	110.00/55.00	209.5/115.7	985/735	92.0/91.0	0.85/0.78		1.5/1.5	7.0/6.0
YDT315L-6/8	132.00/66.00	252.0/137.4	985/735	92.0/91.0	0.85/0.78		1.5/1.5	7.0/6.0
YDT112M-4/6/8	2.30/0.80/0.60	5.9/3.2/2.7	1455/960/7.5	79.0/65.0/61.0	0.73/0.57/0.53		2.0/1.7/1.3	7.5/6.5/4.0
YDT132S-4/6/8	3.10/1.10/0.80	7.1/3.9/3.1	1460/970/720	81.0/71.0/68.0	0.79/0.60/0.57	82	2.0/1.7/1.3	7.5/6.5/4.0
YDT132M-4/6/8	4.50/1.50/1.10	9.8/4.7/3.9	1460/970/720	83.0/74.0/72.0	0.82/0.65/0.57		2.0/1.7/1.3	7.5/6.5/4.0
YDT160M-4/6/8	7.50/2.60/1.50	16.0/7.3/4.8	1460/980/730	84.0/79.0/79.0	0.82/0.67/0.58		1.8/1.6/0.95	7.5/6.5/4.0
YDT160L-4/6/8	10.20/3.50/2.0	20.6/9.5/6.0	1460/980/730	86.0/81.0/81.0	0.85/0.68/0.60	86	1.8/1.6/0.95	7.5/6.5/4.0
YDT180M-4/6/8	13.00/4.50/2.60	24.2/10.6/7.7	1460/980/730	86.0/80.0/80.0	0.90/0.80/0.63		1.8/1.6/0.95	8.0/7.5/5.5
YDT180L-4/6/8	16.00/6.00/3.30	29.6/13.6/9.7	1460/980/730	87.0/81.0/81.0	0.90/0.81/0.63	90	1.8/1.6/0.95	8.0/7.5/5.5
YDT200L-4/6/8	22.00/8.00/4.50	40.6/17.8/13.2	1460/980/730	87.1/82.0/82.0	0.90/0.82/0.62		1.8/1.6/0.95	8.0/7.5/5.5
YDT225S-4/6/8	28.00/10.00/5.50	53.3/21.1/13.4	1470/980/740	89.0/83.0/85.0	0.88/0.85/0.70		1.8/1.7/1.1	8.0/7.5/5.5
YDT225M-4/6/8	34.00/12.00/7.50	63.1/24.7/17.2	1470/980/740	89.0/83.0/87.0	0.89/0.86/0.74	92	1.8/1.7/1.1	8.0/7.5/5.5
YDT250M-4/6/8	44.00/15.50/10.00	78.1/32.1/22.6	1475/985/740	90.0/85.0/88.0	0.92/0.85/0.75		1.8/1.7/1.1	8.0/7.5/5.5
YDT280S-4/6/8	55.00/18.00/12.00	98.5/37.0/27.3	1480/990/740	90.0/85.0/88.0	0.92/0.85/0.74		1.8/1.7/1.1	8.0/7.5/5.5
YDT280M-4/6/8	66.00/21.00/15.00	116.9/42.5/32.8	1480/990/740	91.0/86.0/89.0	0.92/0.86/0.76	94	1.8/1.7/1.1	8.0/7.5/5.5
YDT315S-4/6/8	75.00/27.00/19.00	136.0/55.3/43.8	1480/990/740	90.0/87.0/89.0	0.91/0.84/0.73		1.8/1.4/1.3	8.0/7.5/5.5
YDT315M4/6/8	90.00/32.00/22.00	162.0/64.8/50.6	1480/990/740	91.0/88.0/90.0	0.91/0.84/0.72		1.8/1.4/1.3	8.0/7.5/5.5
YDT315L-4/6/8	115.00/40.00/28.00	204.2/79.7/62.5	1480/990/740	91.0/88.0/90.0	0.91/0.85/0.74	100	1.8/1.4/1.3	8.0/7.5/5.5
YDT315L-4/6/8	140.00/51.00/35.00	253.6/101.8/80.2	1480/990/740	92.0/89.0/91.0	0.90/0.84/0.72		1.8/1.4/1.3	8.0/7.5/5.5



产品概述:

Y-H 系列为全封闭，自扇冷式，船用三相笼式异步电动机，适用于船舶上作驱动各种机械，如泵类、通风机、分离器、液压机械及其它设备之用。Y-H 系列是按照国际电工委员会标志 IEC60034-1 《旋转电机定额和性能》和现行的《钢质海船入级与建造规范》设计的。

PRODUCT OVERVIEW

Y-H series are fully enclosed, fan-cooled, marine three-phase cage asynchronous motors, suitable for driving various machinery on ships, such as pumps, ventilators, separators, hydraulic machinery and other equipment. Y-H series is designed in accordance with the International Electrotechnical Commission mark IEC60034-1 "Rating and Performance of Rotating Electric Machines" and the current "Code for Classification and Construction of Sea-going Steel Ships".

使用条件:

- 冷却介质温度: 不超过 45℃
- 海拔: 0m
- 空气相对湿度: ≤ 95%
- 凝露: 有
- 盐雾: 有
- 油雾: 有
- 霉菌: 有
- 冲击: 有
- 振动: 有
- 倾斜: ± 15°
- 摇摆: ± 22.5°

OPERATING CONDITIONS

- Cooling medium temperature: not more than 45℃
- Altitude: 0m
- Relative air humidity: ≤ 95%
- Condensation: Yes
- Salt spray: Yes
- Oil mist: Yes
- Mold: Yes
- Impact: Yes
- Vibration: Yes
- Tilt: ± 15°
- Swing: ± 22.5°



技术参数 / TECHNICAL DATE

Technical specification table for Y-H marine three-phase cage asynchronous motor series at 3000r/min and 1500r/min synchronous speeds. Columns include: 电机型号 (Type No.), 额定功率 (Rated output), 转速 (Speed), 额定电流 (IN(A)), 效率 (EFF %), 功率因素 (Power factor cosΦ), 堵转转矩 (Locked torque), 最大转矩 (Max torque), 最小转矩 (Minimum torque), 转动惯量 (kgm²), 重量 (Kg).



技术参数 / TECHNICAL DATE

Technical specification table for Y-H marine three-phase cage asynchronous motor series at 1000r/min and 750r/min synchronous speeds. Columns include: 电机型号 (Type No.), 额定功率 (Rated output), 转速 (Speed), 额定电流 (IN(A)), 效率 (EFF %), 功率因素 (Power factor cosΦ), 堵转转矩 (Locked torque), 最大转矩 (Max torque), 最小转矩 (Minimum torque), 转动惯量 (kgm²), 重量 (Kg).

YBX3(63-112) IM B14A 安装及外形尺寸

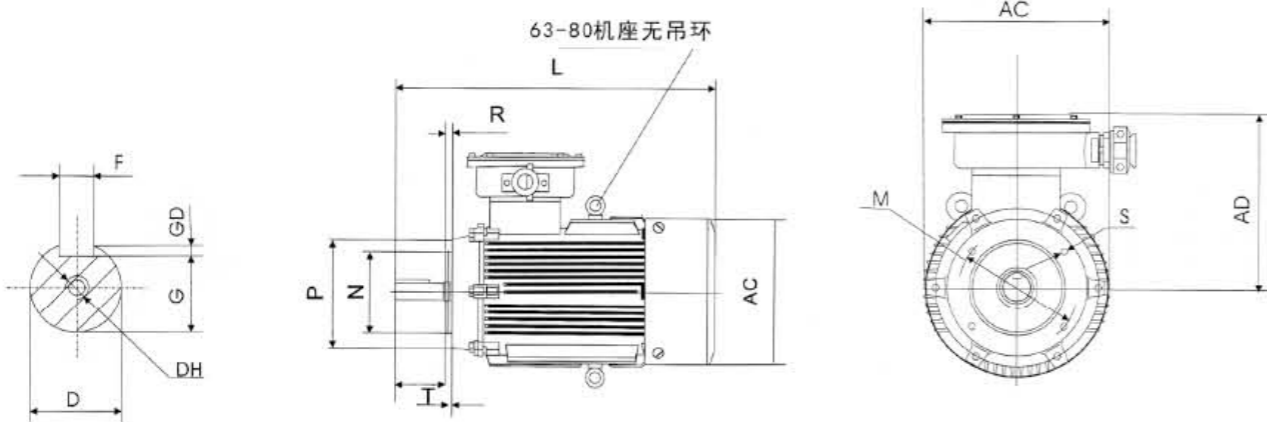

机座号 Frame size	级数 Poles	安装尺寸 Mounting Dimensions(mm)												凸缘孔数	外形尺寸 Overall Dimensions(mm)			
		D	E	F	G	GD	M	N	P	R	S	T	AC		AD	L	DH	
63M	2.4	11	23	4	8.5	2.5	75	60	90	0	M5	2.5	4	150	170	241	M4X10	
71M	2.4.6	14	30	5	11	3	85	70	105	0	M6	2.5	4	155	170	272	M5X12	
80M	2.4.6.8	19	40	6	15.5	3.5	100	80	120	0	M6	3	4	165	240	320	M6X16	
90S	2.4.6.8	24	50	8	20	4	115	95	140	0	M8	3	4	180	260	370	M8X19	
90L	2.4.6.8	24	50	8	20	4	115	95	140	0	M8	3	4	180	260	395	M8X19	
100L	2.4.6.8	28	60	8	24	4	130	110	160	0	M8	3.5	4	205	300	448	M10X22	
112M	2.4.6.8	28	60	8	24	4	130	110	160	0	M8	3.5	4	230	310	500	M10X22	

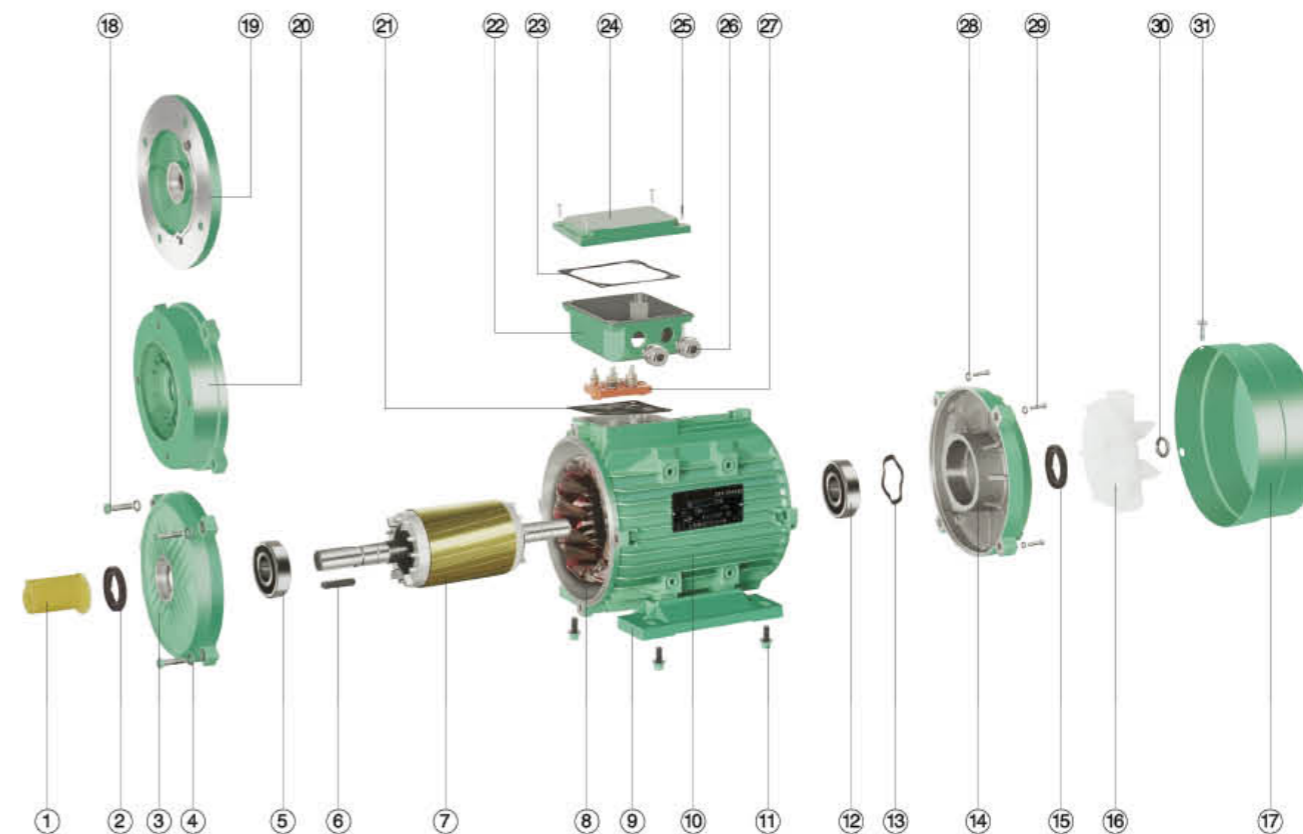

产品分解图
EXPLODED VIEW

- | | | |
|--------------------------|--------------------------|--|
| 1. 轴套 (Shaft cover) | 11. 铝底脚螺栓 (Redstal bolt) | 21. 皮垫 (Leather washer) |
| 2. 密封圈 (vring) oil seal | 12. 轴承 (Bearing) | 22. 接线盒座 (Terminal box base) |
| 3. 前端盖 (Front endshield) | 13. 波形垫圈 (Wave form) | 23. 密封垫 (Gasket) |
| 4. 弹簧垫圈 (Spring washer) | 14. 后端盖 (Rear endshield) | 24. 接线盒盖 (Terminal box lid) |
| 5. 轴承 (Bearing) | 15. 密封圈 (vring) oil seal | 25. 螺丝 (Screw) |
| 6. 键 (Key) | 16. 风叶 (Fan) | 26. 不锈钢护套螺母 (Stainless steel jacket nut) |
| 7. 转子 (Rotor) | 17. 风罩 (Fan cowl) | 27. 接线板 (Terminal board) |
| 8. 定子 (Stator) | 18. 螺栓 (Bolt) | 28. 弹簧垫圈 (Spring washer) |
| 9. 铝底脚 (Pedstal) | 19. B5 法兰 (B5 flange) | 29. 螺栓 (Bolt) |
| 10. 机座 (Frame) | 20. B14 法兰 (B14 flange) | 30. 风叶卡簧 (Fan clamp) |
| | | 31. 风罩螺丝 (Fan cowl screw) |



产品概述:

MS 系列铝壳三相异步电动机符合国家电工协会 IEC 有关规定, 选用优质原材料进行最新式整体设计, 具有性能好、噪声低、振动小、运行安全可靠、外形美观、体积小、重量轻、结构简单、维修方便等优点。

PRODUCT OVERVIEW

MS series aluminum housing three-phase asynchronous motors, with latest design in entirety, are made of selected quality materials and conform to IEC standard.

MS motor have good performance, safety and reliable operation, nice appearance, and can be maintained very conveniently, while with low noise, little vibration and at the same time light weight and simple construction. These motors can be used for general drive.

使用条件:

环境温度: $-15^{\circ}\text{C} \leq 0 \leq 40^{\circ}\text{C}$
海拔: 不超过 1000m
额定电压: 380V
额定频率: 50Hz、60Hz
防护等级: IP54、IP55
绝缘等级: B、F
冷却方式: ICO141
工作方式: 连续 S1

OPERATING CONDITIONS

Ambient temperature: $-15^{\circ}\text{C} \leq 0 \leq 40^{\circ}\text{C}$
Altitude: not exceeding 1000m
Rated voltage: 380V
Rated frequency: 50Hz、60Hz
Protection class: IP54、IP55
Insulation class: Class B/F
Cooling method: ICO141 Duty:S1(continuous)

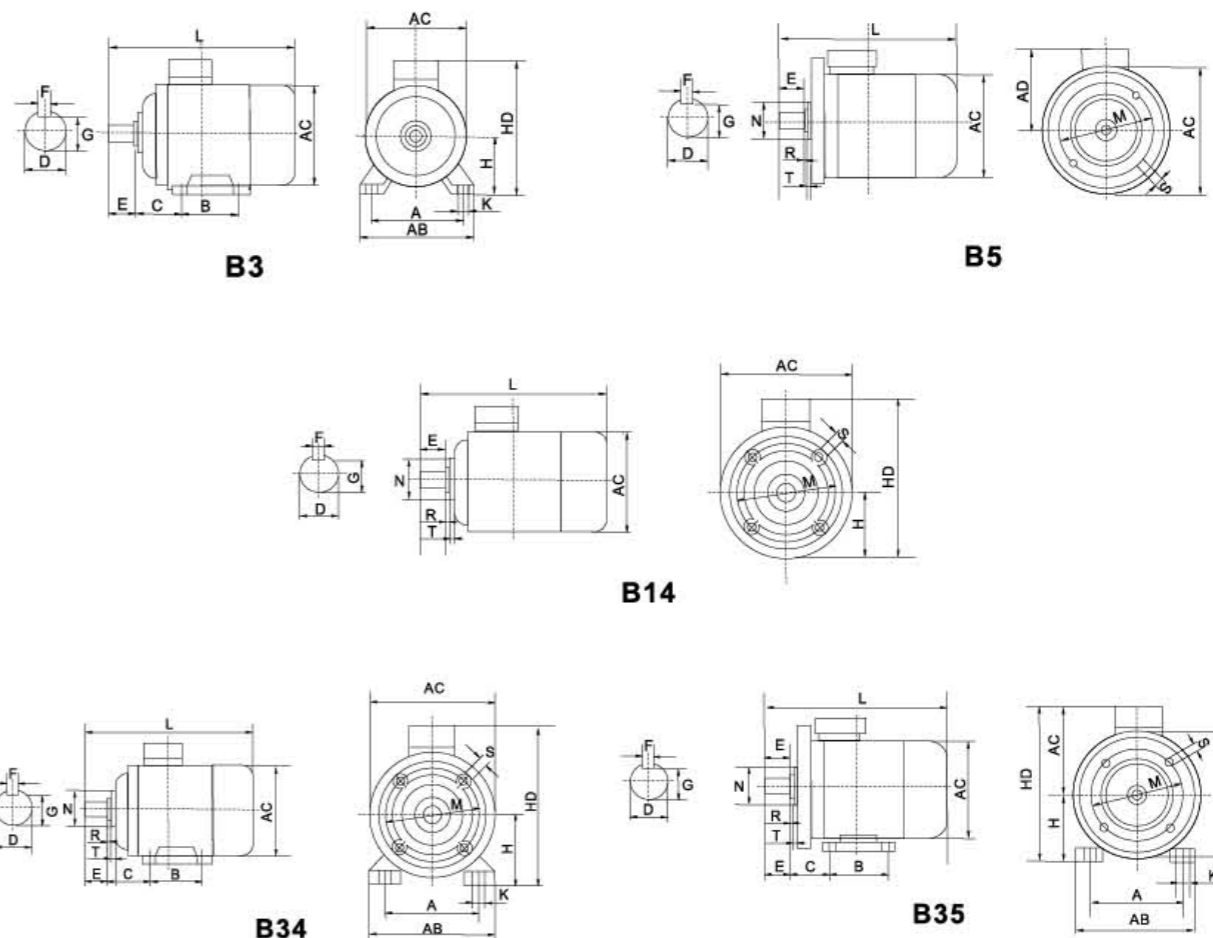

安装尺寸 / OVERALL & INSTALLTION DIEMNSIONS

机座号	安装尺寸 Installation Size												安装尺寸 IMB14 Installation Size IMB14				安装尺寸 IMB5 Installation Size IMB5				整体尺寸 Overall Dimension					
	A	B	C	D	E	F	G	H	K	M	N	P	R	S	T	M	N	P	R	S	T	AB	AC	AD	HD	L
56	90	71	36	9	20	3	7.2	56	6	65	50	80	0	M5	2	100	80	120	0	8.5	3	112	108	93	149	192
63	100	80	40	11	23	4	8.5	63	7	75	60	90	0	M5	2.5	115	95	140	0	10	3	120	120	97	160	211
71	112	90	45	14	30	5	11	71	7	85	70	105	0	M6	2.5	130	110	160	0	10	3.5	135	140	104	175	240
80	125	100	50	19	40	6	15.5	80	10	100	80	120	0	M6	3	165	130	200	0	12	3.5	155	160	113	193	284
90S	140	100	56	24	50	8	20	90	10	115	95	140	0	M8	3	165	130	200	0	12	3.5	175	175	123	213	316
90L	140	125	56	24	50	8	20	90	10	115	95	140	0	M8	3	165	130	200	0	12	3.5	175	175	123	213	341
100L	160	140	63	28	60	8	24	100	12	130	110	160	0	M8	3.5	215	180	250	0	15	4	200	195	157	257	377
112M	190	140	70	28	60	8	24	112	12	130	110	160	0	M8	3.5	215	180	250	0	15	4	226	220	163	275	392
132S	216	140	89	38	80	10	33	132	12	165	130	200	0	M10	3.5	265	230	300	0	15	4	265	265	183	315	463
132M	216	178	89	38	80	10	33	132	12	165	130	200	0	M10	3.5	265	230	300	0	15	4	265	265	183	315	501
160M	254	210	108	42	110	12	37	160	15	215	180	250	0	M12	4	300	250	350	0	19	5	310	320	223	383	606
160L	254	254	108	42	110	12	37	160	15	215	180	250	0	M12	4	300	250	350	0	19	5	310	320	223	383	650



产品分解图

EXPLODED VIEW

- | | | |
|--------------------------|---------------------------|--|
| 1. 密封圈 (vring) oil seal | 11. 轴承 (Bearing) | 21. 皮垫 (Leather washer) |
| 2. 螺栓 (Bolt) | 12. 螺栓 (Bolt) | 22. 接线板 (Terminal board) |
| 3. 前端盖 (Front endshield) | 13. 后端盖 (Rear endshield) | 23. 接线盒座 (Terminal box base) |
| 4. 轴承 (Bearing) | 14. 螺栓 (Bolt) | 24. 密封垫 (Gasket) |
| 5. 键 (Key) | 15. 刹车片 (Brake pads) | 25. 整流块 (Rectifier block) |
| 6. 转子 (Rotor) | 16. 刹车盘 (Brake disc) | 26. 接线盒盖 (Terminal box lid) |
| 7. 定子 (Stator) | 17. 风叶 (Fan) | 27. 螺丝 (Screw) |
| 8. 铝底脚螺栓 (Redstal bolt) | 18. 风叶卡簧 (Fan clamp) | 28. 不锈钢护套螺母 (Stainless steel jacket nut) |
| 9. 铝底脚 (Pedstal) | 19. 风罩螺丝 (Fan cowl screw) | 29. 波形垫圈 (Wave form) |
| 10. 机座 (Frame) | 20. 弹簧垫圈 (Spring washer) | 30. 弹簧垫圈 (Spring washer) |
| | | 31. 风罩 (Fan cowl) |
| | | 32. 刹车器 (Brake) |

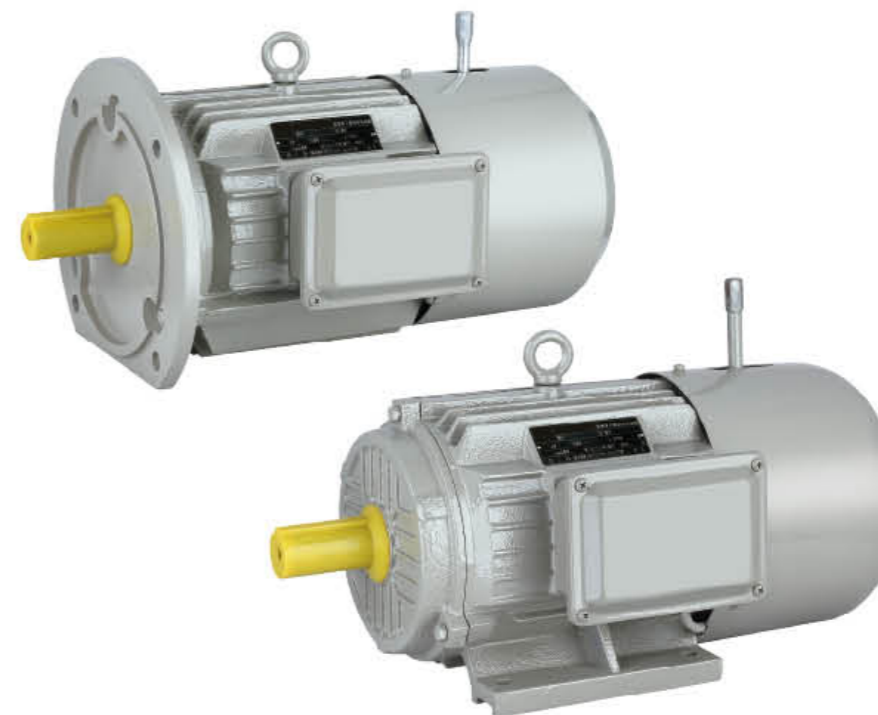

产品概述:

YEJ2 系列电磁制动电动机是 YEJ 系列的改进产品，符合国家标准 JB/T6456-2010 要求，电气性能满足 YE2 系列电机技术标准。该系列制动电动机是在电机非拖动轴端装有电磁制动器，当电机失电时，电磁制动器的制动盘自动与电机后盖压合，产生摩擦制动力矩，使电机停转，空载制动时间随机座号由小到大，为 0.15-0.45S。制动器电源必须拖动电机。电源同步进行。YEJ2 系列电机广泛应用于机械加工机床和输送机、包装、木工、食品、化工、纺织、建筑、商店、卷门等机械作用驱动力。

PRODUCT OVERVIEW

YEJ series electromagnetic brake three-phase asynchronous motors are improved products of YEJ series, it is in accordance with JB/T6456-2010 requirements, and its electrical performance is in accord with YE2 series technical standard. The electric power of the controller should be synchronized with the electric power of the motor. The electric motors are equipped the electromagnetic brake on the non-shaft end, when electricity off, retarding disc will automatically press in end-shield which produce friction brake torque and stop the running of motor, the no-load brake duration is changed with the frame size of the motor, the range is 0.15-0.45 seconds. This kind of motor is considered as the driving force os various machinery and widely used in mechanical workout machine tool, transport machinery, package, woodworking, food, chemical engineering, textile, construction, shop, roll door machinery.

使用条件:

机座中心高: 63-160mm
 控制器电源: 机座中心高 $H \leq 100\text{mm}$, 交流 220V (整流后 99V)
 机座中心高: $H \geq 112\text{mm}$, 交流 380V (整流后 170V)
 功率范围: 0.12-45kW
 额定电压: 380V (其他电压需另订协议)
 额定频率: 50Hz (或 60Hz)
 防护等级: IP54 (或 IP55)
 绝缘等级: B/F 级
 工作制: S1

OPERATING CONDITIONS

Centre height of frame: 63-160mm
 Controller's power: $\leq 100\text{mm}$, AV220V (after commutate 99V)
 Controller's power: $H \geq 112\text{mm}$, AV380V (after commutate 170V)
 Power range: 0.12-45kW
 Rated voltage: 380V (special should order)
 Rated frequency: 50Hz or 60Hz
 Protection class: IP54 or IP55
 Insulation class: B/F
 Duty type: S1

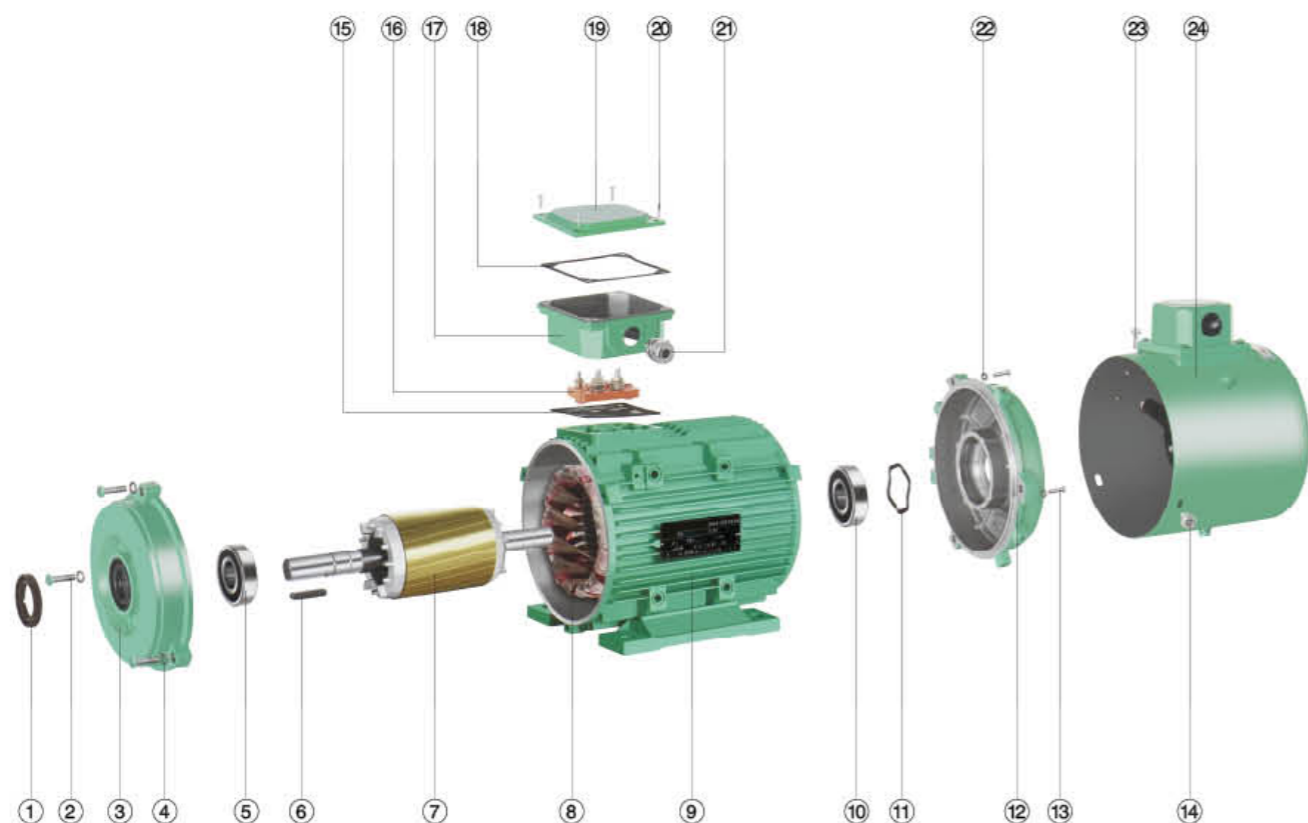

产品分解图

EXPLODED VIEW

- | | | |
|--------------------------|-----------------------------|--|
| 1. 轴套 (Shaft cover) | 11. 波形垫圈 (Wave form) | 21. 不锈钢护套螺母 (Stainless steel jacket nut) |
| 2. 密封圈 (vring) oil seal | 12. 后端盖 (Rear endshield) | 22. 弹簧风罩 (Spring washer) |
| 3. 前端盖 (Front endshield) | 13. 螺栓 (Bolt) | 23. 风罩螺丝 (Fan cowl screw) |
| 4. 弹簧垫圈 (Spring washer) | 14. 风罩螺丝 (Fan cowl screw) | 24. 风罩 (Fan cowl) |
| 5. 轴承 (Bearing) | 15. 皮垫 (Leather washer) | |
| 6. 键 (Key) | 16. 接线板 (Terminal board) | |
| 7. 转子 (Rotor) | 17. 接线盒盖 (Terminal box lid) | |
| 8. 定子 (Stator) | 18. 密封垫 (Gasket) | |
| 9. 机座 (Frame) | 19. 接线盒盖 (Terminal box lid) | |
| 10. 轴承 (Bearing) | 20. 螺丝 (Screw) | |



产品概述:

YVF₂ 系列变频调速三相异步电动机调速范围广。它与变频调速装置配套使用，构成交流变频无极调速系统。在 5-50Hz 范围内作恒转矩变频调速运行，在 50-100Hz 范围内作恒功率变频调速运行，运行平稳，无转矩脉动现象，起动转矩大，起动电流小。电动机的安装形式及安装尺寸均与同容量的 Y 系列三相异步电动机一致。装有独立的冷却风扇装置，电机运行在不同转速下均有较好的冷却效果。

PRODUCT OVERVIEW

YVF₂ series three-phase frequency controlled asynchronous motor possesses a wide range of speed regulation.it can match with a variety of converter to comprise an A.C sleepless adjustable frequency driving system.At low speed(5-50Hz),this motor can run smoothly under constant torque oscillation,and has a larger starting torque and a smaller starting current and delivers constant output power at high speed(50-100Hz). Its mounting arrangements and mounting dimensions are all according to Y series three-phase asynchronous motor.As cooling fan in built in so under different speeds the cooling effects is good.

使用条件:

机座中心高: 80~355mm
功率范围: 0.55~315kW
额定电压: 380V (其他电压需另订协议)
额定频率: 50Hz (或 60Hz)
防护等级: IP54 (或 IP55)
绝缘等级: F 级
工作制: S1

OPERATING CONDITIONS

Centre height of frame: 80~355mm
Power range: 0.55~315kW
Rated voltage: 380V (special should order)
Rated frequency: 50Hz or 60Hz
Protection class: IP54 or IP55
Insulation class: F
Duty type: S1

技术参数 / TECHNICAL DATE

4极 (4 poles)

型号 Model	标准功率 Nominal Capacity kw	标准电流 Nominal Current A	额定转矩 Rated Torque N.m
YVF2 801-4	0.55	1.8	3.5
YVF2 802-4	0.75	2.3	4.7
YVF2 90S-2	1.1	3	7
YVF2 90L-4	1.5	4.1	9.8
YVF2 100L1-4	2.2	5.5	14
YVF2 100L2-4	3	7.5	19
YVF2 112M-4	4	9.6	25
YVF2 132S-4	5.5	12.7	35
YVF2 132M-4	7.5	17	47.5
YVF2 160M-4	11	24.8	70
YVF2 160L-4	15	33	95
YVF2 180M-4	18.5	37.7	117.5
YVF2 180L-4	22	44.5	140
YVF2 200L-4	30	59.6	190
YVF2 225S-4	37	73.2	235
YVF2 225M-4	45	88.4	286
YVF2 250M-4	55	107.5	350
YVF2 280S-4	75	146.6	477
YVF2 280M-4	90	172.5	572.5

4极 (4 poles)

型号 Model	标准功率 Nominal Capacity kw	标准电流 Nominal Current A	额定转矩 Rated Torque N.m
YVF ₂ 315S-4	110	191.4	700.2
YVF ₂ 315M-4	132	227.6	840.3
YVF ₂ 315L1-4	160	274.2	1018.5
YVF ₂ 315L2-4	200	341.6	1273.2
YVF ₂ 355M-4	250	421.2	1591.5
YVF ₂ 355L-4	315	530.7	2005.3
YVF ₂ 4001-4	355	598.1	2259.9
YVF ₂ 4002-4	400	673.9	2546.4
YVF ₂ 4003-4	450	758.1	2864.7
YVF ₂ 4004-4	500	842.3	3183.0
YVF ₂ 4005-4	560	943.4	3565.0

6极 (6 poles)

型号 Model	标准功率 Nominal Capacity kw	标准电流 Nominal Current A	额定转矩 Rated Torque N.m
YVF2 90S-6	0.75	2.5	7
YVF2 90L-6	1.1	3.5	10.5
YVF2 100L-6	1.5	4.4	14
YVF2 112M-6	2.2	6.1	21
YVF2 132S-6	3	7.9	28.5
YVF2 132M1-6	4	10.3	37.5
YVF2 132M2-6	5.5	13.8	52.5
YVF2 160M-6	7.5	18.7	71
YVF2 160L-6	11	27	105
YVF2 180L-6	15	34.6	142.5
YVF2 200L1-6	18.5	39.6	176
YVF2 200L2-6	22	46.8	210
YVF2 225M-6	30	62.5	285.5
YVF2 250M-6	37	75.6	352.5
YVF2 280S-6	45	89.6	429
YVF2 280M-6	55	110	525
-	-	-	-
-	-	-	-

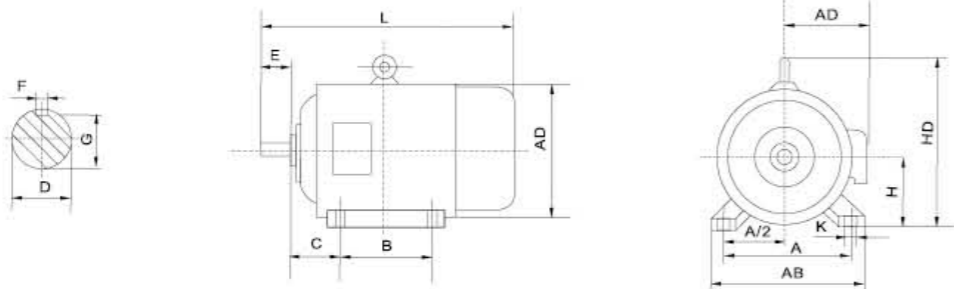

安装尺寸 / OVERALL & INSTALLTION DIEMSIONS

机座号 Frame Number	极数 Poles	安装尺寸 Mounting Dimensions (mm)									外形尺寸 Overall Dimensions (mm)				
		A	B	C	D	E	F	G	H	K	AB	AC	AD	HD	L
YVF2 80	4	125	100	50	50	40	6	15.5	80	10	165	175	150	175	370
YVF2 90S	4	140	100	56	56	50	8	20	90	10	180	195	160	195	385
YVF2 90L	4.6	140	125	56	56	50	8	20	90	10	180	195	160	195	410
YVF2 100L	4.6	160	140	63	63	60	8	24	100	12	205	215	180	245	465
YVF2 112M	4.6	190	140	70	70	60	8	24	112	12	245	240	190	265	470
YVF2 132S	4.6	216	140	89	89	80	10	33	132	12	280	275	210	315	535
YVF2 132M	4.6	216	178	89	89	80	10	33	132	12	280	275	210	315	575
YVF2 160M	4.6	254	210	108	108	110	12	37	160	15	330	355	265	385	665
YVF2 160L	4.6	254	254	108	108	110	12	37	160	15	330	355	265	385	710
YVF2 180M	4.6	279	241	121	121	110	14	42.5	180	15	355	380	285	430	750
YVF2 180L	4.6	279	279	121	121	110	14	42.5	180	15	355	380	285	430	790
YVF2 200L	4.6	318	305	133	133	110	16	49	200	19	395	420	315	475	850
YVF2 225S	4	356	286	149	149	110	18	53	225	19	435	475	345	530	895
YVF2 225M	4.6	356	311	149	149	110	18	53	225	19	435	475	345	530	920
YVF2 250M	4.6	406	349	168	168	140	18	58	250	24	490	515	385	575	1005
YVF2 280S	4.6	457	368	190	190	140	20	67.5	280	24	550	580	410	640	1120
YVF2 280M	4.6	457	419	190	190	140	20	67.5	280	24	550	580	410	640	1170

产品概述:

YCT 系列电磁调速电机是由拖动电机、电磁转差离合器和控制器三部分组成，通常和 JD 型或者 ZJK 型控制器配套使用。可用于恒转矩负载场合，特别适宜在递减转矩负载中使用（例如离心式水泵和风机），广泛应用于各类装配流水线、输送设备、注塑机、印刷机、水泵、风机、回转炉、卷板机、拉线机等工业设备。YCT 系列电磁调速电机可在规定的调速范围内均匀、连续地无极调速，并能输出额定转矩，电机在运行中负载转矩变动时，控制器的速度负反馈系统可自动调节离合器的励磁电流，使输出转速基本保持不变。



PRODUCT OVERVIEW

YCT series adjustable-speed induction motors by electromagnetic clutch are composed of driving motors, electromagnetic slip coupling and controller. YCT series motors are usually used under a constant torque load and are particularly suitable for the use under the load with a decreasing torque such as the centrifugal pump and fan. Main applications of the YCT series motors include assembly lines, transfer equipments, plastic injecting machines, printing machines, pumps, fans, wire calendars, drawing machines etc. The speed of the YCT series motors can be adjusted continuously and steplessly within the specified adjustable speed range with an output of rated torque. When the loading torque is changed during the running of the motor, the exciting current of the coupling can be regulated automatically by the feedback system of the controller rapidly to remain the speed unchanged.

技术参数 / TECHNICAL DATE

型号 Type	额定功率 Rated Output		额定转矩 Rated torque (Tn)	调速范围 Speed range	励磁电压 Excitation Voltage	励磁电流 Excitation Current	噪音 Noise	重量 Weight
	KW	HP	N.m	RPM	V	Amp	dB(A)	KG
YCT-112-4A	0.55	0.75	3.60	1230-125	< 90	< 1.3	75	50
YCT-112-4B	0.75	1	4.90	1230-125	< 90	< 1.3	75	55
YCT-132-4A	1.1	1.5	7.10	1230-125	< 90	< 1.3	75	75
YCT-132-4B	1.5	2	9.70	1230-125	< 90	< 1.3	78	77
YCT-160-4A	2.2	3	14.1	1250-125	< 90	< 1.5	78	114
YCT-160-4B	3	4	19.2	1250-125	< 90	< 1.5	82	117
YCT-180-4A	4	5.5	25.2	1250-125	< 90	< 1.5	82	157
YCT-200-4A	5.5	7.5	35.1	1250-125	< 90	< 2.0	82	224
YCT-200-4B	7.5	10	47.7	1250-125	< 90	< 2.0	86	234
YCT-225-4A	11	15	69.1	1250-125	< 90	< 2.5	86	340
YCT-225-4B	15	20	94.3	1250-125	< 90	< 2.5	90	360
YCT-250-4A	18.5	25	110.0	1320-132	< 90	< 3.0	90	460
YCT-250-4B	22	30	137.0	1320-132	< 90	< 3.0	90	500
YCT-280-4A	30	40	189.0	1320-132	< 90	< 3.5	97	630
YCT-315-4A	37	50	232.0	1320-132	< 90	< 4.5	97	870
YCT-315-4B	45	60	282.0	1320-132	< 90	< 4.5	99	910

YCT 系列电机安装尺寸及外形尺寸
Dimensions of YCT series motor

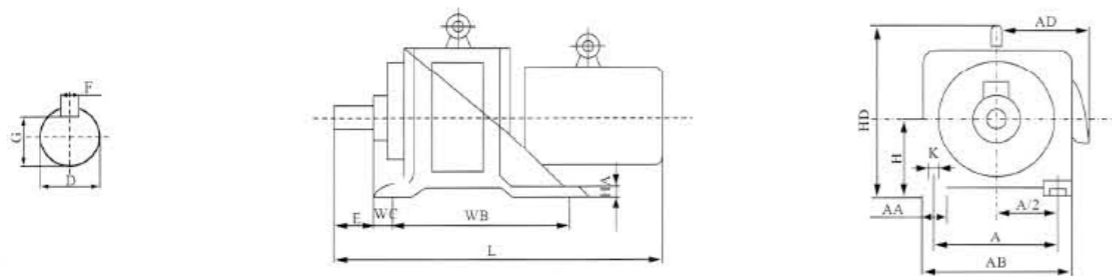

电机型号 Model	安装尺寸 Fixing Measurement										外形尺寸 Figure size				
	A	A/2	WB	WC	D	E	F	G	H	K	AB	AC	AD	HD	L
YCT-112-4A	190	95	210	40	19	40	6	15.5	112	12	240	260	150	280	520
YCT-112-4B	190	95	210	40	19	40	6	15.5	112	12	240	260	150	280	520
YCT-132-4A	216	108	241	40	24	50	8	20	132	12	285	310	165	330	570
YCT-132-4B	216	108	241	40	24	50	8	20	132	12	285	310	165	330	585
YCT-160-4A	254	127	267	45	28	60	8	24	160	14.5	330	350	185	385	665
YCT-160-4B	254	127	267	45	28	60	8	24	160	14.5	330	350	185	385	665
YCT-180-4A	279	139.5	305	45	28	60	8	24	180	14.5	365	385	195	430	700
YCT-200-4A	318	159	356	50	38	80	10	33	200	18.5	410	430	235	485	820
YCT-200-4B	318	159	356	50	38	80	10	33	200	18.5	410	430	235	485	860
YCT-225-4A	356	178	406	56	42	110	12	37	225	18.5	465	485	270	545	980
YCT-225-4B	356	178	406	56	42	110	12	37	225	18.5	465	485	270	545	1025
YCT-250-4A	406	203	457	63	48	110	14	42.5	250	24	520	540	295	595	1130
YCT-250-4B	406	203	457	63	48	110	14	42.5	250	24	520	540	295	595	1170
YCT-280-4A	457	228.5	508	70	55	110	16	49	280	24	575	595	320	665	1280
YCT-315-4A	508	254	560	89	60	140	18	53	315	28	645	670	345	770	1400
YCT-315-4B	508	254	560	89	60	140	18	53	315	28	645	670	345	770	1425
YCT-355-4A	610	305	630	108	65	140	18	58	355	28	755	780	390	890	1550
YCT-355-4B	610	305	630	108	75	140	20	67.5	355	28	755	780	420	890	1630
YCT-355-4C	610	305	630	108	75	140	20	67.5	355	28	755	780	420	890	1680

YCTL 系列电机安装尺寸及外形尺寸
Dimensions of YCTL series motor

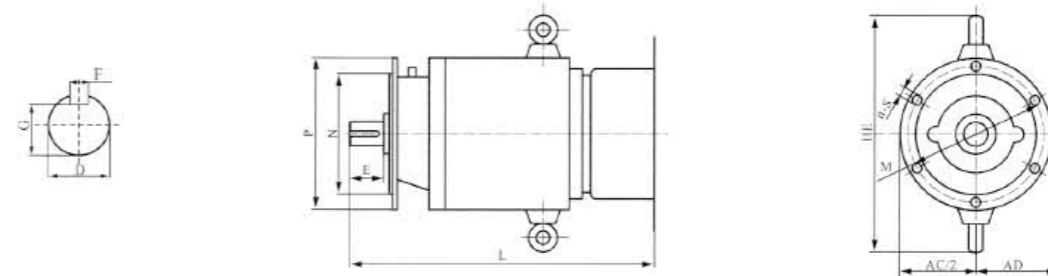

电机型号 Model	安装尺寸 Fixing Measurement											外形尺寸 Figure size			
	D	E	F	G	M	N	P	T	R	S	n	AD	AC/2	HD	L
YCTL-112-4A	19	40	6	15.5	165	130	200	3.5	0	12	4	150	112	320	540
YCTL-112-4B	19	40	6	15.5	165	130	200	3.5	0	12	4	150	112	320	540
YCTL-132-4A	24	50	8	20	165	130	200	3.5	0	12	4	158	132	390	570
YCTL-132-4B	24	50	8	20	165	130	200	3.5	0	12	4	158	132	390	595
YCTL-160-4A	28	60	8	24	215	180	250	4	0	15	4	185	160	425	645
YCTL-160-4B	28	60	8	24	215	180	250	4	0	15	4	185	160	425	665
YCTL-180-4A	28	60	8	24	215	180	250	4	0	15	4	188	180	480	685
YCTL-200-4A	38	80	10	33	265	230	300	5	0	19	8	230	200	530	805
YCTL-200-4B	38	80	10	33	265	230	300	5	0	19	8	230	200	530	845
YCTL-225-4A	42	110	12	37	300	250	350	5	0	19	8	255	225	610	965
YCTL-225-4B	42	110	12	37	300	250	350	5	0	19	8	255	225	610	1010
YCTL-250-4A	48	110	14	42.5	300	250	350	5	0	19	8	285	250	670	1130
YCTL-250-4B	48	110	14	42.5	300	250	350	5	0	19	8	285	250	670	1170
YCTL-280-4A	55	110	16	49	300	500	500	5	0	24	8	320	280	730	1260
YCTL-315-4A	60	140	18	53	450	550	550	5	0	24	8	345	315	815	1400
YCTL-315-4B	60	140	18	53	500	550	550	5	0	24	8	345	315	815	1425
YCTL-355-4A	65	140	18	58	660	800	800	6	0	24	8	385	355	1030	1500
YCTL-355-4B	75	140	20	67.5	740	800	800	6	0	24	8	410	355	1030	1630
YCTL-355-4C	75	140	20	67.5	660	800	800	6	0	24	8	410	355	1030	1660

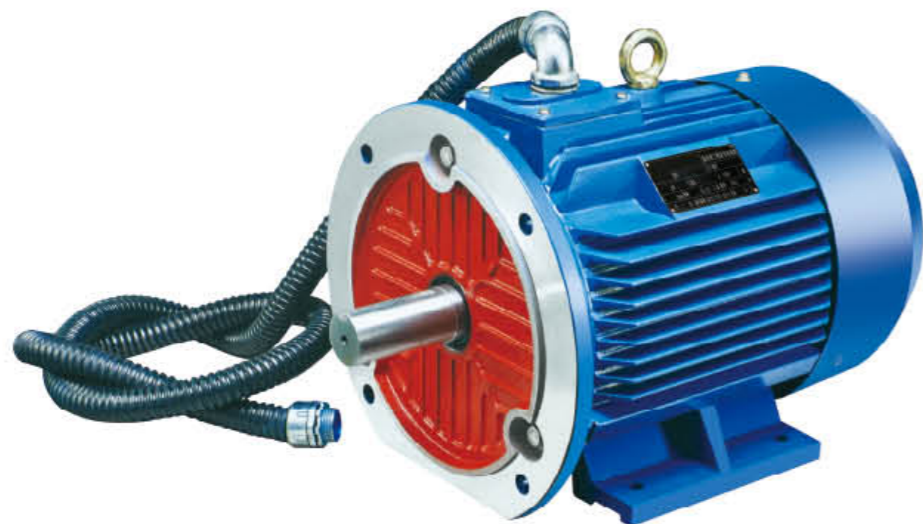

产品概述:

YK2 系列三相异步电动机是专为螺杆压缩机配套而设计制造的，机座为高强度铸铁机座，接线盒位置分机座顶部或侧部两种。机座号为 H132-H315，安装方式分为 IMB3, IMB35，服务系数为 SF=1.15 或 SF=1.2 或 SF=1.25，绝缘等级 F 级，在额定负载时温升按 B 级考核。在系数负载时，温升按 90K 考核，轴承温度应不超过 95℃。

PRODUCT OVERVIEW

YK2 series three phase asynchronous motors are designed for screw compressors, and the housing is made of high strength cast iron. Terminal box position could be on the top or the side. Motor size is ranged from H132 to H315, mounting arrangements are IMB3 and IMB35. Service factor could be 1.15 or 1.2 or 1.25. Temperature rise should be tested according to class B at an rated load, the motor temperature examined by 90K and the bearing temperature should not exceed 95C.

使用条件:

环境温度: -15℃ < 40℃
海拔: 不超过 1000m
额定电压: 380V、400V、415V
额定频率: 50Hz
工作制: 连续工作制 (S1)
防护等级: IP54/IP55
绝缘等级: B 级 / F 级
冷却方式: IC411

OPERATING CONDITIONS

Ambient temperature: -15℃ < 40℃
Altitude: Up to 1000 meters
Rated voltage: 380V、400V、415V
Rated frequency: 50Hz
Duty: Continuous (S1)
Ingress protector: IP54/IP55
Insulation class: Class B / Class F
Cooling method: IC411

YK2 系列电机技术参数:

型号 Type	额定功率 Rated Output		满载时 Full Load						额定转矩 Rated Torque (Tn)	堵转转矩 堵转电流 额定转矩	最大转矩 额定转矩	堵转电流 额定电流	噪声 Noise
			转速 Speed RPM	电流 Input Current (Amp)			效率 Efficiency η %	功率因素 P.F Cos Φ					
YK2	HP	KW	RPM	380V	400V	415V	η %	Cos Φ	N.m	Tst/Tn	Tmax/Tn	Ist/In	dB(A)
YK2-132S1-2	5.5	7.5	2900	10.9	10.4	10	87.0	0.88	18.09	2.2	2.3	8.2	79
YK2-132S2-2	7.5	10	2900	14.5	13.8	13.3	88.1	0.89	24.66	2.2	2.3	7.8	79
YK2-160M1-2	11	15	2930	21	20	19.2	89.4	0.89	35.81	2.2	2.3	7.9	81
YK2-160M2-2	15	20	2930	28.4	26.9	26	90.3	0.89	48.84	2.2	2.3	7.9	81
YK2-160L-2	18.5	25	2930	34.7	33	31.8	90.9	0.89	60.24	2.2	2.3	8.0	81
YK2-180M-2	22	30	2940	41.1	39.1	37.7	91.3	0.89	71.38	2.2	2.3	8.1	83
YK2-200L1-2	30	40	2950	55.7	52.9	51	92.0	0.89	97.04	2.0	2.3	7.5	84
YK2-200L2-2	37	50	2950	68.3	64.9	62.5	92.5	0.89	119.7	2.0	2.3	7.5	84
YK2-255M-2	45	60	2960	82.7	78.6	75.7	92.9	0.89	145.1	2.2	2.3	7.5	86
YK2-250M-2	55	75	2970	100.7	95.7	92.2	93.2	0.89	177.0	2.2	2.3	7.6	89
YK2-280S-2	75	100	2970	136.5	129.7	125	93.8	0.89	241.1	1.8	2.3	6.9	91
YK2-280M-2	90	120	2970	163.3	155.1	149.5	94.1	0.89	289.3	1.8	2.3	6.9	91
YK2-315S-2	110	150	2980	196.9	187.7	180.3	94.3	0.90	353.0	1.8	2.2	7.0	92
YK2-315M-2	132	180	2980	235.6	223.8	215.7	94.6	0.90	423.5	1.8	2.2	7.0	92
YK2-315L1-2	160	220	2980	281.8	267.7	258	94.8	0.91	513.4	1.8	2.2	7.1	92
YK2-315L2-2	200	270	2980	351.5	333.9	321.9	95.0	0.91	641.7	1.8	2.2	7.1	92

YK2 系列电机技术参数:

型号 Type	安装方式 Mounting Arrangement	功率 Rated Output	服务系数 Service Factor	LEF	GCU	防护等级 Ingress Protection	绝缘等级 Insulation Class	出线方式 Lead wire position	引线长度 Lead wire length	护套管长度 Sheath Length	管接头尺寸 Connection Size	接线端子型号 Terminal board model
YK2-132S1-2	B3	5.5	1.15	125	5.7	IP54	155F	左后 (Rear & Left)	0.7	0.4	M33 或 G3/4"	TU1-2.5/5
YK2-132S2-2	B3	7.5	1.15	125	5.7	IP54	155F	左后 (Rear & Left)	0.7	0.4	M33 或 G3/4"	TU1-2.5/5
YK2-132M1-2	B3	11	1.15	170	6.4	IP54	155F	顶右 (Top & Right)	0.75	0.6	M33 或 G1"	TU1-6/6
YK2-132M2-2	B3	15	1.15	220	7.2	IP54	155F	顶右 (Top & Right)	0.75	0.6	M33 或 G1"	TU1-6/6
YK2-160L1-2	B3	18.5	1.15	195	10.5	IP54	155F	顶右 (Top & Right)	1	0.8	M33 或 G1"	TU1-6/6
YK2-160L2-2	B3	22	1.15	230	11.2	IP54	155F	顶右 (Top & Right)	1.4	1.2	M33 或 G1"	TU1-6/6
YK2-160L2-2	B35	22	1.15	230	11.2	IP54	155F	顶右 (Top & Right)	1	0.8	M33 或 G1"	TU1-6/6
YK2-180M-2	B3	30	1.15	250	15.4	IP54	155F	顶右 (Top & Right)	1.1	0.9	M42 或 G1"	PT10
YK2-180L-2	B3	37	1.15	300	17.2	IP54	155F	顶右 (Top & Right)	1.5	1.2	M42 或 G1 1/4"	PT10
YK2-180L-2	B35	37	1.15	300	17.2	IP54	155F	顶右 (Top & Right)	1.1	0.9	M42 或 G1 1/4"	PT10
YK2-200-2	B3	45	1.15	250	21.4	IP54	155F	顶左 (Top & Left)	1.5	1.2	G2" 或 G1 1/2"	PT16
YK2-200-2	B35	45	1.15	250	21.4	IP54	155F	顶右 (Top & Right)	1.1	0.9	G2" 或 G1 1/2"	PT16
YK2-225-2	B3	55	1.25	260	26.1	IP54	155F	顶左 (Top & Left)	1.4	1.1	M48 或 G1 1/2"	PT16
YK2-225-2	B35	55	1.25	260	26.1	IP54	155F	顶右 (Top & Right)	1.4	1.1	M48 或 G1 1/2"	PT16
YK2-250M1-2	B3	75	1.2	310	35.1	IP54	155F	顶右 (Top & Right)	1.5	1.2	G2" 或 M64	PT16
YK2-250-2	B35	75	1.2	310	35.1	IP54	155F	顶右 (Top & Right)	1.2	0.9	G2" 或 M64	PT16
YK2-250M2-2	B3	90	1.2	365	37.7	IP54	155F	顶左 (Top & Left)	1.7	1.4	G2" 或 M64	PT35
YK2-280M1-2	B35	110	1.2	320	44.7	IP54	155F	顶左 (Top & Left)	1.7	1.4	G2" 或 M64	T01-35/10
YK2-280M2-2	B35	132	1.2	400	49.9	IP54	155F	顶左 (Top & Left)	1.7	1.4	G2" 或 M64	T01-50/12
YK2-315S-2	B35	160	1.2	360	96.1	IP54	155F	顶左 (Top & Left)	1.7	1.4	G2 1/2" 或 M64	T01-70/10
YK2-315M-2	B35	185	1.2	430	102	IP54	155F	顶左 (Top & Left)	2.2	1.7	G2 1/2" 或 M64	T01-95/12
YK2-315L-2	B35	250	1.2	540	115.4	IP54	155F	顶左 (Top & Left)	2.2	1.7	G2 1/2" 或 M64	T01-95/12



安装方式 MOUNTING ARRANGEMENT

示意图	基本结构方式
	安装方式
	制造范围 (机座号)

技术参数 / TECHNICAL DATE

额定电压 : 380V 频率 : 50Hz Rated voltage: 380V Frequency: 50Hz

型号 Type	功率 Output		转速 Speed r/min	电流 Current 380V A	效率 Eff. η %	功率 因素 P.F	额定转矩 Rated torque (Tn)	堵转转矩 Locked torque Rated torque TST/TFL	最大转矩 Max torque Rated torque TM/TFL	堵转电流 Locked current Rated torque IST/TFL	噪音 Noise dB(A)	重量 Weight KG
	HP	KW										
Y-315S-10	75	55	590	123.4	91.5	0.74	890.3	1.2	1.8	5.5	93	870
Y-315M1-10	100	75	590	165.2	92.0	0.75	1214.0	1.2	1.8	5.5	93	990
Y-315M2-10	120	90	590	195.6	92.0	0.76	1456.8	1.2	1.8	5.5	93	1050
Y-355M2-10	150	110	590	231.6	92.5	0.78	1780.5	1.0	1.8	5.5	93	1300
Y-355M3-10	180	132	590	273.6	92.8	0.79	2136.6	1.0	1.8	5.5	97	1370
Y-355L1-10	220	160	590	331.6	92.8	0.79	2589.8	1.0	1.8	5.5	97	1470
Y-315L2-10	250	185	590	382.6	93.0	0.79	2994.5	1.0	1.8	5.5	97	1540
Y-355M-12	120	90	490	200.9	92.0	0.74	1754.1	1.0	1.8	5.5	93	1300
Y-355L1-12	150	110	490	241.4	92.3	0.75	2143.9	1.0	1.8	5.5	93	1400
Y-355L2-12	180	132	490	289.1	92.5	0.75	2572.7	1.0	1.8	5.5	97	1470

外形及安装尺寸 Series mounting and overall dimensions

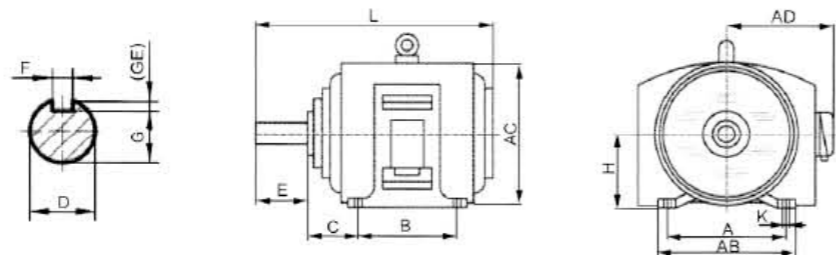

机座号 Frame size	级数 Poles	安装尺寸 Fixing Measurement									外形尺寸 Figure size				
		A	B	C	D	E	F	G	H	K	AB	AC	AD	HD	L
160M	2.4.6.8	254	210	108	48	110	14	42.5	160	14.5	330	380	290	440	676
160L	2.4.6.8	254	254	108	48	110	14	42.5	160	14.5	330	380	290	440	676
180M	2.4.6.8	279	241	121	55	110	16	49	180	14.5	350	420	325	505	726
180L	2.4.6.8	279	279	121	55	110	16	49	180	14.5	350	420	325	505	726
200M	2.4.6.8	318	267	133	60	140	18	53	200	18.5	400	465	350	570	820
200L	2.4.6.8	318	305	133	60	140	18	53	200	18.5	400	465	350	570	886
225M	2	356	311	149	60	140	18	53	225	18.5	450	520	395	640	880
	4.6.8	356	311	149	65	140	18	58	225	18.5	450	520	395	640	880
250M	2	406	311	168	65	140	18	58	250	24	510	550	410	710	930
	4.6.8	406	311	168	75	140	20	67.5	250	24	510	550	410	710	930
250S	2	406	349	168	65	140	18	58	250	24	510	550	410	710	960
	4.6.8	406	349	168	75	140	20	67.5	250	24	510	550	410	710	960
280S	2	457	368	190	80	170	22	71	280	24	570	610	485	785	1090
	4.6.8	457	368	190	80	170	22	71	280	24	570	610	485	785	1090
280M	2	457	419	190	65	140	18	58	280	24	570	610	485	785	1140
	4.6.8	457	419	190	80	170	22	71	280	24	570	610	485	785	1140
315S	2	508	406	216	70	140	20	62.5	315	28	630	792	586	928	1130
	4.6.8.10	508	406	216	90	170	25	81	315	28	630	792	586	928	1160
315M	2	508	457	216	70	140	20	62.5	315	28	630	792	586	928	1240
	4.6.8.10	508	457	216	90	170	25	81	315	28	630	792	586	928	1270
355M	2	610	560	260	75	140	20	67.5	355	28	710	980	630	1120	1550
	4.6.8.10	610	560	260	100	170	28	90	355	28	710	980	630	1120	1620
355L	2	610	630	260	75	210	20	67.5	355	28	710	980	630	1120	1620
	4.6.8.10	610	630	260	100	210	28	90	355	28	710	980	630	1120	1620

IM B3
IM 1001
63-400

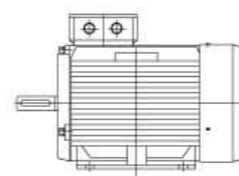

IM B6
IM 1051
63-160

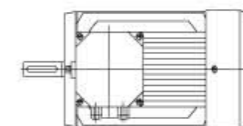

IM B7
IM 1061
63-160

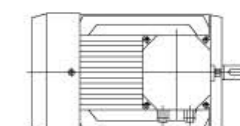

IM B8
IM 1071
63-160

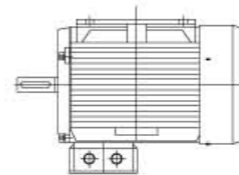

IM V5
IM 1011
63-160

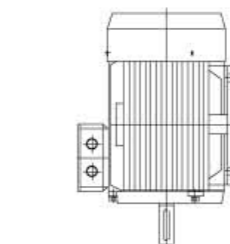

IM V6
IM 1031
63-160

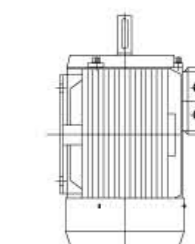

IM B5
IM 3001
63-355

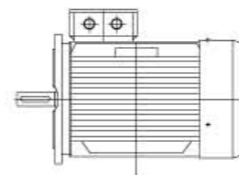

IM V1
IM 3011
63-355

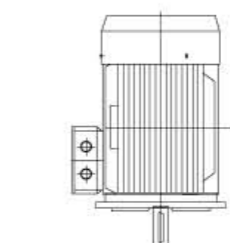

IM V3
IM 3031
63-160

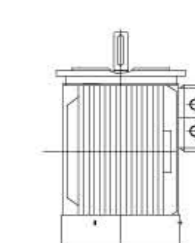

IM B35
IM 2001
63-355

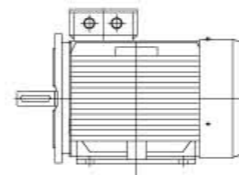

IM V15
IM 2011
63-160

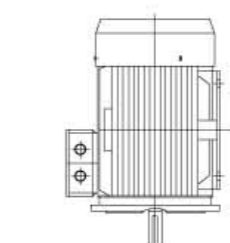

IM V35
IM 2031
63-160

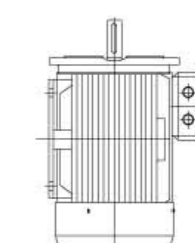

IM B14
IM 3601
63-132

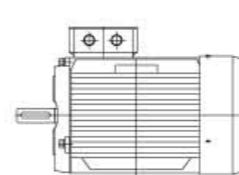

IM V18
IM 3611
63-132

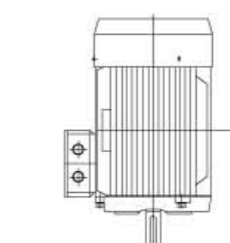

IM V19
IM 3631
63-132

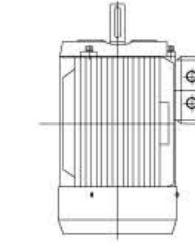

IM B34
IM 2101
63-132

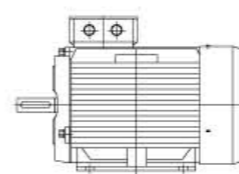

IM V17
IM 2111
63-132

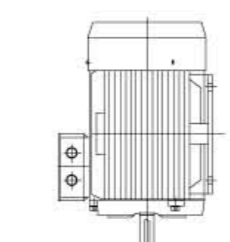

IM V37
IM 2131
63-132

